



FITTING INSTRUCTIONS FOR CP0450 CRASH PROTECTORS
HONDA CB1000R 2018-



PICTURE A



PICTURE B

THIS KIT CONTAINS THE ITEMS PICTURED AND LABELLED BELOW.
DO NOT PROCEED UNTIL YOU ARE SURE ALL PARTS ARE PRESENT.

Please note that the way the kit is packed does not necessarily represent the way of mounting to the bike

THE PARTS SHOWN MAY BE REPRESENTATIVE ONLY (FOR CLARITY OF INSTRUCTIONS ONLY)

LEFT SIDE

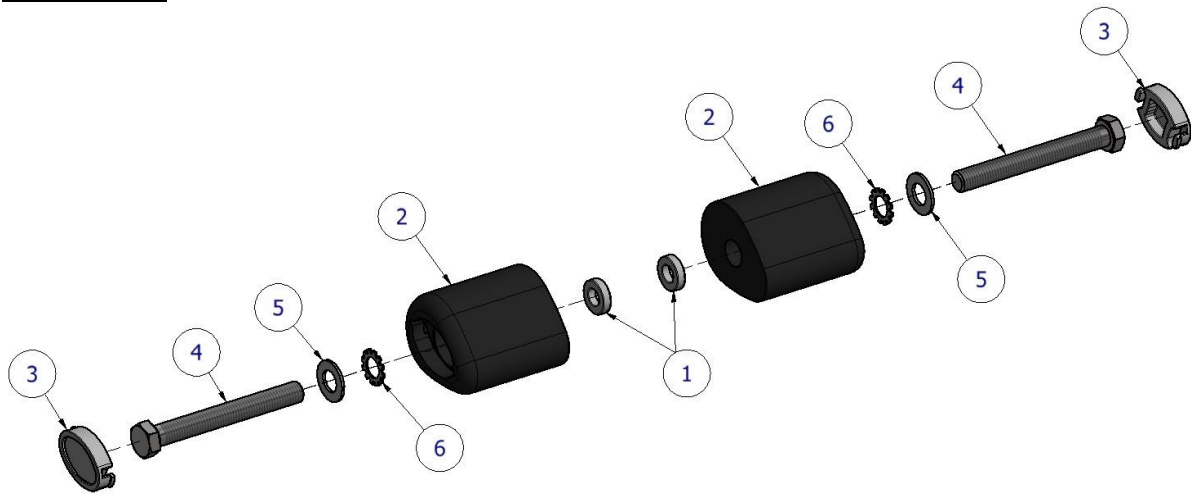

RIGHT SIDE



LEGEND

- ITEM 1= 3mm SPACER (S0184) (x2).
 ITEM 2= CRASH PROTECTOR (B0061 WITH CS340) (x2).
 ITEM 3= BOBBIN CAPS (BC0002) (x2).
 ITEM 4= M12x1.25x110mm LONG HEX HEAD BOLT (x2).
 ITEM 5= M12 PLAIN WASHERS (x2).
 ITEM 6= LOCK-WASHERS (LW0001) (x2).

Page | 2

Please note that in cases where kits are packed with rubber washers holding the components onto the bolt – *the rubber washers should be thrown away!*

TOOLS REQUIRED

- Metric socket set and wrench.
- Torque wrench (up to 40Nm).



INSTRUCTIONS

- On the left side undo and remove the upper engine bolt (picture A). Retain the OEM spacer fitted between the frame and engine to be refitted.
- Take one of the M12 bolts (item 4) and slide a plain washer (item 5) up to the head of the bolt, followed by a lock-washer (item 6). Pass the bolt through a crash protector (item 2) and then slide a 3mm spacer (item 1) over the bolt.
- Fit this assembly to the left side engine bolt hole ensuring the OEM spacer is replaced between the frame and engine.
- Repeat this process for the right side of the bike.
- **PLEASE NOTE BOBBIN MUST BE POSITIONED AS IN PICTURE 'C' ABOVE WITH BIGGER END TOWARD FRONT OF BIKE.** Tighten bolt until you feel some compression from inside the protector. Turn a little more so that you feel the compression increase slightly. Then apply a quarter turn. Tighten to 40Nm of torque (do not exceed this figure, as damage can occur to the motorcycle and the bolt).
- When the protectors are tight fit the bobbin caps (item 3) into the protectors.
- If not already fitted fit bubble sticker into recess of bobbin cap.

DUE TO THE RISK OF CROSS-THREADING OF BOLTS ETC; WE ALWAYS RECOMMEND THAT OUR PRODUCTS BE FITTED BY ONE OF OUR OFFICIAL DEALERS OR A QUALIFIED MECHANIC.

Issue 1 10/08/2018 (HB)

R&G

Unit 1, Shelley's Lane, East Worldham, Alton, Hampshire, GU34 3AQ
 Tel: +44 (0)1420 89007 Fax: +44 (0)1420 87301 www.rg-racing.com Email: info@rg-racing.com



Digital copies of these instructions are available to download from www.rg-racing.com

CONSUMER NOTICE

The catalogue description and any exhibition of samples are only broad indications of the Products and R&G may make design changes which do not diminish their performance or visual appeal and supplying them in such state shall conform to the order. The Buyer acknowledges no representation or warranty (other than as to title) has been given or will apply to the Products other than those in R&G's order or confirmation and the Buyer confirms it has chosen the Products as being of merchantable quality and suitable for its particular purposes. Where R&G fits the Products or undertakes other services it shall exercise reasonable skill and care and rectify any fault free of charge unless the workmanship has been disturbed. The Buyer is responsible for ensuring that the warranty on the motorcycle is not affected by the fitting of the Products. On return of any defective Products R&G shall at its option either supply a replacement or refund the purchase money but shall not be liable if the Products have been modified or used or maintained otherwise than in accordance with R&G's or manufacturer's instructions and good engineering practice or if the defect arises from accident or neglect. Other than identified above and subject to R&G not limiting its liability for causing death and personal injury, it shall not be liable for indirect or consequential loss and otherwise its liability shall be limited to the amounts paid by the Buyer for the Products or the fitting or service concerned. These terms do not affect the Buyer's statutory rights.

R&G RETURNS POLICY (NON-FAULTY GOODS)

Returns must be pre-authorized (if not pre-authorized the return will be rejected). Goods may only be returned direct to us if they were purchased direct from us (customer must prove if necessary). Otherwise to be returned to original vendor. Goods must be in re-sellable condition, in the opinion of R&G. All returns are subject to a 25% restocking and handling fee (25% of the gross value exc. P&P – at the prevailing price at time of purchase). The customer must pay any and all carriage charges. No returns of discontinued products, unless within 14 days of purchase. This policy does not affect your statutory rights and does not refer to faulty goods.



NOTICE DE MONTAGE CP0450 PROTECTIONS CRASH
HONDA CB1000R 2018-

Page | 4



PHOTO A



PHOTO B

Le kit contient les articles exposés ci-dessous, vérifier que toutes les pièces soient présentes avant de procéder au montage.

La façon dont le kit est emballé ne correspond pas forcément à la façon de monter les pièces sur la moto.

LES PARTIES PRESENTEES PEUVENT ETRE UNIQUEMENT REPRESENTATIVES (POUR LA CLARTE DES INSTRUCTIONS UNIQUEMENT)

CÔTÉ GAUCHE

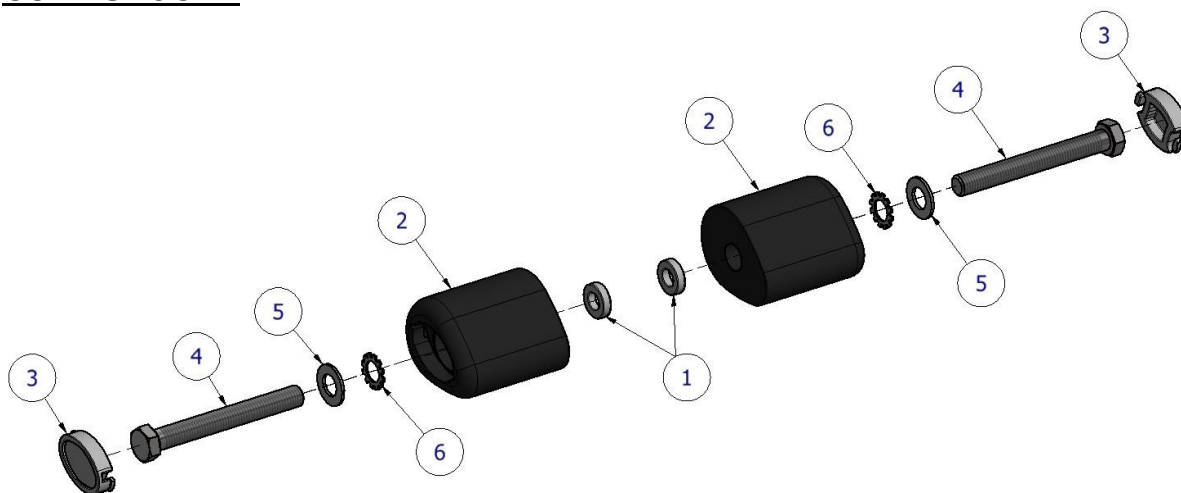

CÔTÉ DROIT

R&G

Unit 1, Shelley's Lane, East Worldham, Alton, Hampshire, GU34 3AQ
 Tel: +44 (0)1420 89007 Fax: +44 (0)1420 87301 www.rg-racing.com Email: info@rg-racing.com



LÉGENDE

ARTICLE 1= 3mm ENTRETOISE (S0184) (x2).

ARTICLE 2= PROTECTION CRASH (B0061 AVEC CS340) (x2).

ARTICLE 3= BOUCHONS DE BOBINES (BC0002) (x2).

ARTICLE 4= M12x1.25x110mm BOULONS (x2).

ARTICLE 5= M12 RONDELLES (x2).

ARTICLE 6= RONDELLES DE BLOCAGE (LW0001) (x2).

Page | 5

Notez que si les kits sont emballés avec des rondelles en caoutchouc servant à tenir les composants, *ces rondelles doivent être jetées !*

OUTILS REQUIS

- Clé à cliquet + douilles.
- Clé dynamométrique (à 40 Nm).

ARRIÈRE MOTO



AVANT MOTO

PHOTO C

NOTICE DE MONTAGE

- Du côté gauche de la moto, enlever le boulon moteur supérieur (photo A). Retenez l'entretoise d'origine insérée entre le cadre et le moteur car elle sera réutilisée.
- Prendre un des boulons M12 (article 4) et glissez une rondelle (article 5) sur la tête du boulon, suivie d'une rondelle de blocage (article 6). Passer le boulon dans la protection crash (article 2) puis glisser une entretoise de 3mm (article 1) sur le boulon.
- Monter l'ensemble sur dans le trou de boulon moteur du côté gauche en veillant à ce que l'entretoise d'origine soit placée entre le cadre et le moteur.
- Répéter ce process du côté droit de la moto.
- **LA PROTECTION DOIT ETRE POSITIONNEE COMME EN "C" AVEC LE CÔTÉ ARRONDI LE PLUS GROS EN DIRECTION DE L'AVANT DE LA MOTO.** Tourner un peu plus afin d'accentuer légèrement la compression. Faire un quart de tour. Serrer à 40Nm de couple (Ne pas excéder cette valeur, car cela pourrait endommager la moto et le boulon).
- Une fois que les protections sont serrées, insérer les bouchons (article 3) dans les protections.
- Si cela n'est pas déjà fait, insérez le sticker dans le creux du bouchon de la protection.

DU FAIT DES RISQUES POTENTIELS ENGENDRES PAR L'INSTALLATION DE NOS PROTECTIONS, NOUS RECOMMANDONS TOUJOURS QUE LE MONTAGE SOIT EFFECTUE PAR UN DE NOS REVENEURS OFFICIELS OU UN MECANICIEN QUALIFIE.

R&G

Unit 1, Shelley's Lane, East Worldham, Alton, Hampshire, GU34 3AQ

Tel: +44 (0)1420 89007 Fax: +44 (0)1420 87301 www.rg-racing.com Email: info@rg-racing.com



Issue 1 10/08/2018 (HB)

Notice disponible au téléchargement sur www.rg-racing.com

Page | 6

CONSUMER NOTICE

The catalogue description and any exhibition of samples are only broad indications of the Products and R&G may make design changes which do not diminish their performance or visual appeal and supplying them in such state shall conform to the order. The Buyer acknowledges no representation or warranty (other than as to title) has been given or will apply to the Products other than those in R&G's order or confirmation and the Buyer confirms it has chosen the Products as being of merchantable quality and suitable for its particular purposes. Where R&G fits the Products or undertakes other services it shall exercise reasonable skill and care and rectify any fault free of charge unless the workmanship has been disturbed. The Buyer is responsible for ensuring that the warranty on the motorcycle is not affected by the fitting of the Products. On return of any defective Products R&G shall at its option either supply a replacement or refund the purchase money but shall not be liable if the Products have been modified or used or maintained otherwise than in accordance with R&G's or manufacturer's instructions and good engineering practice or if the defect arises from accident or neglect. Other than identified above and subject to R&G not limiting its liability for causing death and personal injury, it shall not be liable for indirect or consequential loss and otherwise its liability shall be limited to the amounts paid by the Buyer for the Products or the fitting or service concerned. These terms do not affect the Buyer's statutory rights.

R&G RETURNS POLICY (NON-FAULTY GOODS)

Returns must be pre-authorized (if not pre-authorized the return will be rejected). Goods may only be returned direct to us if they were purchased direct from us (customer must prove if necessary). Otherwise to be returned to original vendor. Goods must be in resellable condition, in the opinion of R&G. All returns are subject to a 25% restocking and handling fee (25% of the gross value exc. P&P – at the prevailing price at time of purchase). The customer must pay any and all carriage charges. No returns of discontinued products, unless within 14 days of purchase. This policy does not affect your statutory rights and does not refer to faulty goods.

R&G

Unit 1, Shelley's Lane, East Worldham, Alton, Hampshire, GU34 3AQ

Tel: +44 (0)1420 89007 Fax: +44 (0)1420 87301 www.rg-racing.com Email: info@rg-racing.com

