



INSTALLATION INSTRUCTIONS

Accessory
BRAIDED LINES REAR BRAKE HOSE
 HOSE
 P/N 08Z56-MFY-100C

Application
VT1300CR/CT/CS

Publications No.
MII 13073
 Issue Date
February 2010

Honda Dealer: Please give a copy of these instructions to your customer.

PARTS LIST

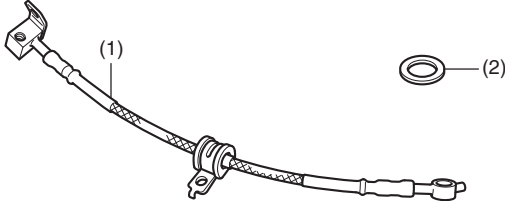

No.	Description	Qty
(1)	Rear brake hose	1
(2)	Oil bolt washer	2

TOOLS AND SUPPLIES REQUIRED

Brake fluid (Pro Honda DOT 4 Brake Fluid)
 Shop towel

Customer Information: The information in these Accessory Installation Instructions are intended for use only by skilled technicians who have the proper tools, equipment, and training to correctly and safely add equipment to the motorcycle.

USE AND CARE INFORMATION

- Inspect the brake hoses and the brake fluid periodically according to the following table.
- I: Inspect and clean, adjust, lubricate or replace if necessary.
- R: Replace.

	x1,000 mi	0.6	4	8	12	16	20	24
	x100 km	10	64	128	192	256	320	384
BRAKE SYSTEM		I			I		I	
BRAKE FLUID	*		I	I	R	I	I	R

- * Replace every two years, or at the indicated odometer interval, whichever comes first. Replacement requires mechanical skill.
- Inspect the brake hoses, pipes, and fittings for deterioration, cracks, damage or signs of leakage.
- If required, replace the oil bolt and oil bolt washer with the following part numbers:
 Oil bolt, P/N 90145-MS9-612
 Oil bolt washer, P/N 90545-300-000

INSTALLATION

CAUTION:

- To prevent burns, allow the engine and exhaust system to cool before installing the accessory.

NOTE:

- Always use the specified brake fluid (Pro Honda Dot 4 Brake Fluid or equivalent).
- Do not mix different types of fluid. They are not compatible.
- Always replace the original oil bolt washers with those included in the kit.
- Always perform air bleeding. Refer to the Service Manual for the proper procedure.
- After installation, confirm that there is no interference with other parts, twisted lines, and fluid leakage.
- Check for proper brake operation.

- Drain the brake fluid. Refer to the Service Manual for proper instructions. **Be careful not to spill brake fluid on any parts as it can damage the paint.**
- Remove the flare nut.

REAR BRAKE HOSE

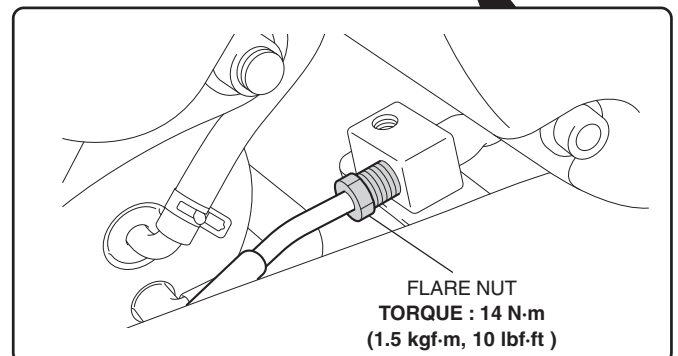
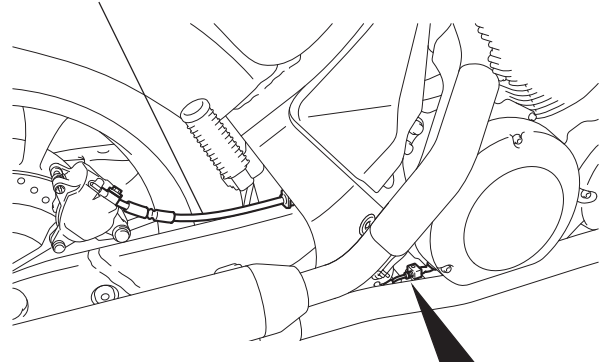

3. Remove the bolt shown below.

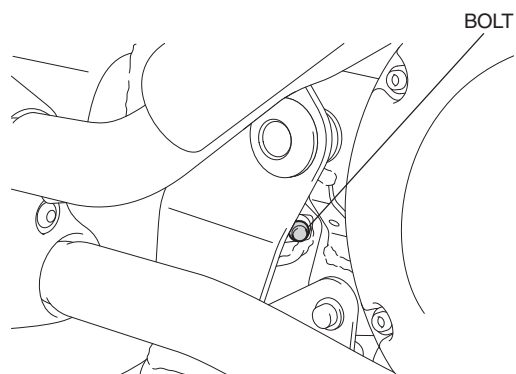

4. Remove the bolt shown below.

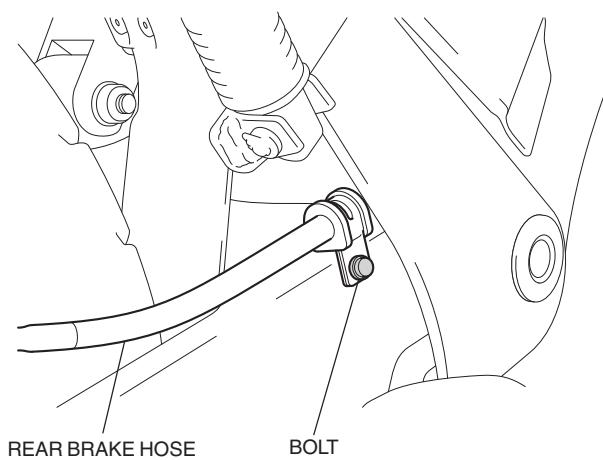

5. Remove the oil bolt.

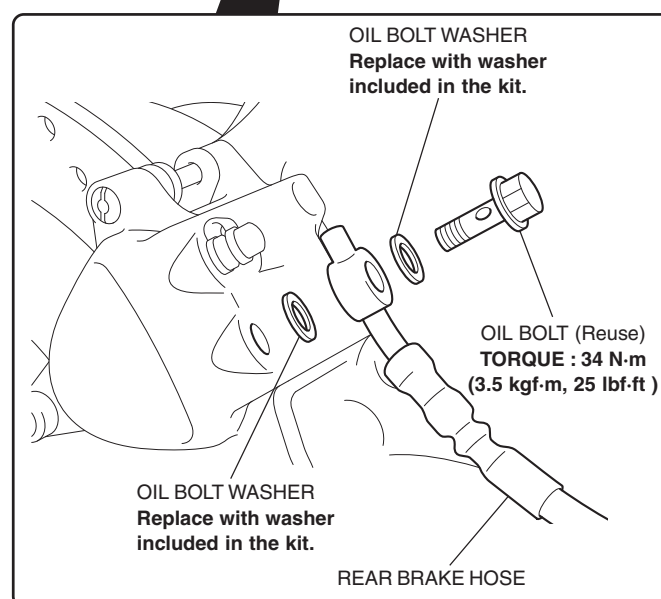
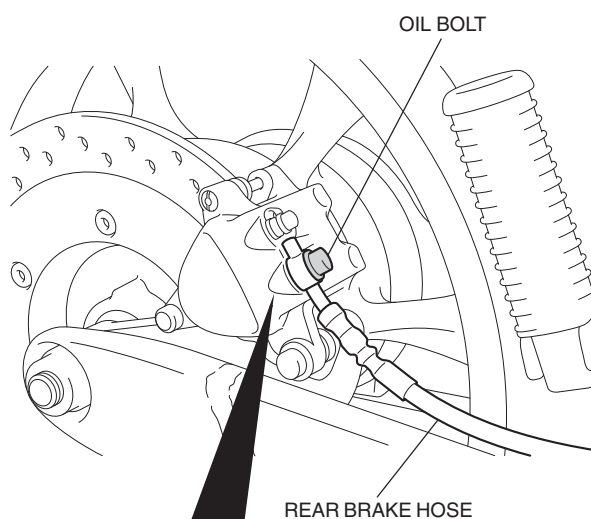

6. Disconnect the rear brake hose as shown.

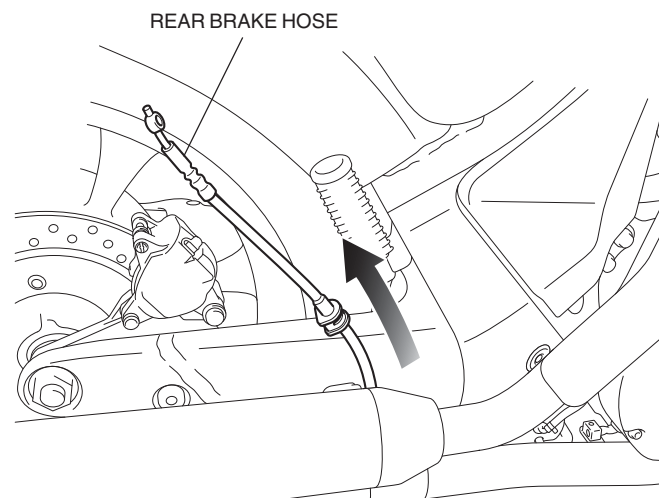

7. Disconnect the rear brake pipe from the disconnected rear brake hose.

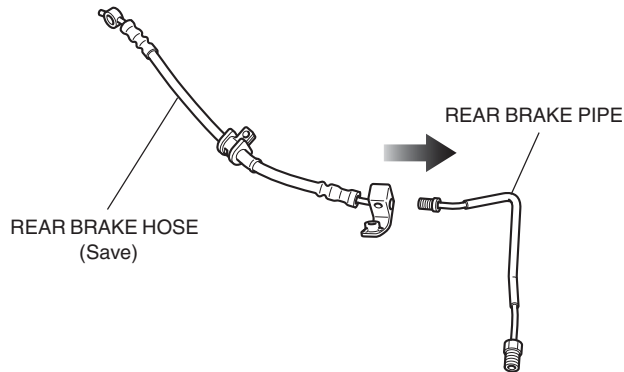

8. Install the disconnected rear brake pipe to the supplied rear brake pipe. **Be careful not to bend or damage the rear brake pipe.**

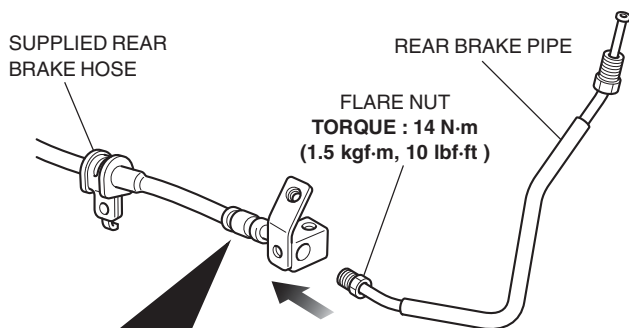

Install the brake pipe onto the supplied hose, on a bench top, so that the pipe is parallel to the bench top.

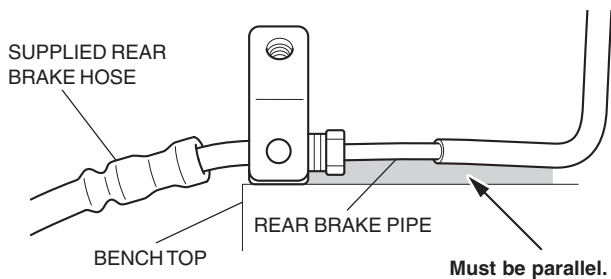

9. Remove the cap from the supplied rear brake hose.

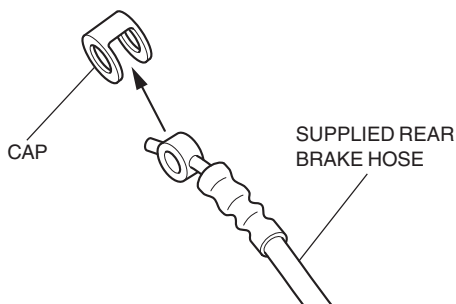

10. Install the supplied rear brake hose in reverse order of the original hose removal.

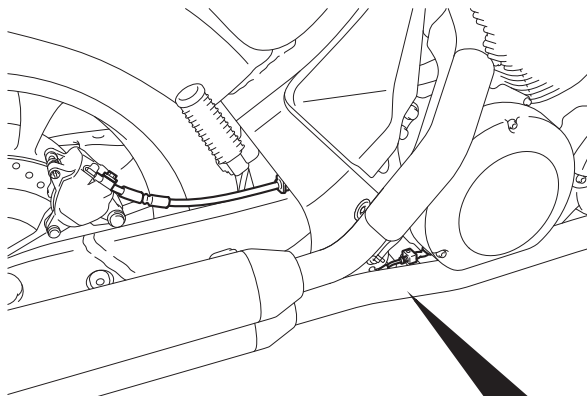

Confirm that the brake pipe does not interfere with the muffler and the bolt as shown.

