



INSTALLATION INSTRUCTIONS

Accessory

ACCESSORY SOCKET
P/N 08U70-MJW-J80

Application

After '15 CB500X/XA

Publication No.

MII 15802

Issue Date

March 2016

Honda Dealer: Please give a copy of these instructions to your customer.

PARTS LIST

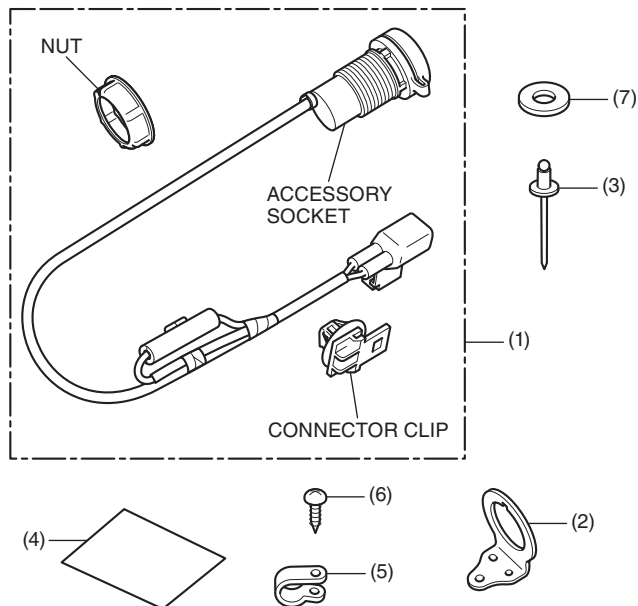

No.	Description	Qty
(1)	Accessory socket	1
(2)	Accessory socket stay	1
(3)	Rivet	3
(4)	Installation Instruction URL	1
(5)	Clip	1
(6)	4 mm screw	1
(7)	Washer	3

TOOLS AND SUPPLIES REQUIRED

Phillips ® screwdriver
 Electric drill
 Drill bit (3.5 mm)
 Ruler
 Electrical tape
 Riveter
 Torque wrench

TORQUE CHART

Tighten all screws, bolts, and nuts to their specified torque values. Refer to the Service Manual for the torque values of the removed parts.

Item	N·m	kgf·m	lbf·ft
4 mm screw	1	0.1	0.7

INSTALLATION

▲ CAUTION

- To prevent burns, allow the engine, exhaust system, radiator, etc., to cool before installing the accessory.

NOTE:

- Disconnect the negative (-) cable from the battery before installing this accessory.
- The clock will be erased when you disconnect the battery. Reset the clock after reconnecting the battery.

- Remove the seat, and disconnect the negative (-) battery cable.

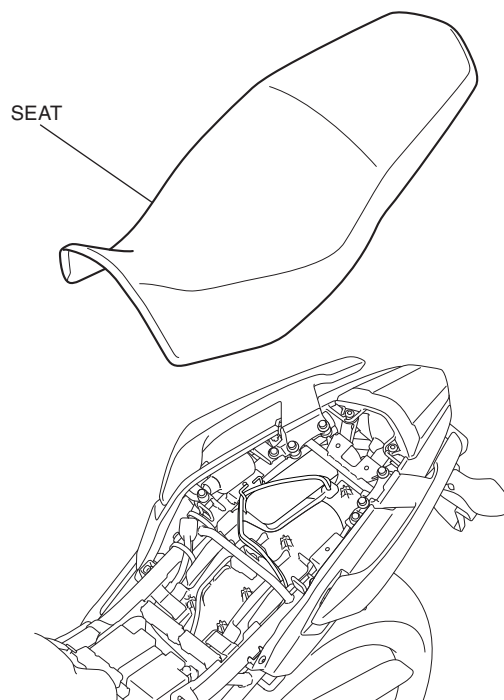

2. Drill at the marked point using an electric drill as shown.

- Use the accessory socket stay as a template to mark the hole locations.
- Be careful not to damage the harness.
- Remove any burrs from the edge of the hole.

Wind the tape around the drill bit. Leave 10 mm of the tip of the drill bit untaped to be used as a stop.

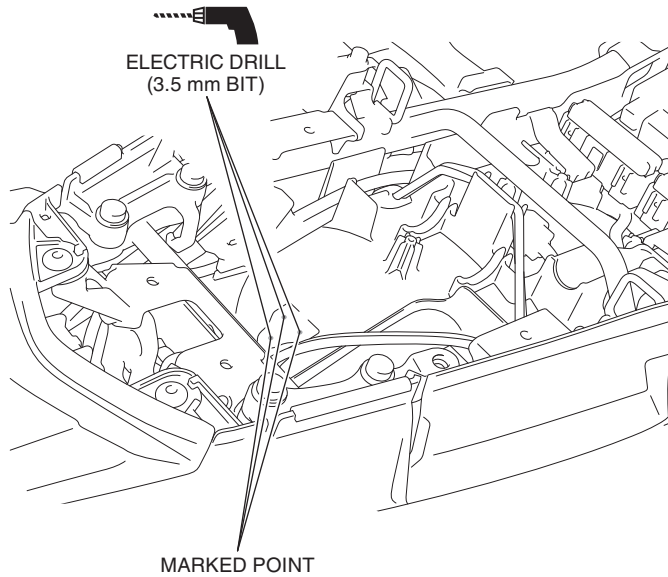
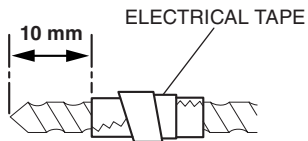

3. Install the accessory socket stay as shown.

<Sectional View>

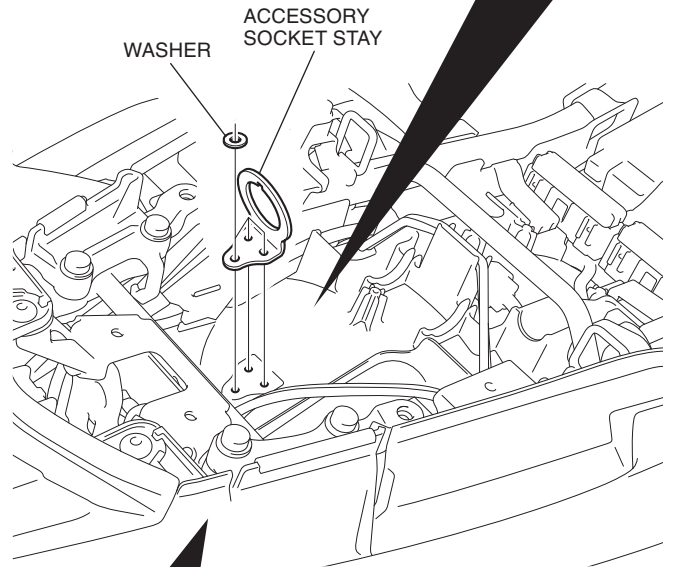
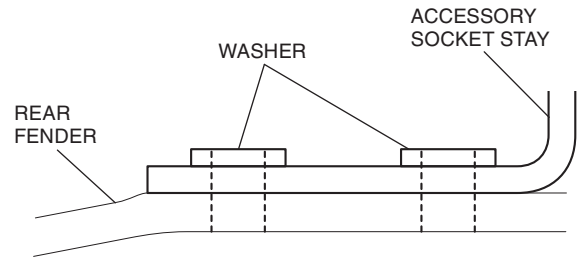

<Backside of the rear fender>

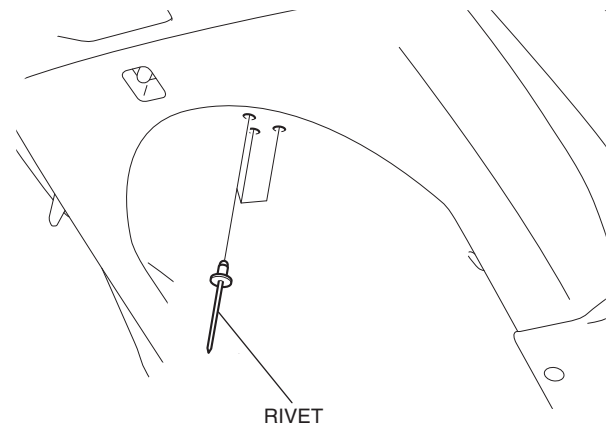

4. Install the accessory socket to the accessory socket stay as shown.

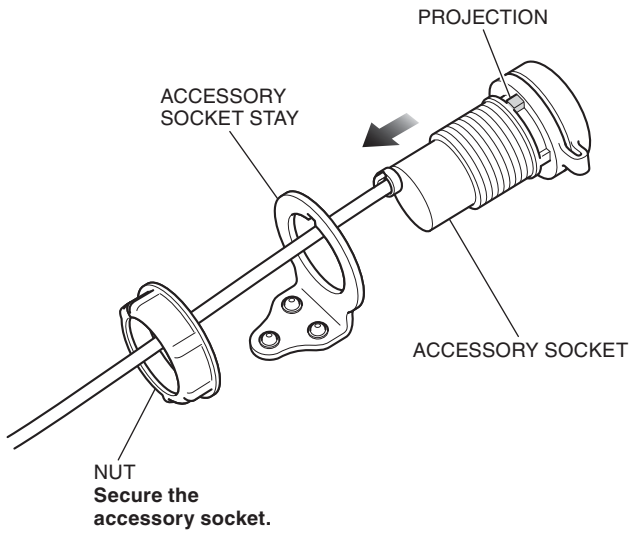

5. Remove the fuse boxes from the rear fender as shown.

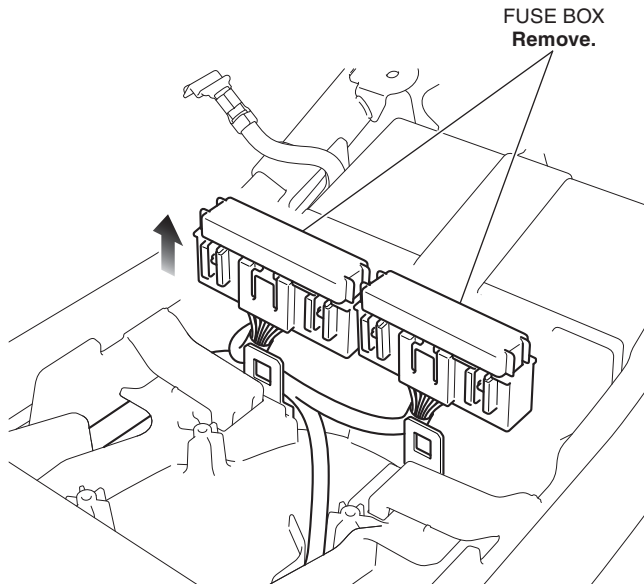

6. Remove the 2-pin waterproof connector as shown.

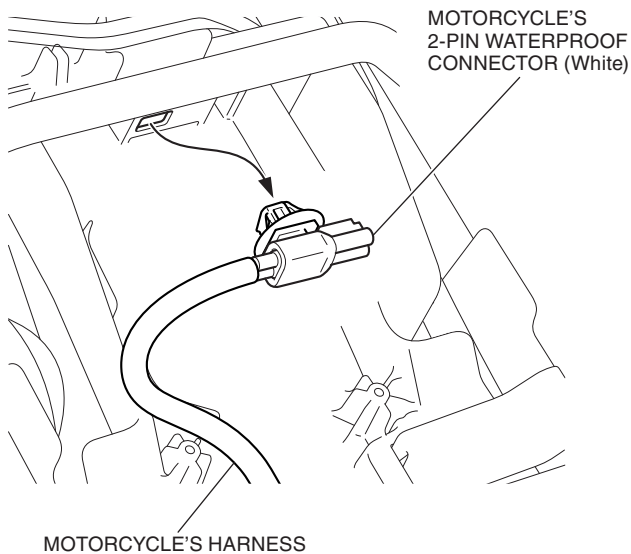

7. Remove the dummy connector as shown.

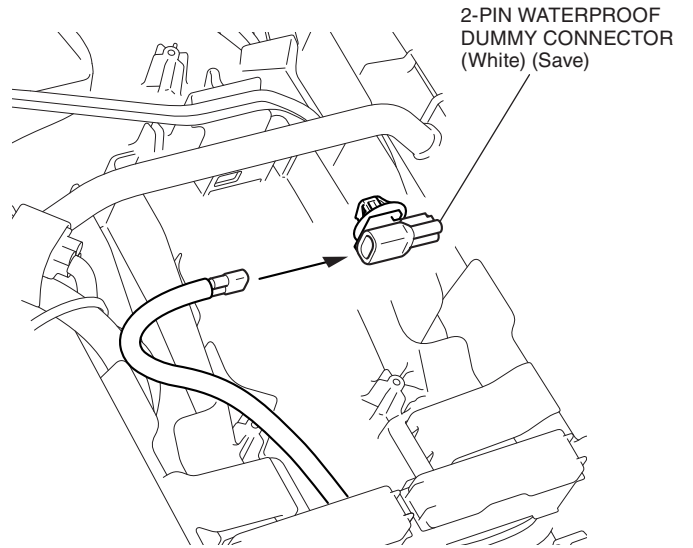

8. Open the cover as shown.

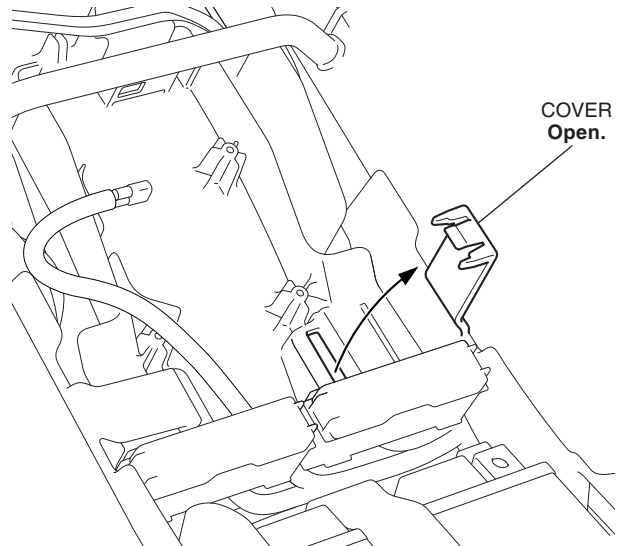

9. Route the accessory socket harness as shown.

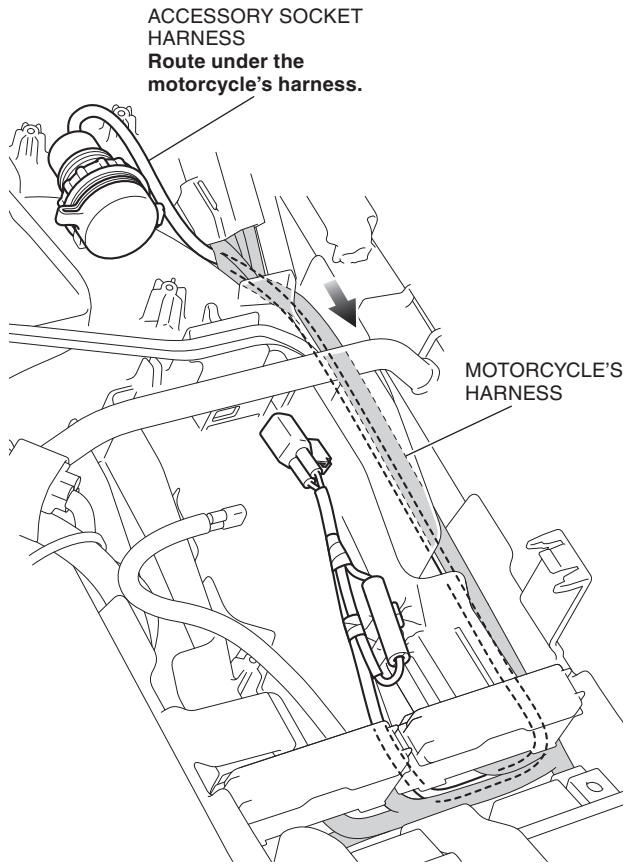

10. Install the connector clip as shown.

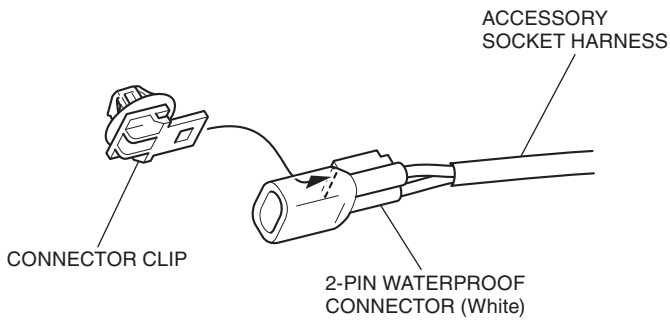

11. Connect the accessory socket harness as shown.

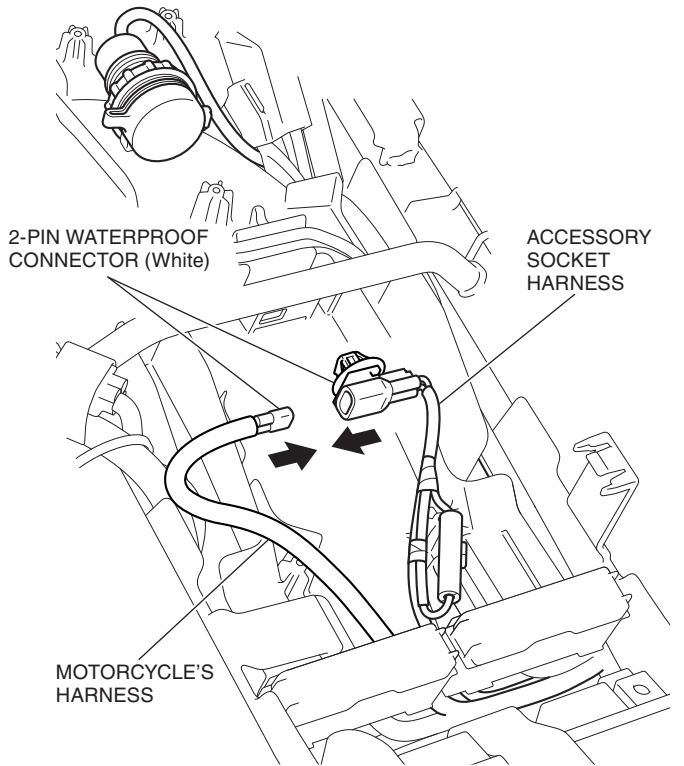

12. Attach the clip to the fuse as shown.

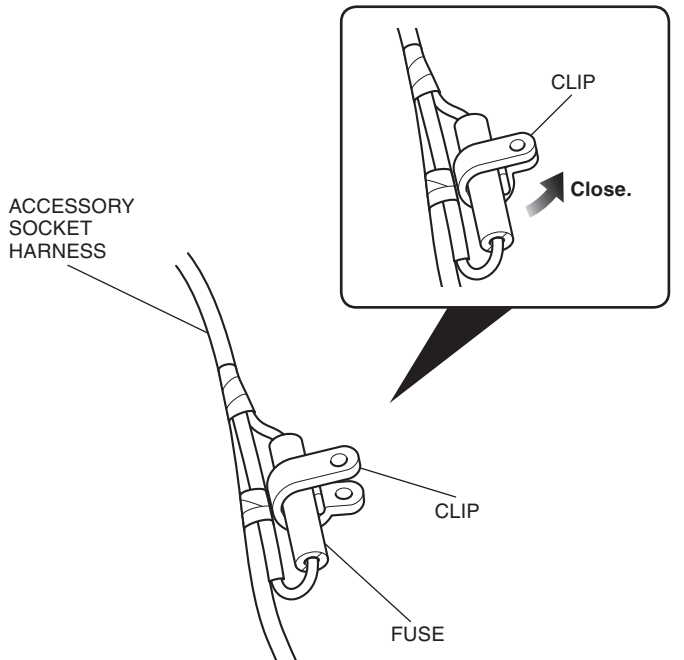

13. Secure the fuse as shown.

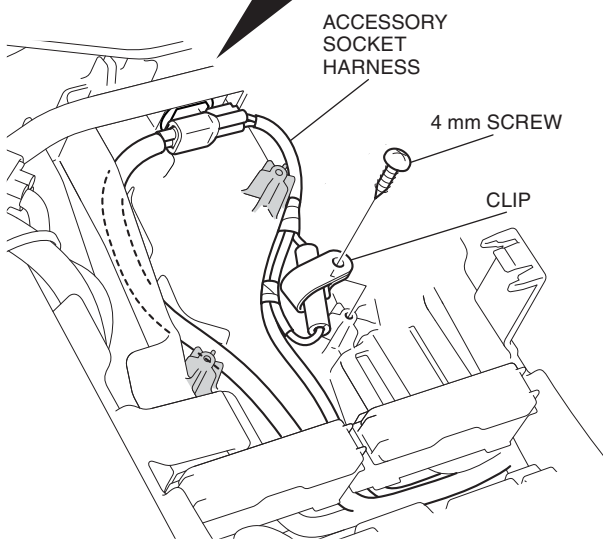
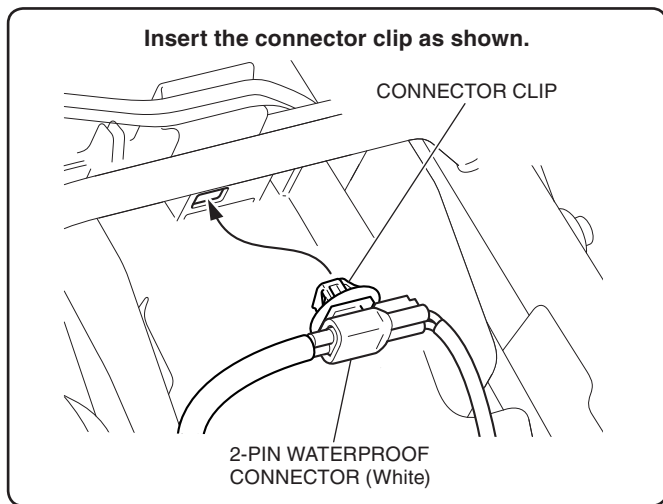

14. Close the cover as shown

- **Confirm that no wire harness is caught or too tight.**

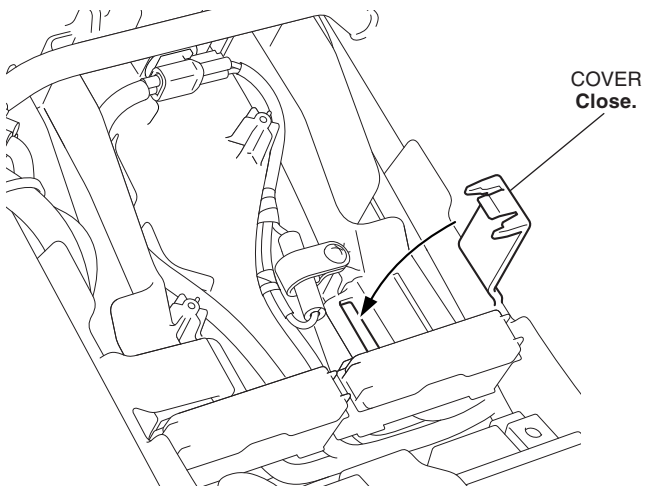

15. Install the motorcycle's parts in the reverse order of removal.

- **Confirm that no wire harness is caught or too tight.**

16. Check the accessory socket, headlight and the other lights for proper operation.