

PARTS LIST

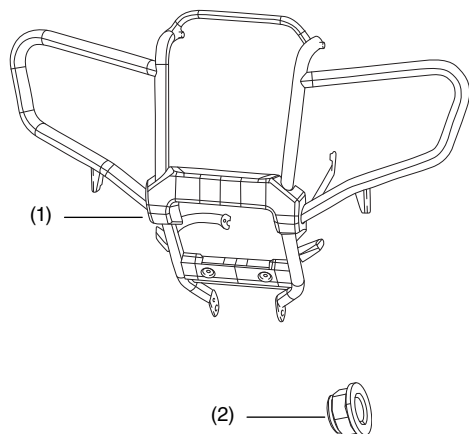

| No. | Description | Qty |
|-----|--------------|-----|
| (1) | Front bumper | 1 |
| (2) | 6 mm U-nut | 2 |

TOOLS AND SUPPLIES REQUIRED

Ratchet

Torque wrench

10 mm socket

12 mm socket

12 mm wrench

TORQUE CHART

Tighten all screws, bolts, and nuts to their specified torque values. Refer to the Service Manual for the torque values of the removed parts.

USE AND CARE INFORMATION

- Check the accessory mounts frequently and retighten if necessary
- Replace this accessory with a new one if it is damaged.

INSTALLATION

1. Refer to the Service Manual for the vehicle and remove the following:

- Engine guard
- Front carry pipe and reflectors*

Note that some of the removed hardware will be reused.

* If equipped. Discard the U-nut.

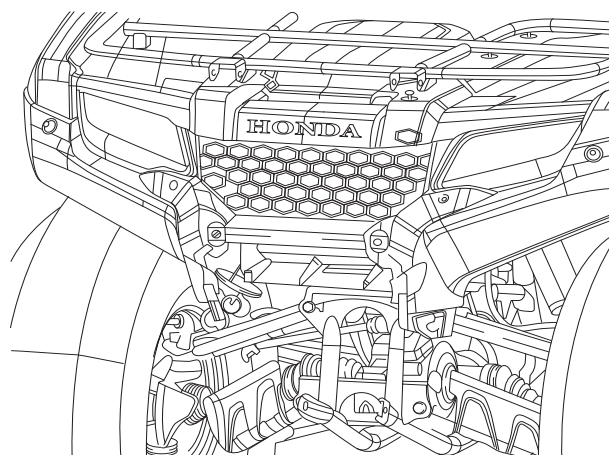

2. Place the accessory front bumper in the position shown.

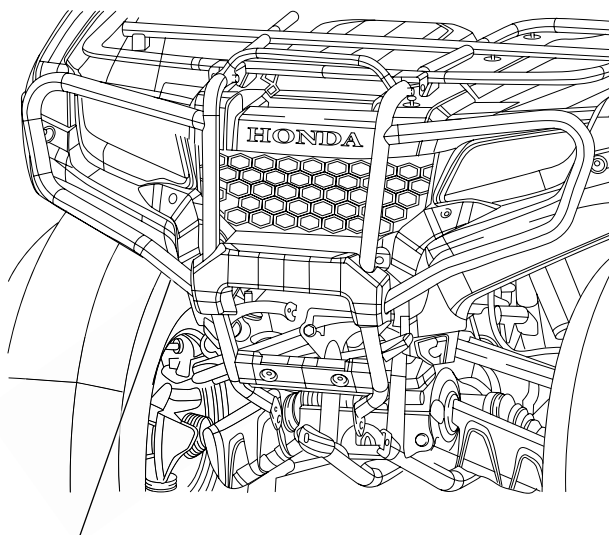

ACCESSORY FRONT BUMPER

3. Reinstall and tighten the six 8 mm bolts and nuts to the torque specified in the Service Manual.

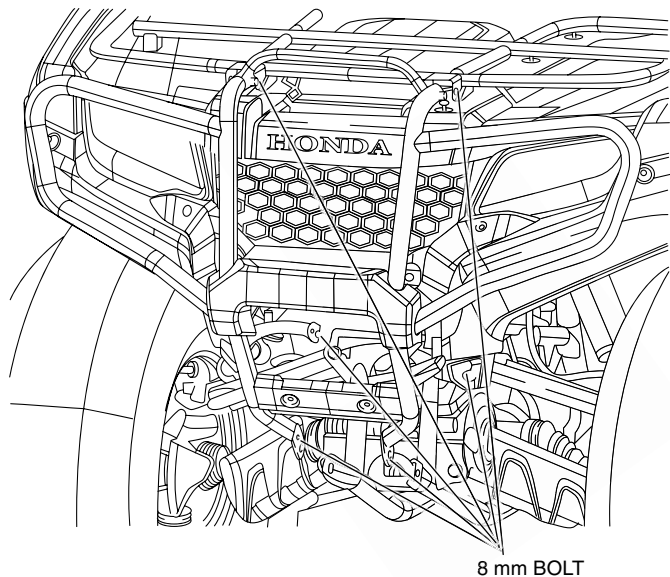

4. Reinstall and tighten the two 6 mm bolts to the torque specified in the Service Manual.

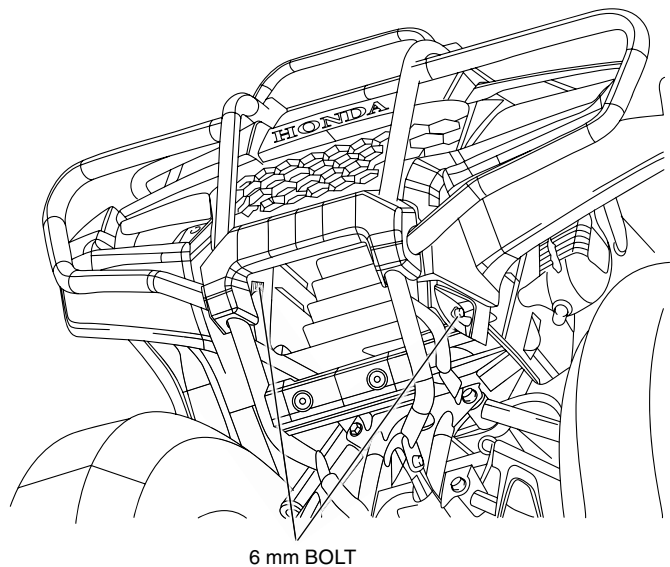

5. Reinstall the reflectors (if equipped) onto the accessory bumper with the supplied U-nuts. Tighten the U-nuts securely.

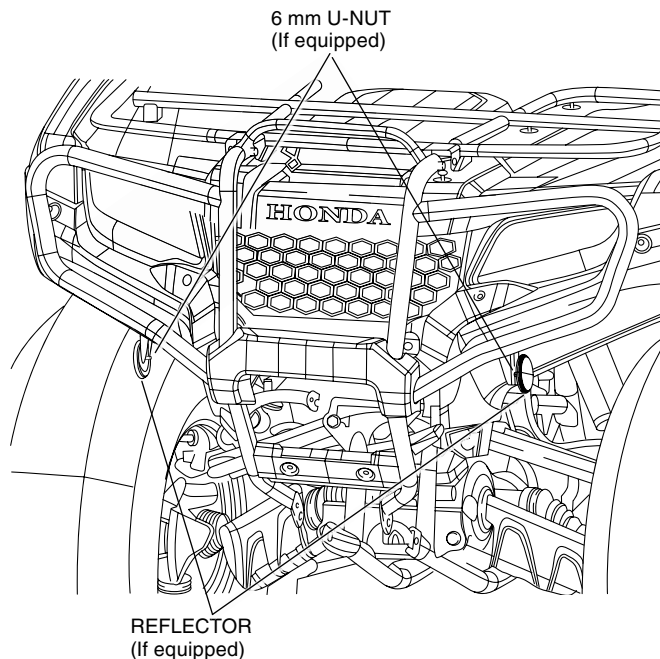

6. Refer to the Service Manual for the vehicle, reinstall engine guard.