

Accessory	Application	Publication No.
REAR CARRIER P/N 08L70-K87-A00 08L70-K87-J00	CMX500/A CMX300/A	MII 16241
		Issue Date
		April 2017

**Honda Dealer: Please give a copy of these instructions to your customer.**

## PARTS LIST

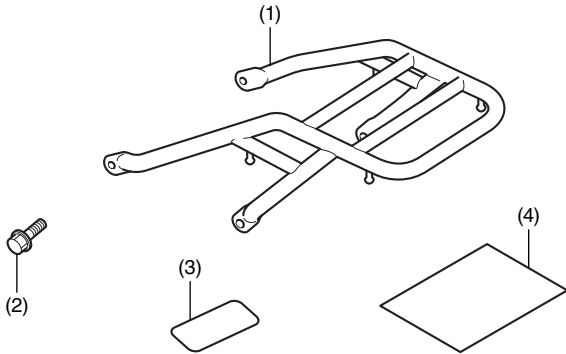

No.	Description	Qty
(1)	Rear carrier	1
(2)	8 mm flange bolt	4
(3)	Safety label	1
(4)	Installation Instruction URL	1

## TOOLS AND SUPPLIES REQUIRED

- Socket (12 mm)
- Ratchet
- Isopropyl alcohol
- Shop towel
- Torque wrench

## TORQUE CHART

Tighten all screws, bolts, and nuts to their specified torque values. Refer to the Service Manual for the torque values of the removed parts.

Item	N-m	kgf-m	lbf-ft
8 mm flange bolt	27	2.8	20

## MAXIMUM LOADING CAPACITY

- The weight of the cargo must not exceed the following maximum loading capacity:

Maximum Loading Capacity	
Rear carrier	3.0 kg (6.6 lb)

## INSTALLATION (For solo rider)

### ▲ CAUTION

- To prevent burns, allow the engine, exhaust system, radiator, etc., to cool before installing the accessory.

### NOTE:

- When applying the safety label, heat the bonding surfaces with a hair dryer if the ambient air temperature is below 70°F (21°C).
- The adhesive reaches full strength in 72 hours. Wait at least 24 hours before riding your motorcycle.
- Take care not to damage the painted surfaces of the motorcycle.

1. Refer to the Service Manual for the motorcycle, remove the bolts as shown.

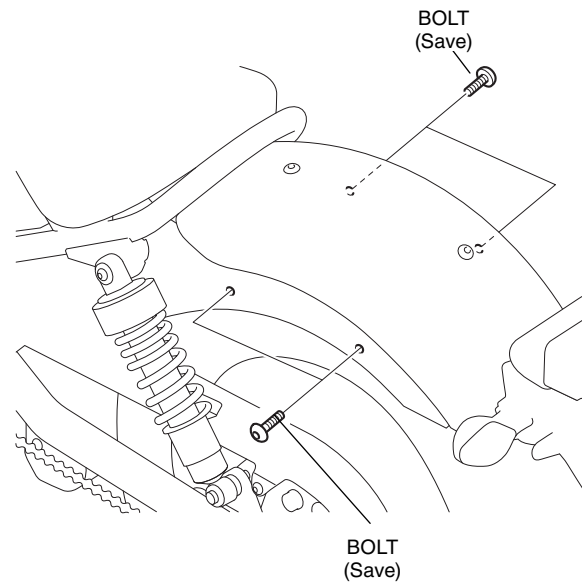

2. Install the 8 mm bolts and rear carrier as shown.

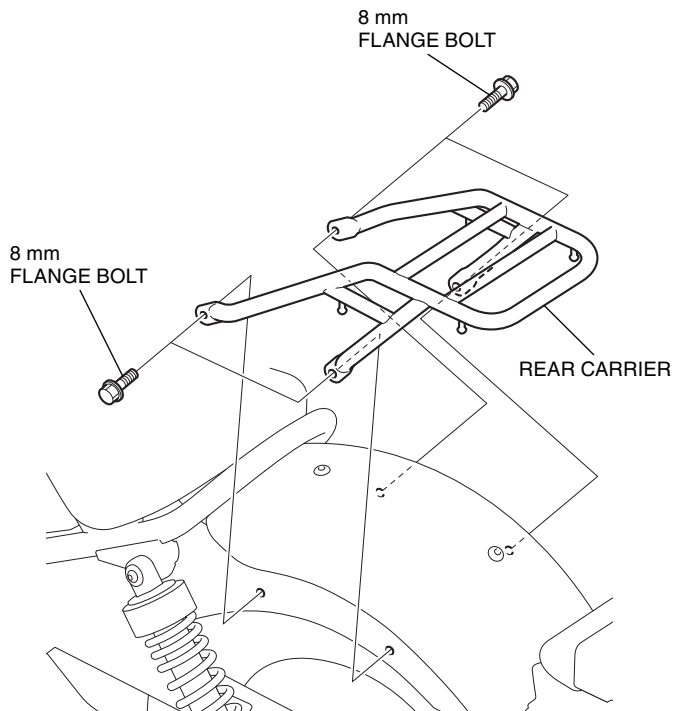

3. Attach the safety label in the position shown.

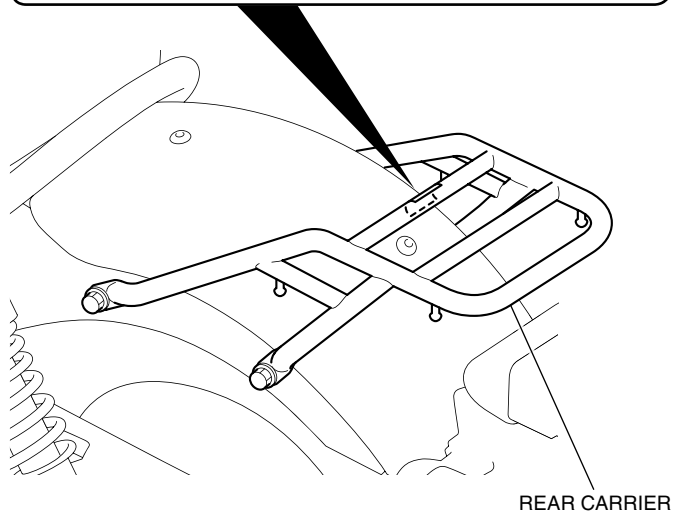
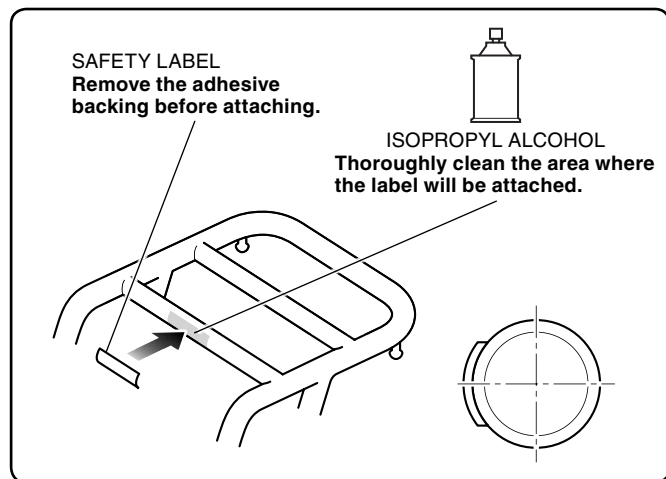

## INSTALLATION (With accessory passenger seat)

### ▲ CAUTION

- To prevent burns, allow the engine, exhaust system, radiator, etc., to cool before installing the accessory.

### NOTE:

- When installing the safety label, heat the bonding surfaces with a hair dryer if the ambient air temperature is below 70°F (21°C).
- The adhesive reaches full strength in 72 hours. Wait at least 24 hours before riding your motorcycle.
- Take care not to damage the painted surfaces of the motorcycle.

1. Refer to the Service Manual for the motorcycle, remove the motorcycle parts.

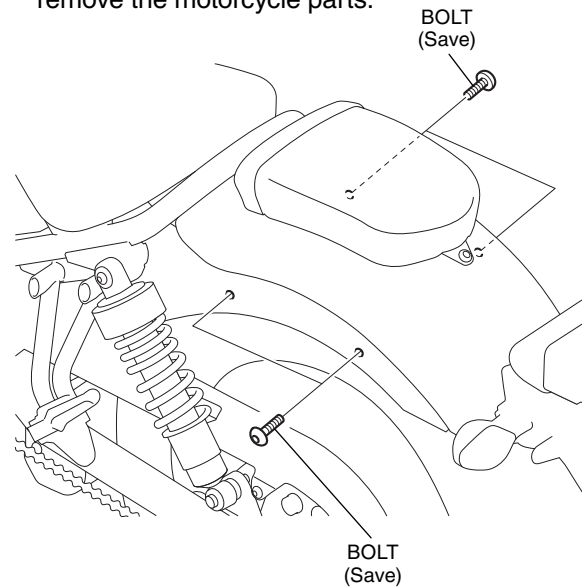

2. Install the 8 mm flange bolts and rear carrier as shown.

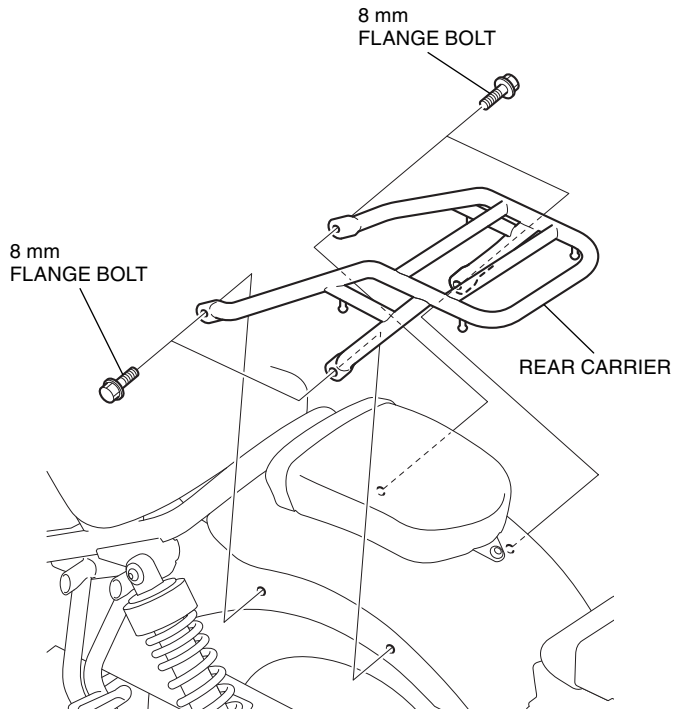

3. Attach the safety label in the position shown.

