



INSTALLATION INSTRUCTIONS

Accessory
CUSTOM RIDER SEAT
 P/N 08F82-MFR-210A/220A/230A
CUSTOM PASSENGER SEAT
 P/N 08F82-MFR-210B/220B/230B

Application
VT1300CX

Publications No.
MI112764
 Issue Date
February 2009

Honda Dealer: Please give a copy of these instructions to your customer.

PARTS LIST

P/N 08F82-MFR-210A/220A/230A

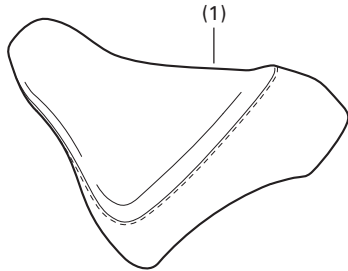

No.	Description	Qty
(1)	Custom Rider Seat	1

P/N 08F82-MFR-210B/220B/230B

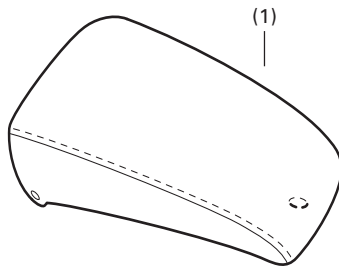

No.	Description	Qty
(1)	Custom Passenger Seat	1

TOOLS REQUIRED

Hex wrench (5 mm)
 Torque wrench

TORQUE CHART

Tighten all screws, bolts, and nuts to their specified torque values. Refer to the Service Manual for the torque values of the removed parts.

Item	N·m	kgf·m	lbf·ft
6 mm screw	9	0.9	6.5
8 mm screw	22	2.2	16

USE AND CARE INFORMATION

- Clean the seat often with a clean, damp cloth. If the seat is dirty, use a small amount of mild soap approved for leather surfaces.
- Apply a high quality leather conditioner to the clean, dry leather and seams.
- Honda custom seats feature color stitching and/or stylized surfaces. As with genuine cowhide leather, these surfaces are not designed for long-term exposure to inclement weather and should be protected.
- Keep the seat dry. If the leather gets wet, dry the surface with a clean towel. Do not let the seat dry in the direct sunlight. If possible, allow the seat to dry at room temperature with adequate ventilation.

INSTALLATION

1. Remove the seat from the motorcycle as shown.

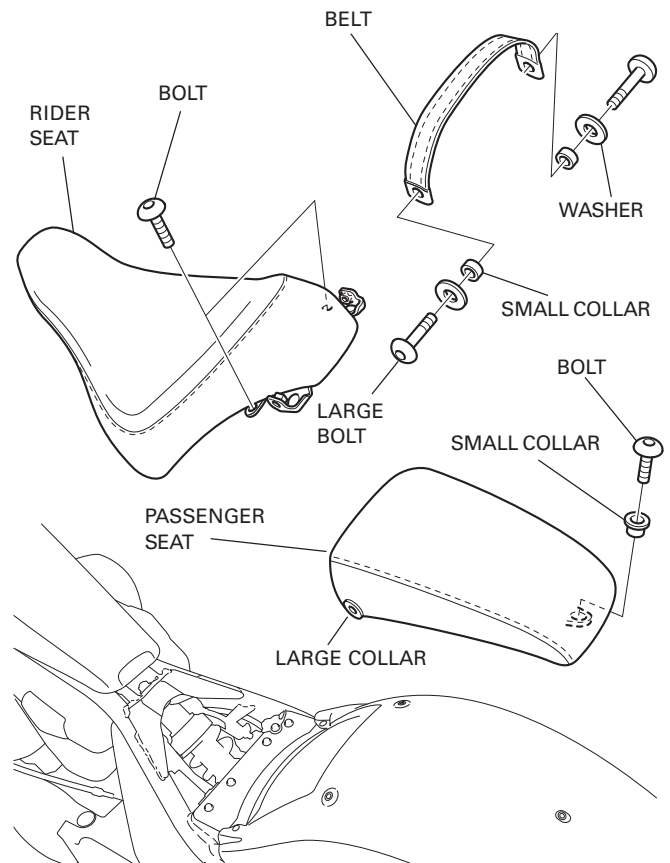

2. Remove the belt bracket from the rider seat. Then install to the custom rider seat. Torque the bolts.

NOTE: The belt bracket should be installed with the flat side adjacent to the seat.

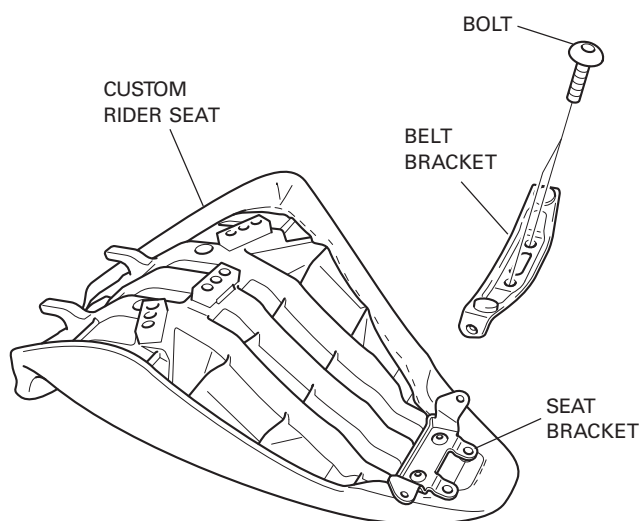

3. Remove the large collars from the passenger seat and install them on the custom passenger seat.

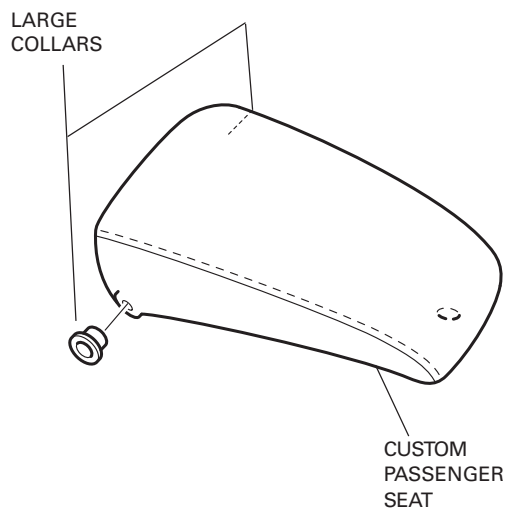

4. Install the custom seats using the existing bolts, collars, and washers. Tighten the bolts to their specified torque values.

