



INSTALLATION INSTRUCTIONS

Accessory
BACKREST/REAR CARRIER MOUNTING BRACKET
 P/N 08F75-MFY-101

Application
 VT1300CR/CT
 VT1300CS

Publications No.
MII 13075-13256
 Issue Date
Revised April 2010

Honda Dealer: Please give a copy of these instructions to your customer.

PARTS LIST

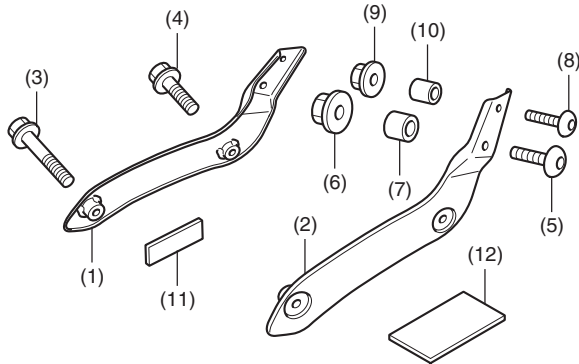

No.	Description	Qty
(1)	Right backrest stay	1
(2)	Left backrest stay	1
(3)	8 mm flange bolt (long)	2
(4)	8 mm flange bolt (short)	2
(5)	8 mm socket bolt	2
(6)	8 mm flange nut	2
(7)	Collar (large)	2
(8)	6 mm socket bolt	2
(9)	6 mm flange nut	2
(10)	Collar (small)	2
(11)	Rubber cushion	4
(12)	Double-sided adhesive tape	2

BACKREST KIT (TALL) Sold separately (P/N 08F75-MFY-100B)

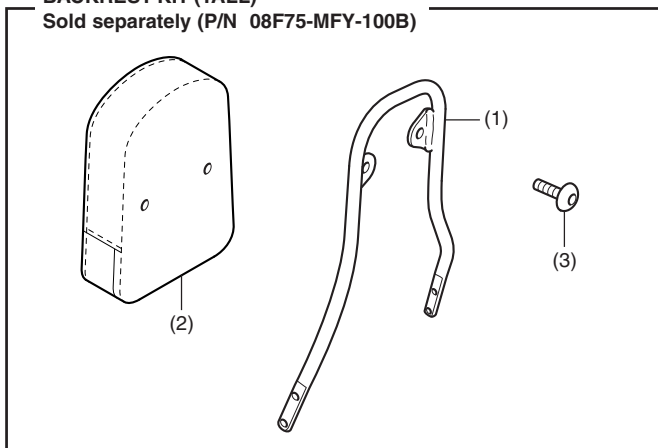

No.	Description	Qty
(1)	Backrest bar	1
(2)	Pad	1
(3)	6 mm screw	2

BACKREST KIT (LOW) Sold separately (P/N 08F75-MFY-100C)

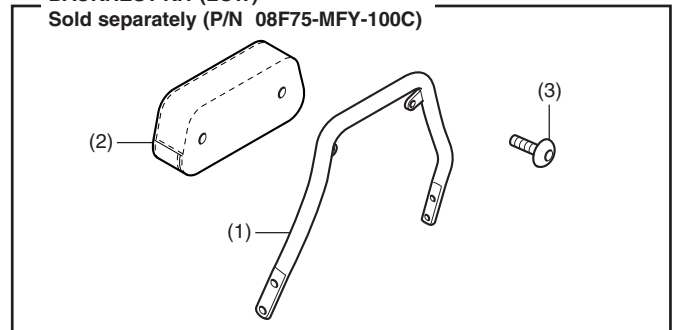

No.	Description	Qty
(1)	Backrest bar	1
(2)	Pad	1
(3)	6 mm screw	2

REAR CARRIER Sold separately (P/N 08L42-MFY-100)

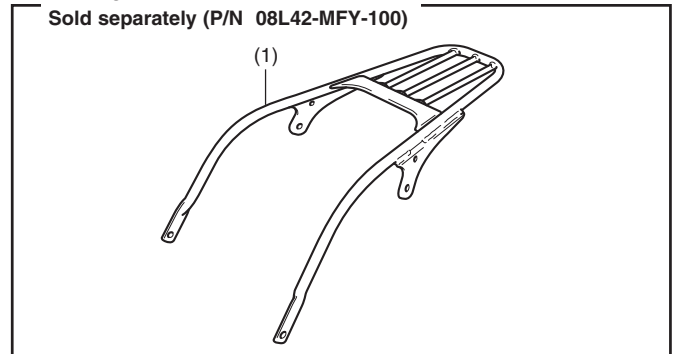

No.	Description	Qty
(1)	Rear carrier	1

TOOLS AND SUPPLIES REQUIRED

Socket (10 and 12 mm)
Ratchet
Box-end wrench (10 and 12 mm)
Hex wrench (5 and 7 mm)
Electric drill
Drill bit (6.5 mm)
Holesaw (30 mm)
Wood block
Tape
Awl
Isopropyl alcohol
Shop towel
Torque wrench

TORQUE CHART

Tighten all screws, bolts, and nuts to their specified torque values. Refer to the Service Manual for the torque values of the removed parts.

Item	N-m	kgf-m	lbf-ft
6 mm screw	9	0.9	6.6
6 mm socket bolt	10	1.0	7
6 mm flange nut	12	1.2	9
8 mm socket bolt	22	2.2	16
8 mm flange bolt and nut	27	2.8	20

USE AND CARE INFORMATION

- The weight of the cargo must not exceed the following maximum weight capacity:

Maximum Weight Capacity	
Rear carrier	6.6 lbs (3 kg)

- Check the accessory mounts frequently and retighten if necessary.

INSTALLATION

VT1300CT:

- To install this accessory on VT1300CT refer to the Installation Instructions for the saddlebag mounting bracket (P/N 08L56-MFY-100B).

1. Remove the left side cover as shown.

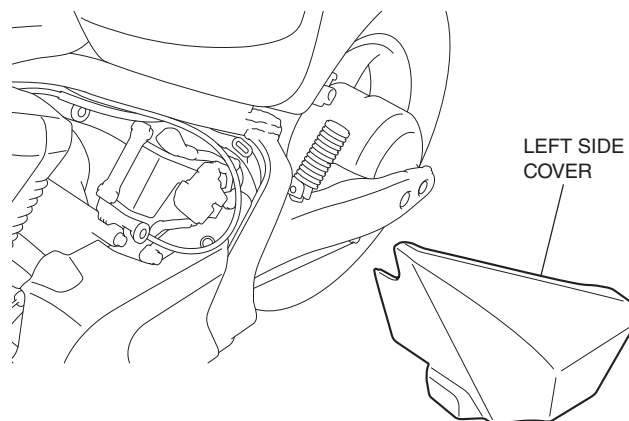

2. Repeat on the right side.

3. Remove the seat bolts as shown.

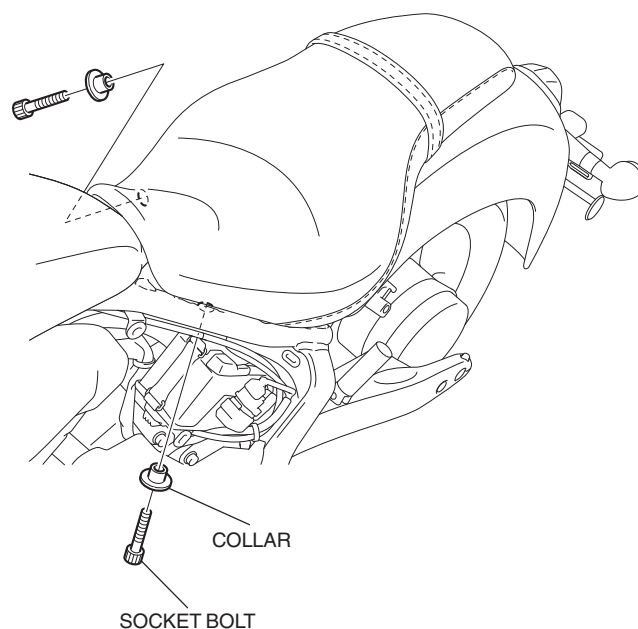

4. Remove the seat from the motorcycle as shown.

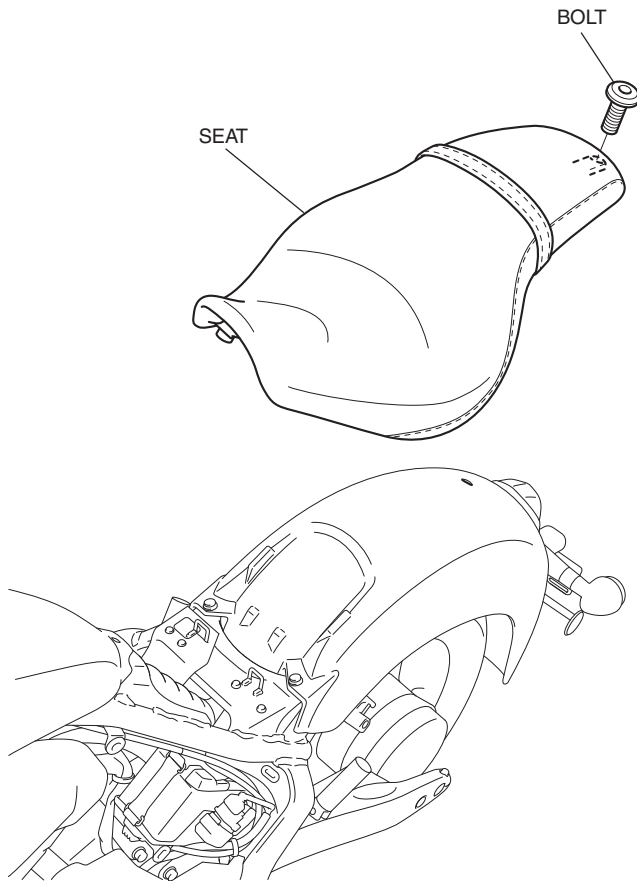

5. Remove the two screws and license light cover as shown.

- **Applies to VT1300CR only.**

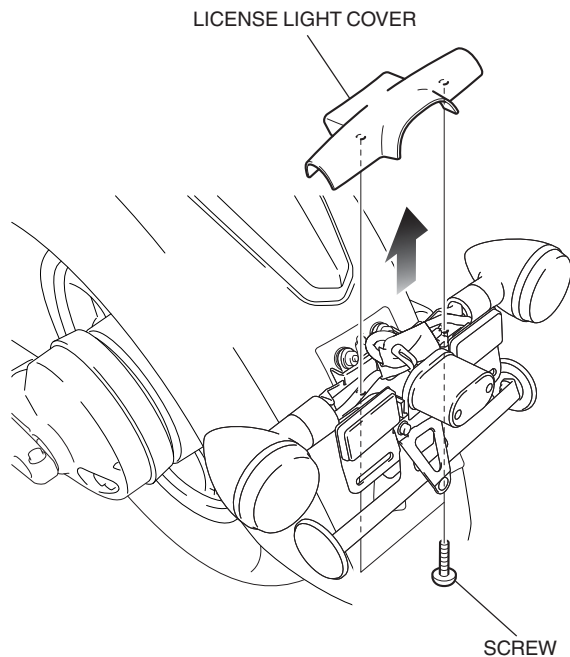

6. Disconnect the connectors.

- **Applies to VT1300CR only.**

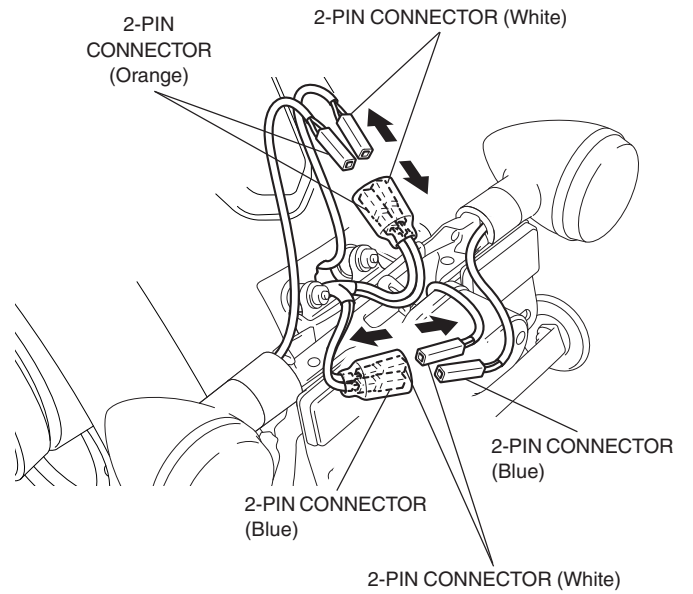

7. Remove the nuts as shown.

- **Applies to VT1300CR only.**

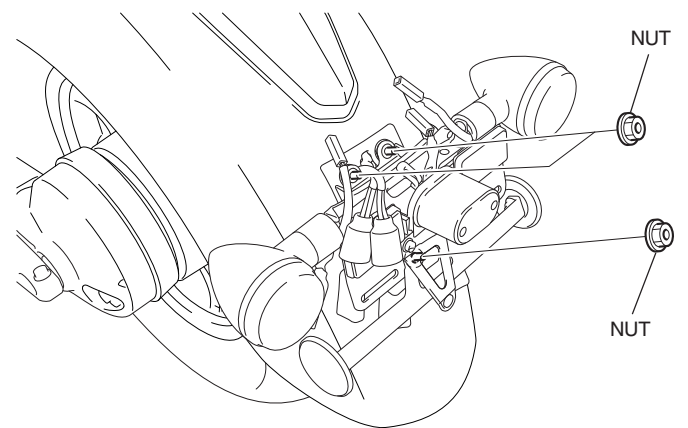

8. Remove the rear turn signal light as shown.

- **Applies to VT1300CR only.**

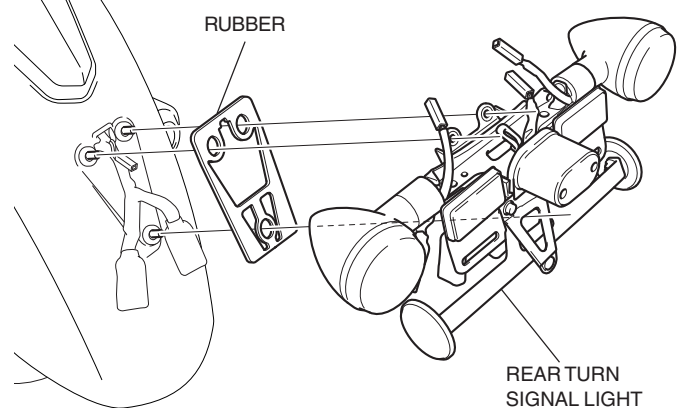

9. Insert a 6.5 mm (17/64 in) drill bit through the mounting hole in the sub-frame as shown. Make a mark on the inside of the rear fender by twisting the drill bit with your fingers.

- **Applies to VT1300CR/CS only.**

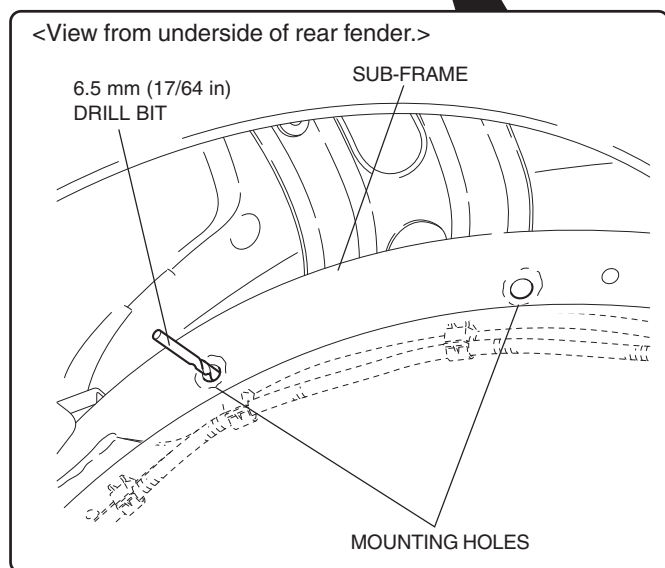
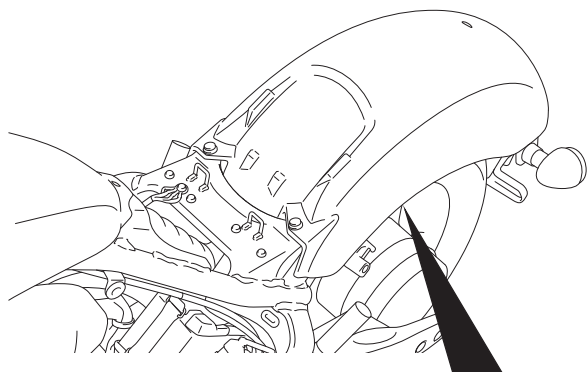

10. Repeat the above procedure on the remaining right and left side mounting holes.

11. Remove the rear fender as shown.

- **Applies to VT1300CR/CS only.**
- **The illustration is for VT1300CR, but it is the same for VT1300CS.**

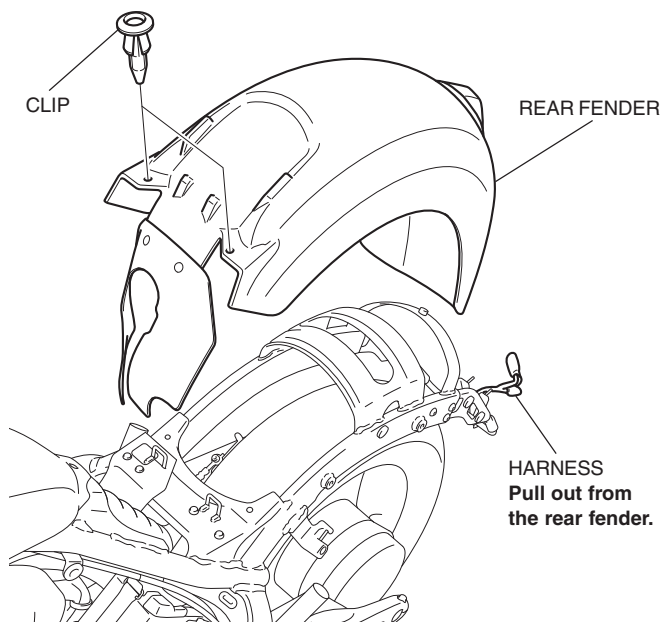

12. Apply two strips of tape to the rear fender according to the dimensions shown. Do this on both sides.

- **This step is applicable only to the VT1300CS.**

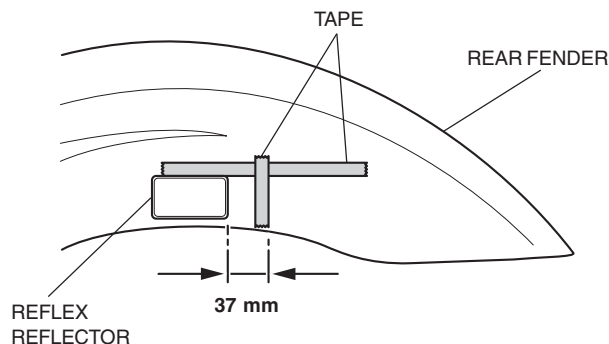

13. Remove the reflex reflector from the rear fender.

- **This step is applicable only to the VT1300CS.**

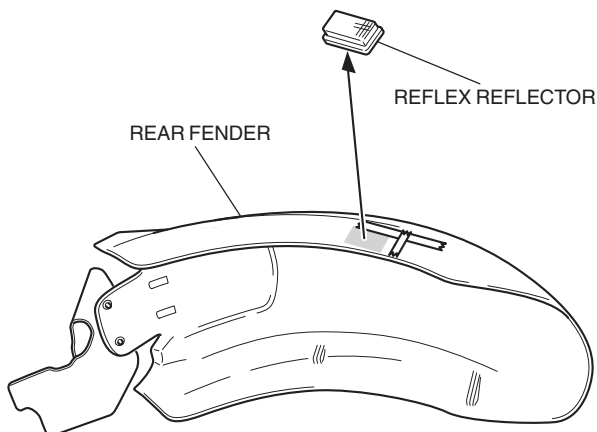

14. Remove the double-sided adhesive tape from the reflex reflector you just removed.

- **This step is applicable only to the VT1300CS.**

DOUBLE-SIDED ADHESIVE TAPE
(Replace with a new one from the kit)

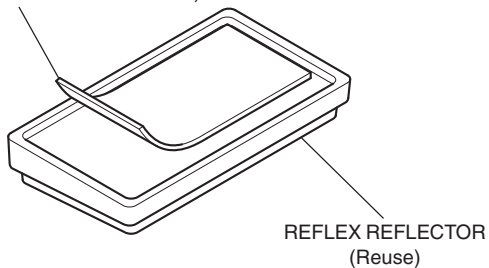

15. Attach the reflex reflector in the position shown.

- **This step is applicable only to the VT1300CS.**

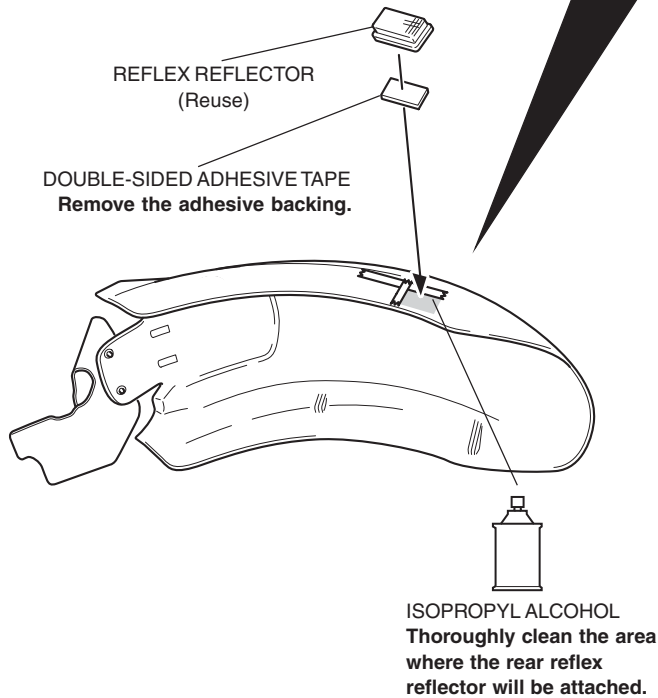
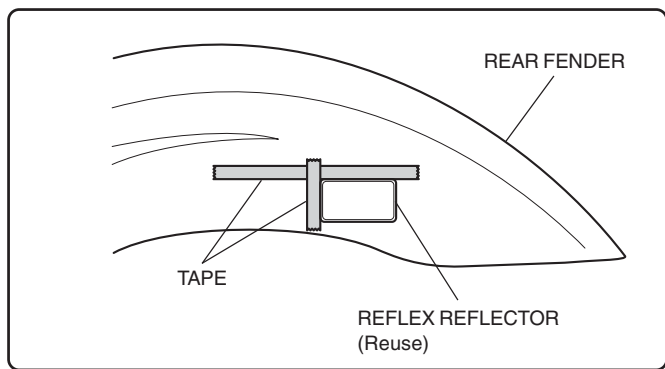

16. Drill the rear fender at the marked points as shown.

- **Remove any burrs from the edge of the hole.**

<Left side>

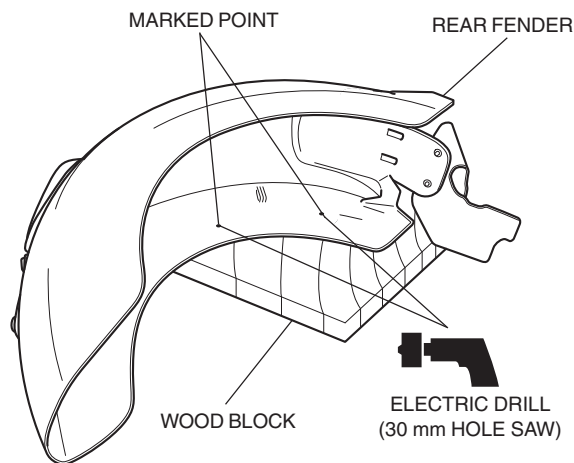

<Right side>

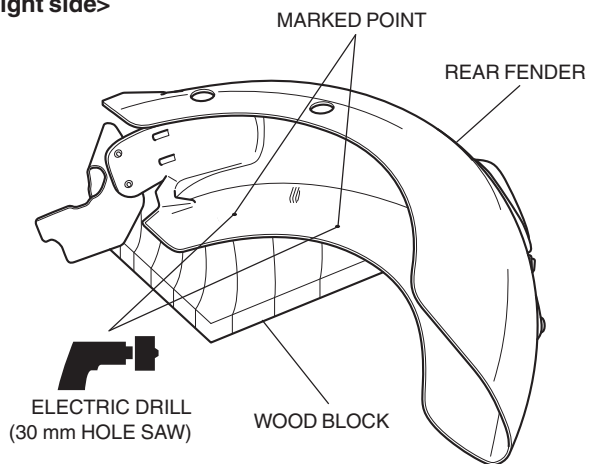

17. Install the motorcycle's parts in the reverse order of removal.

18. Install the pad (sold separately) on the backrest bar (sold separately) as described:

For Installing the Backrest (TALL) Kit

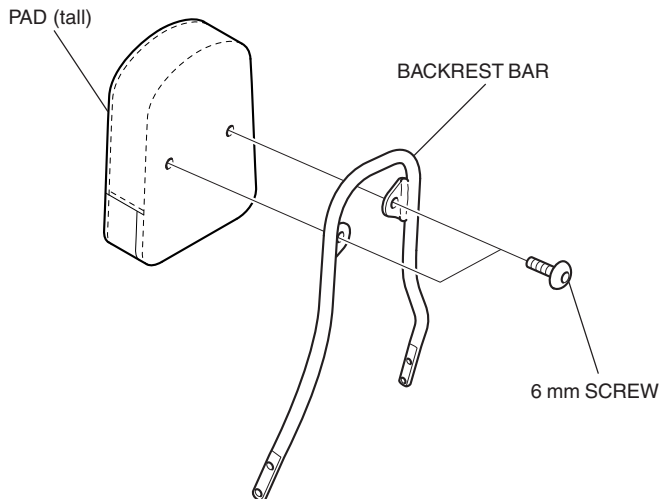

For Installing the Backrest (LOW) Kit

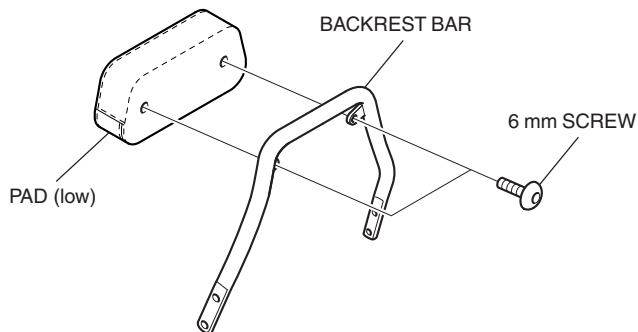

19. Attach the rubber cushions as shown.

- Repeat on the left side.

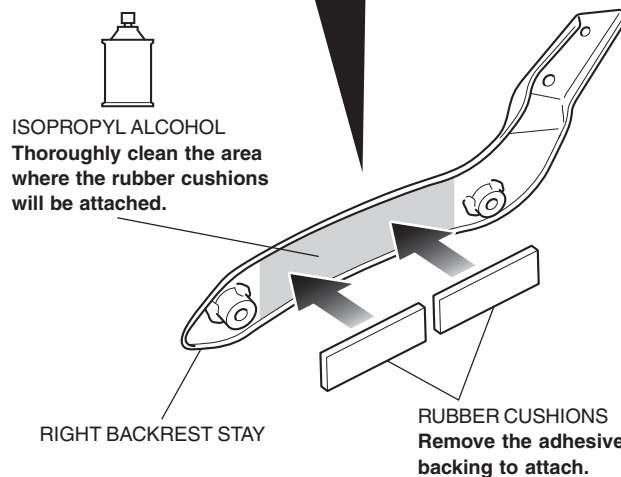
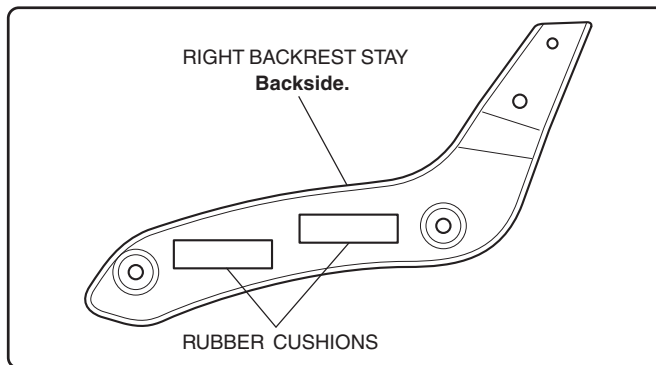

To install the Backrest With Pad (TALL) or the Backrest With Pad (LOW)

1. Loosely install the left backrest stay as shown.

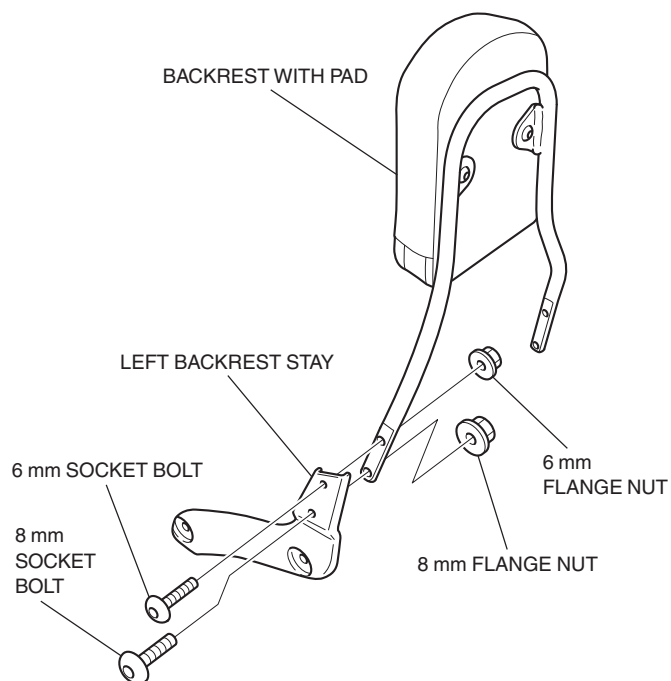

2. Loosely install the backrest as shown.

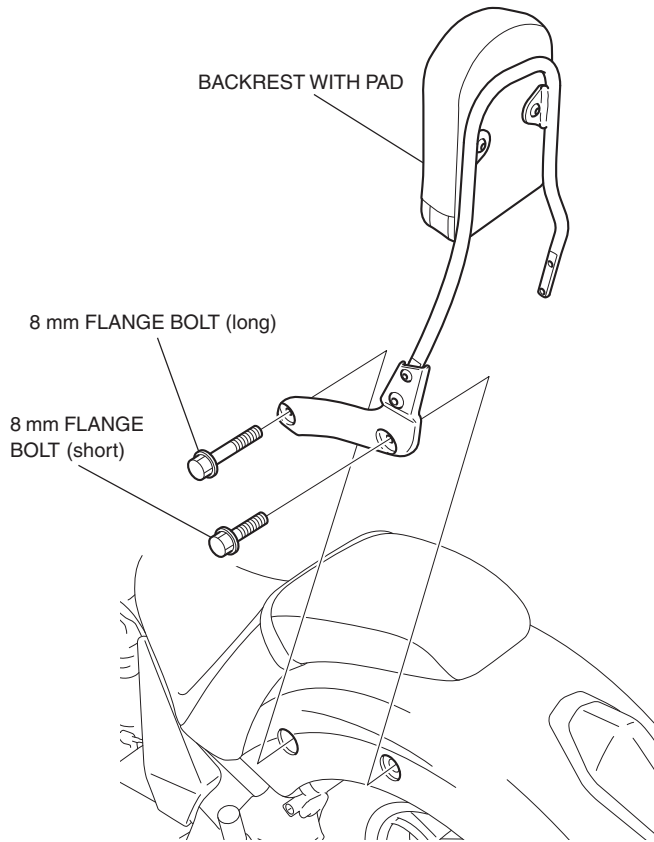

3. Loosely install the right backrest stay as shown.

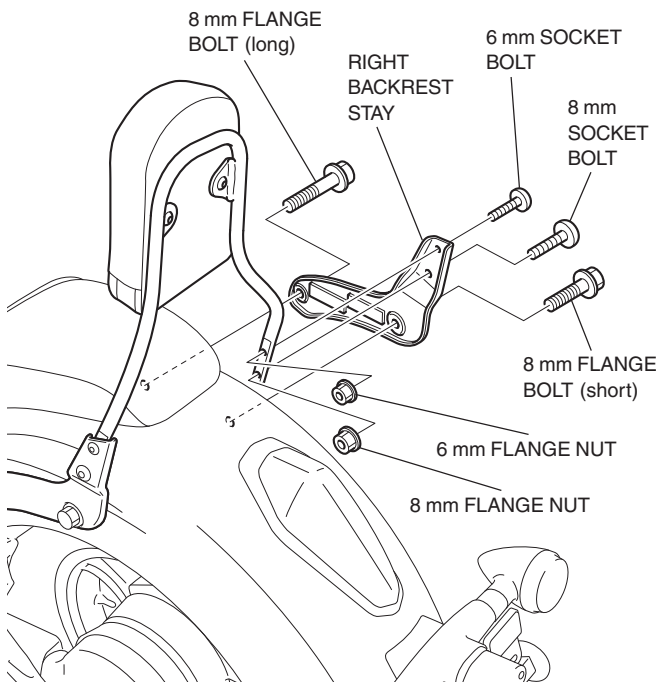

4. Tighten the loosely installed parts to the specifications in the torque chart.

To Install the Rear Carrier

1. Loosely install the left backrest stay as shown.

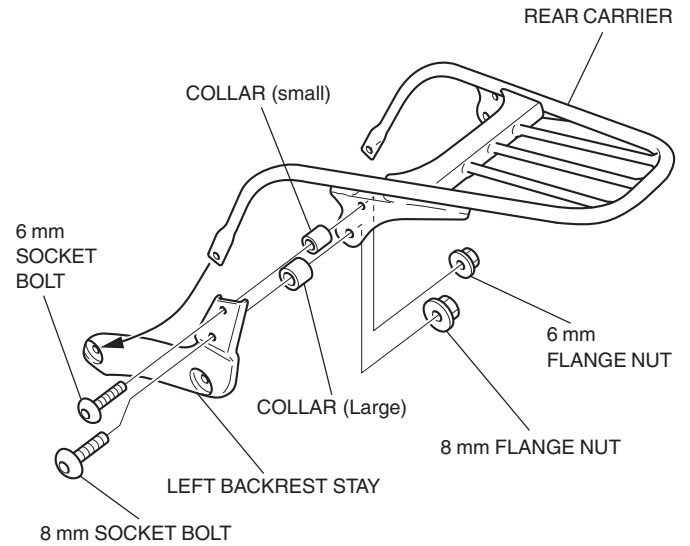

2. Loosely install the rear carrier as shown.

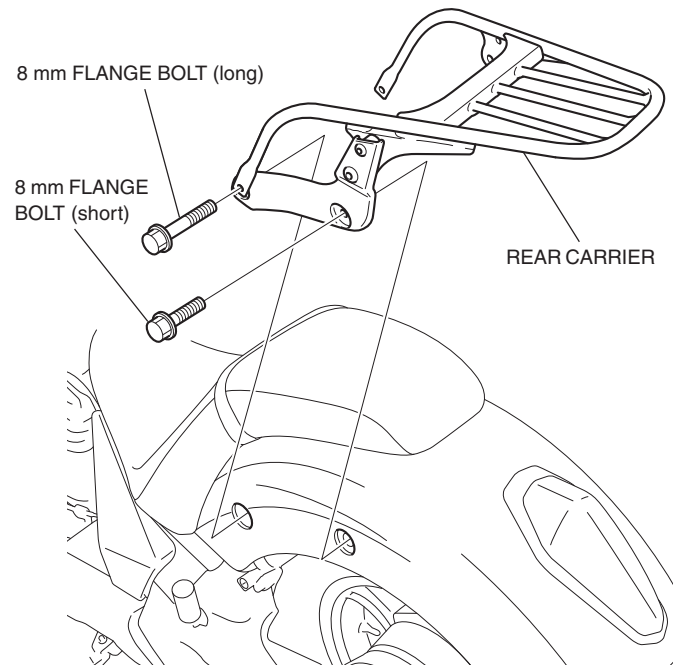

3. Loosely install the right backrest stay as shown.

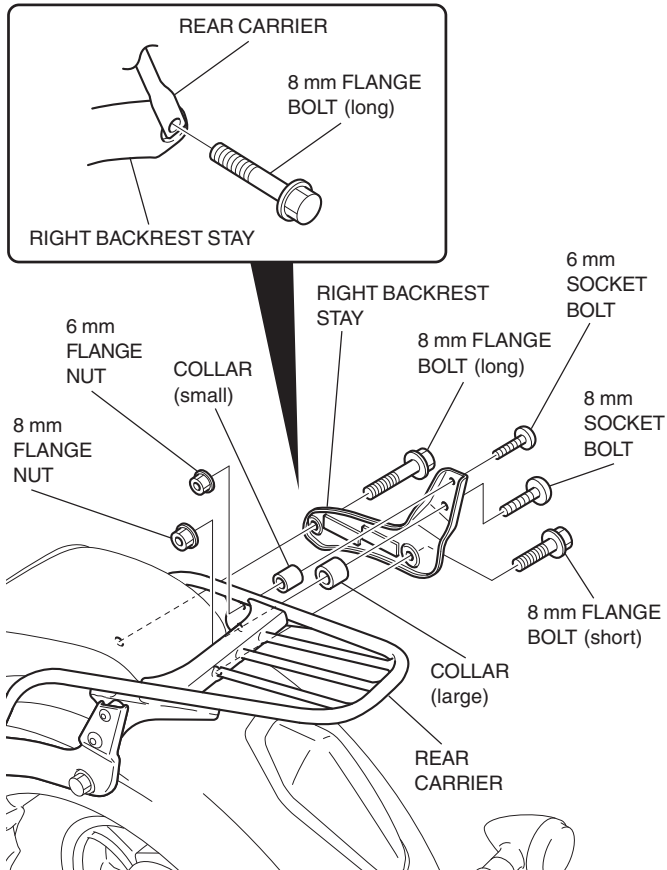

4. Tighten the loosely installed parts to the specifications in the torque chart.

To install the Backrest With Pad and Rear Carrier

1. Loosely install the left backrest stay as shown.

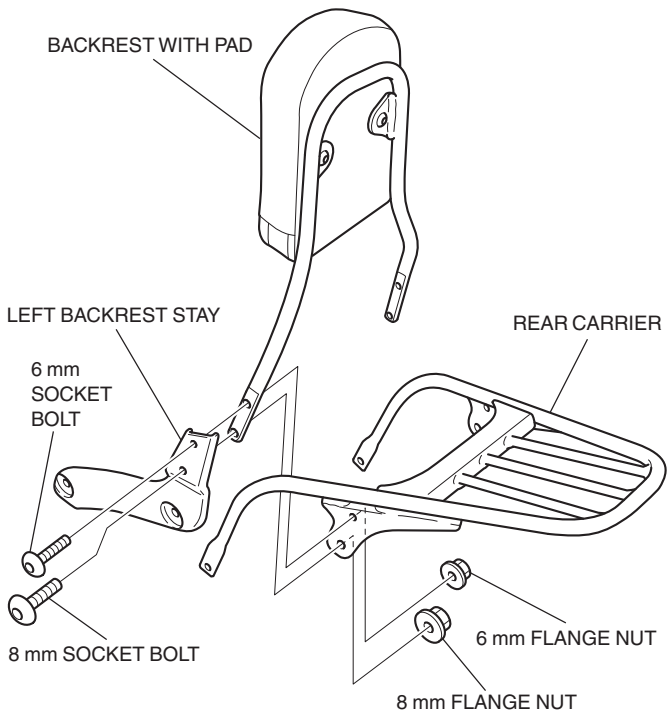

2. Loosely install the backrest with pad and rear carrier as shown.

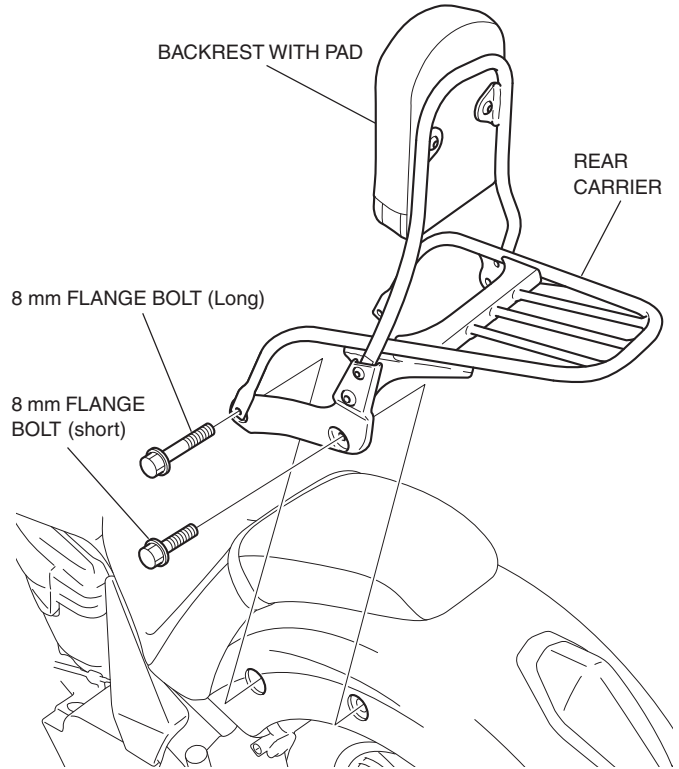

3. Loosely install the right backrest stay as shown.

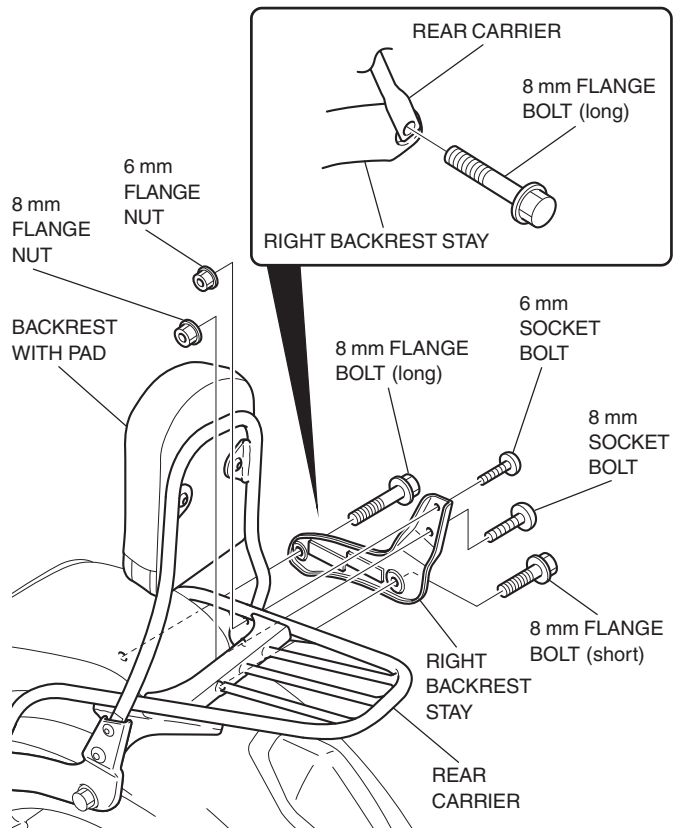

4. Tighten the loosely installed parts to the specifications in the torque chart.