

# HONDA

## INSTALLATION INSTRUCTIONS

Accessory  
**LI-ION BATTERY ATTACHMENT**  
 P/N 08E70-MKF-L00

Application  
**After '16 CBR1000RR**

Publication No.  
**MII 16210**  
 Issue Date  
**April 2017**

**Honda Dealer: Please give a copy of these instructions to your customer.**

### PARTS LIST

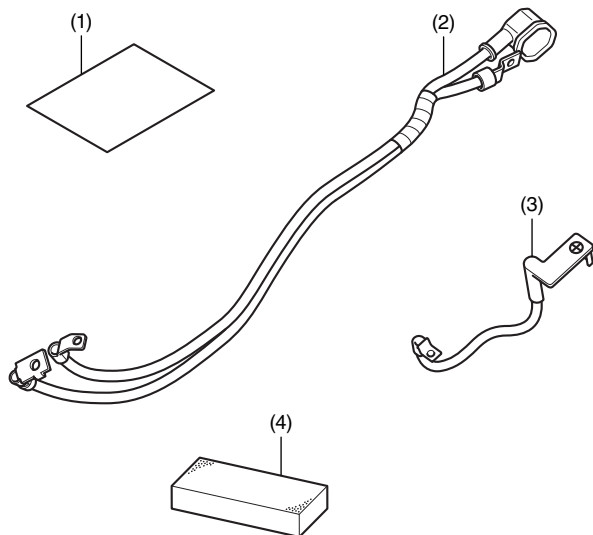

No.	Description	Qty
(1)	Installation Instruction URL	1
(2)	Starter motor and ground cable	1
(3)	Positive (+) battery cable	1
(4)	Battery spacer	1

### HY93 Lithium-Ion Battery

Sold separately

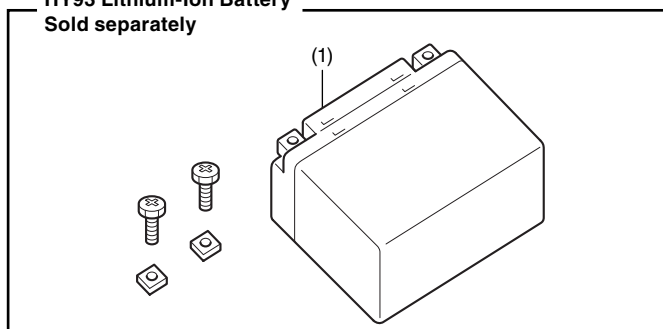

No.	Description	Qty
(1)	Li-Ion Battery	1

### BATTERY CHARGING INFORMATION

Honda Lithium-ion batteries must be charged with a dedicated battery charger approved for LFP (lithium-iron-phosphate) batteries.

#### NOTICE

Charging a Li-ion battery with a conventional lead-acid battery charger will damage the battery.

Use only a charger approved for LFP (lithium-iron-phosphate) batteries.

### Fuel Line Quick Connect Rubber cap and Retainer

Sold separately

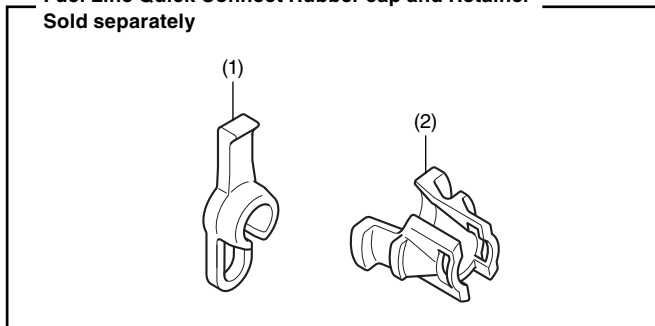

No.	Description	Qty
(1)	Rubber cap	1
(2)	Retainer	1

### TORQUE INFORMATION

Refer to the Service Manual for the torque values of the removed parts.

### INSTALLATION

#### ▲ CAUTION

- To prevent burns, allow the engine, exhaust system, radiator, etc. to cool before installing the accessory.
- Be sure to observe all safety notes and precautions described in the Owner's Manual or Service Manual for removing and installing the fuel tank.

#### NOTE:

- Heat the bonding surfaces with a hair dryer if the ambient air temperature is below 70°F (21°C).
- The adhesive reaches full strength in 72 hours. Wait at least 24 hours before riding your motorcycle.
- Take care not to damage the painted surfaces of the motorcycle.
- Disconnect the negative (-) cable from the battery before installing this accessory.
- The memory of the clock and calendar will be erased when you disconnect the battery. After reconnecting the battery, refer to the motorcycle Owner's Manual and reset the meter.
- After this accessory installation, check the lights (e.g. right/left turn signal lights and brake lights) for proper operation.
- Save all removed parts unless otherwise indicated.

1. Remove the rider seat as shown.

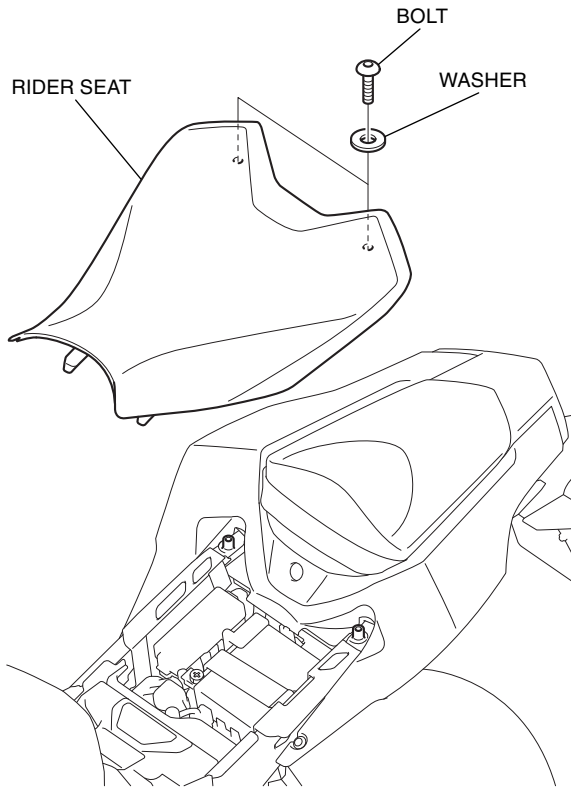

2. Refer to the Service Manual for the motorcycle, remove the top shelter and IMU cover.

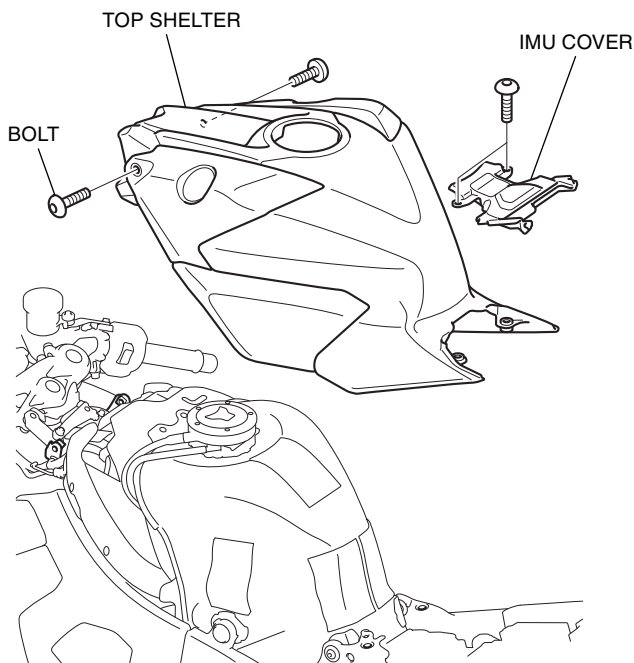

3. Refer to the Service Manual for the motorcycle, remove the EVAP cover (if equipped).

<EVAP (Evaporative Emission) canister equipped type>

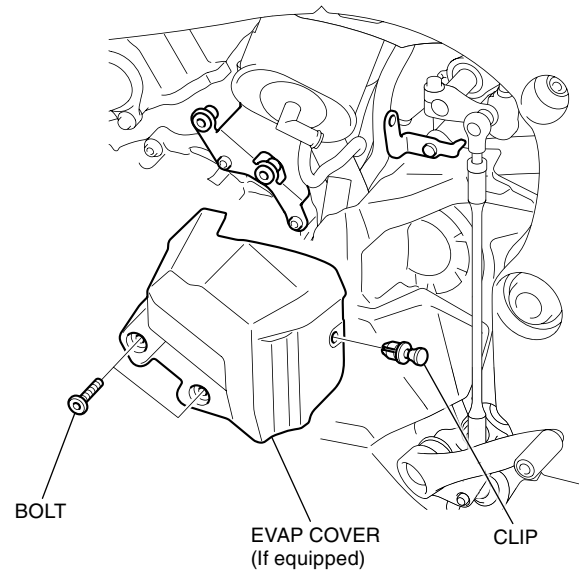

4. Refer to the Service Manual for the motorcycle, remove the battery.

- **Disconnect the negative (-) cable first and then disconnect the positive (+) cable by removing the terminal bolts.**

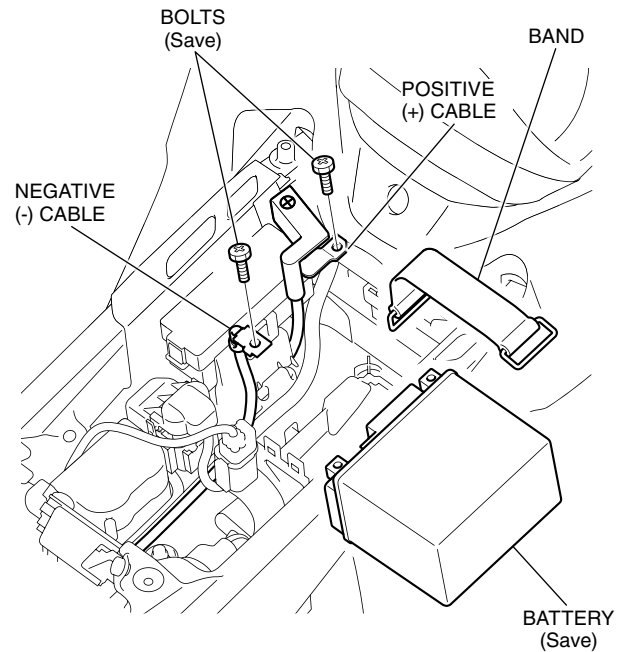

5. Refer to the Service Manual for the motorcycle, remove the positive (+) battery cable, starter relay switch, and starter motor cable.

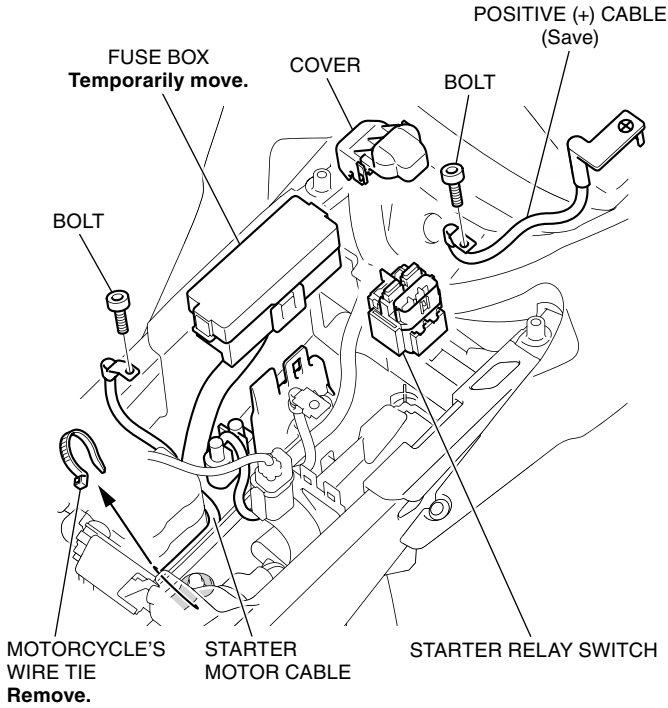

6. Refer to the Service Manual for the motorcycle, remove the EGCA assembly.

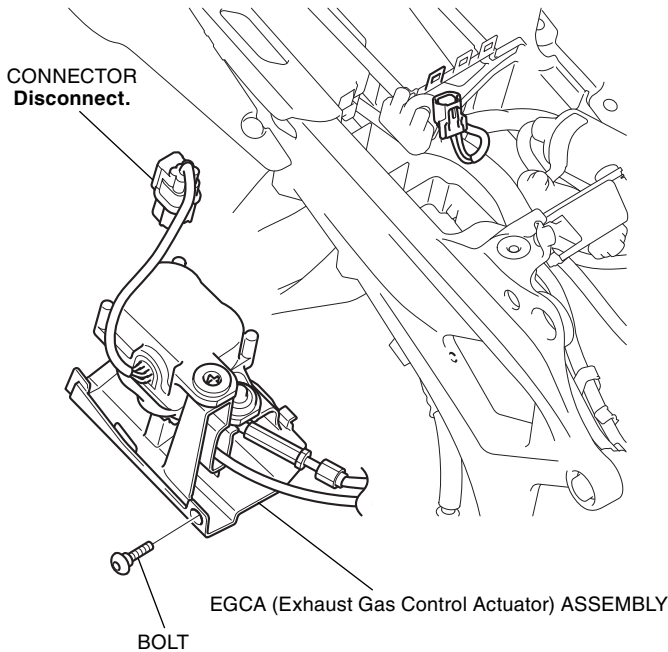

7. Refer to the Service Manual for the motorcycle, remove the motorcycle parts shown.

- **Relieve the fuel pressure.**

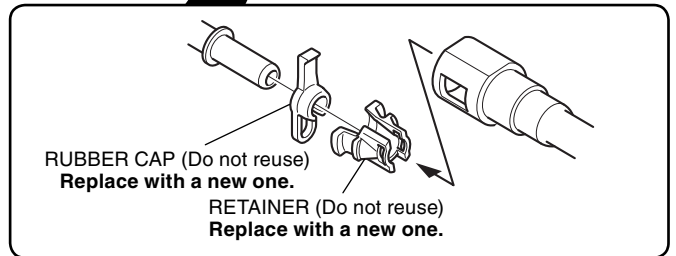
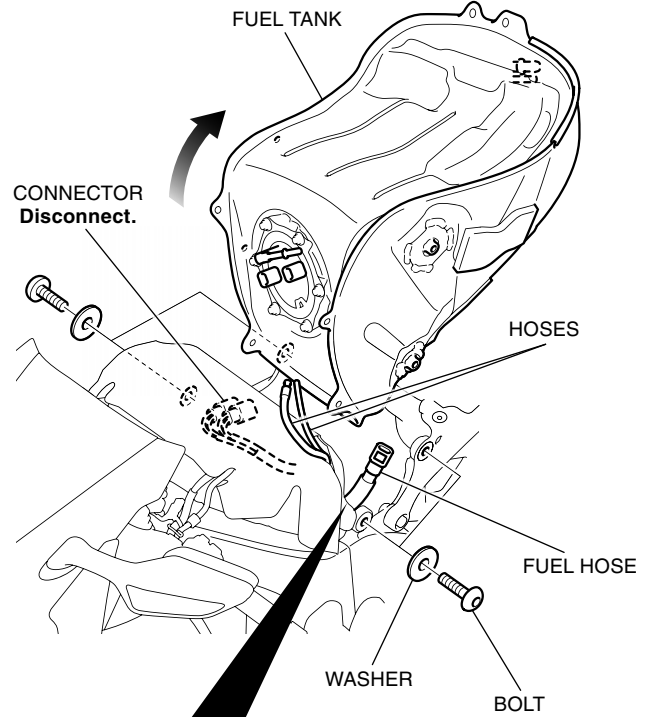

8. Refer to the Service Manual for the motorcycle, remove the EVAP canister (if equipped).

<EVAP (Evaporative Emission) canister equipped type>

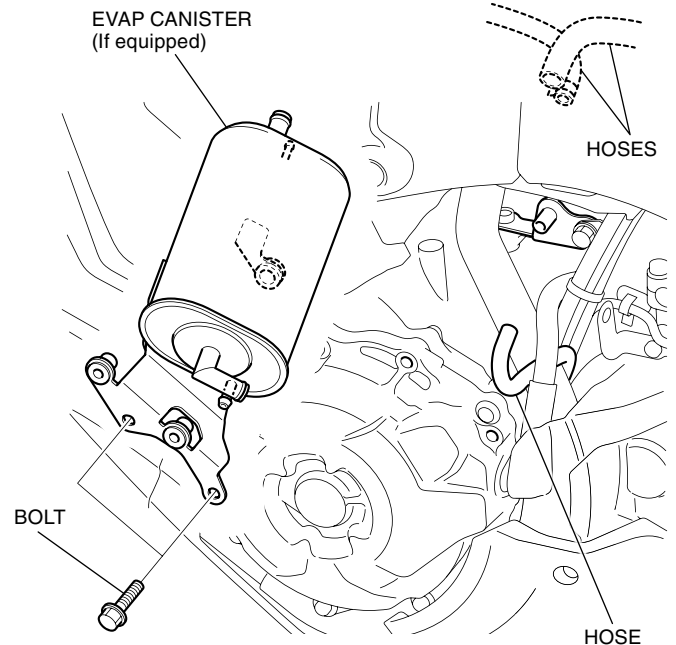

9. Refer to the Service Manual for the motorcycle, remove the starter motor and ground cables.

<EVAP (Evaporative Emission) canister equipped type>

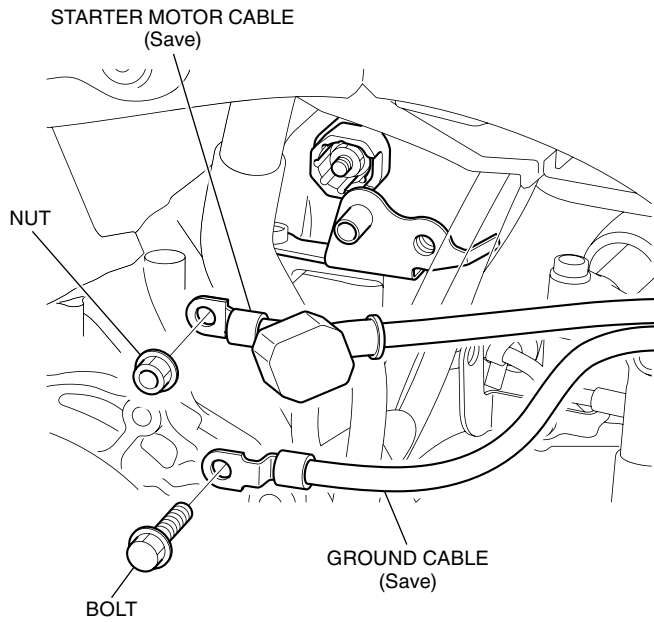

<Non EVAP (Evaporative Emission) equipped type>

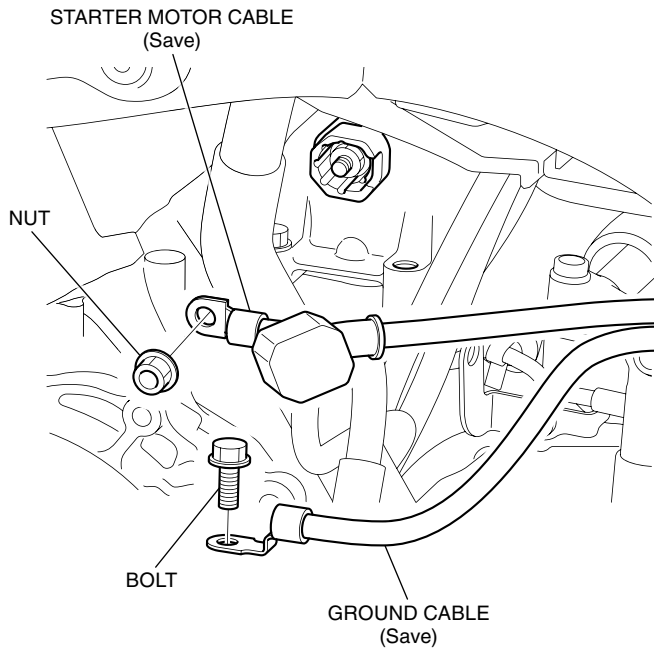

10. Connect the accessory starter motor cable and ground cable as shown.

<EVAP (Evaporative Emission) canister equipped type>

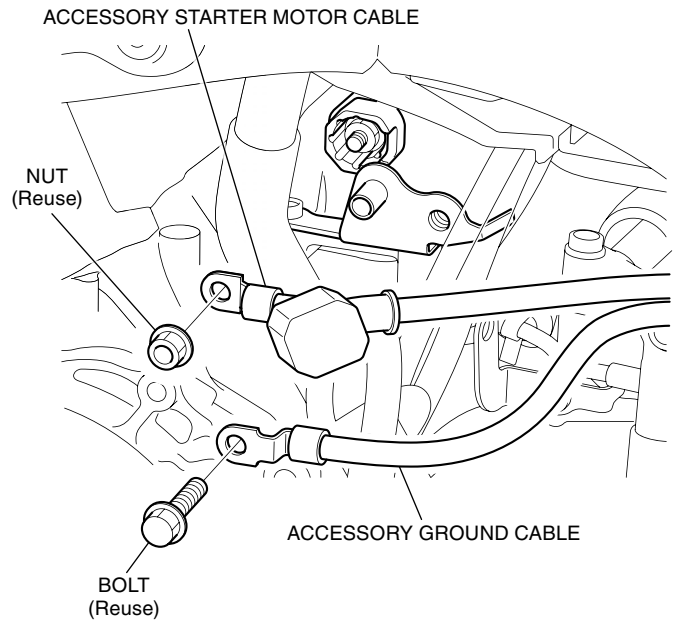

<Non EVAP (Evaporative Emission) equipped type>

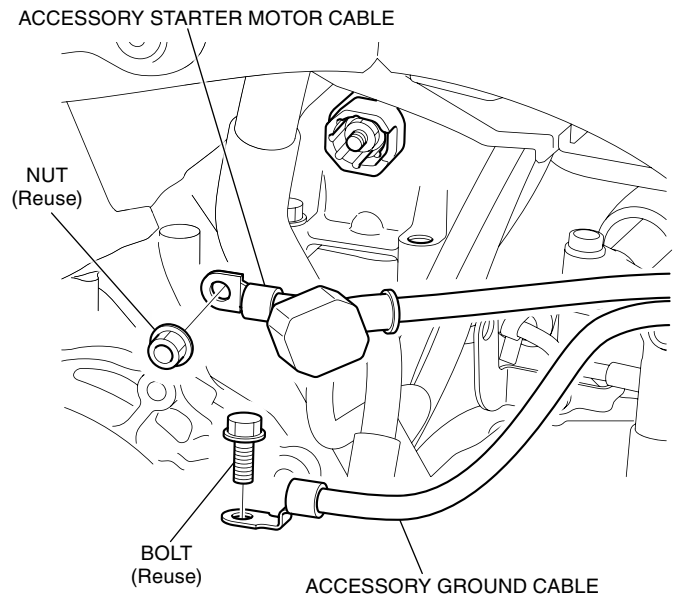

11. Route the accessory starter motor cable and ground cable as shown.

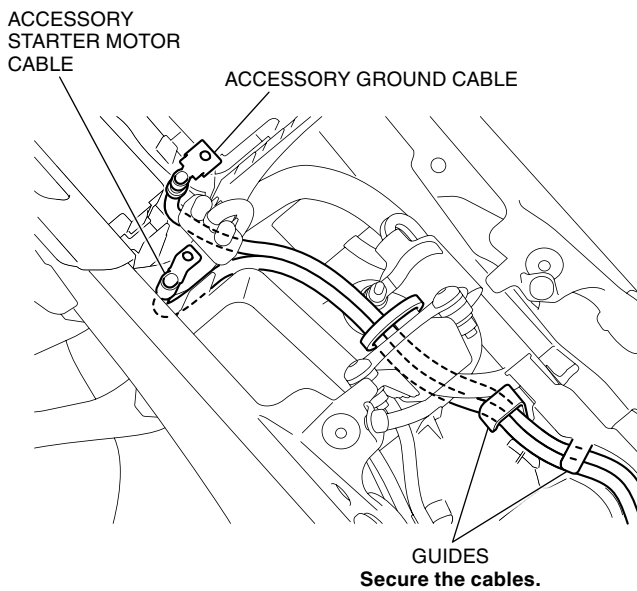
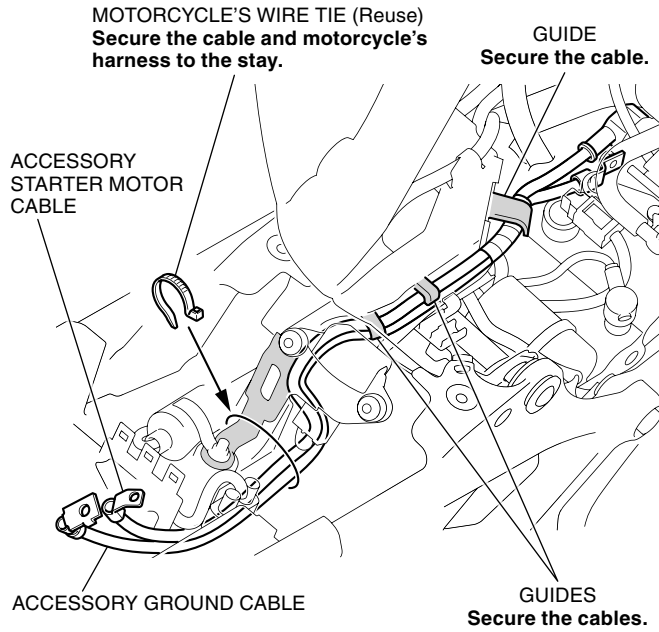

12. Connect the accessory starter motor cable to the starter relay switch as shown.

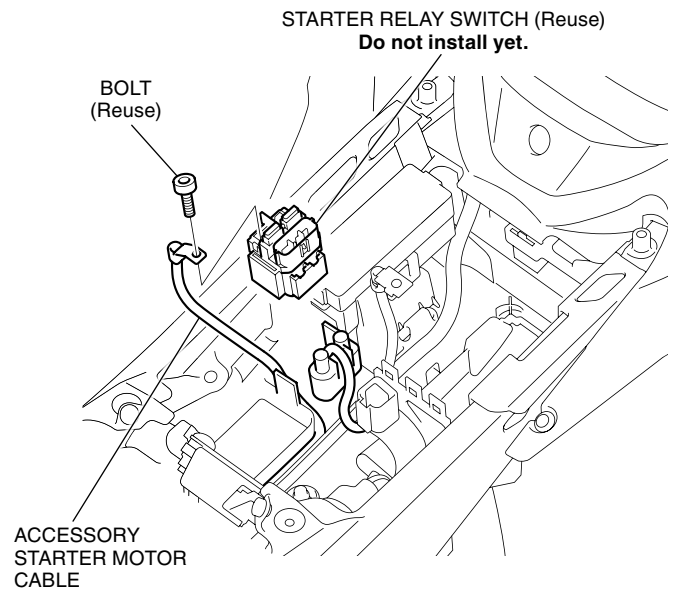

13. Connect the accessory positive (+) cable to the starter relay switch as shown.

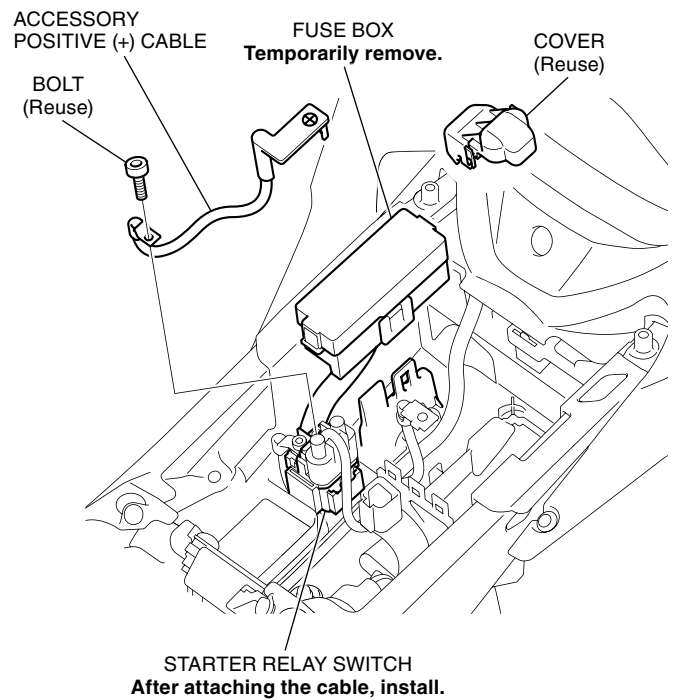

14. Install the battery spacer as shown.

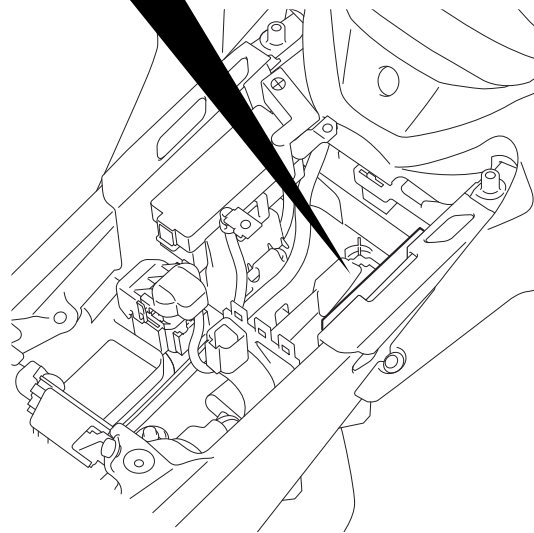
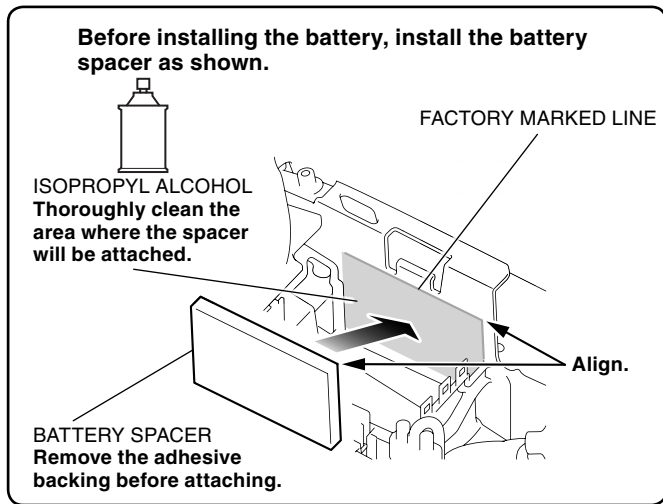

15. Install the lithium-ion battery as shown.

- **Connect the positive (+) cable first and then connect the negative (-) cable by installing the terminal bolts.**

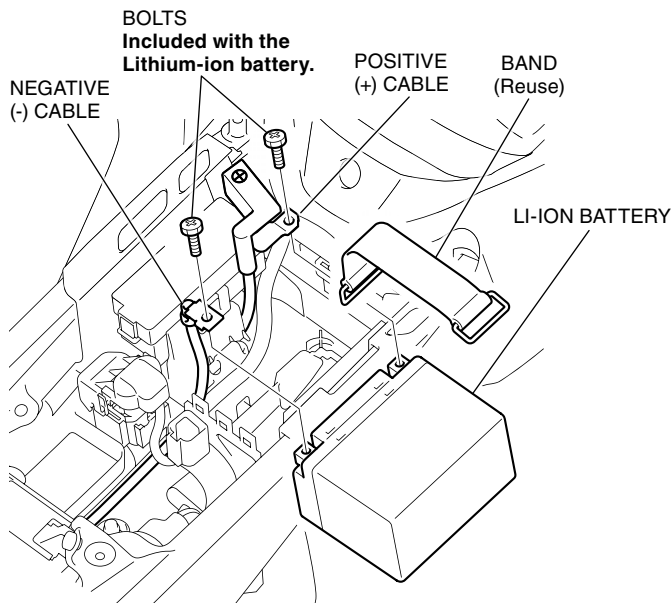

16. Install the removed motorcycle parts in the reverse order of removal.

- **Confirm that the wire harness is not caught or too tight.**