



Honda CBR650F / CB650F
Radiator Guard

Installation Instructions

Kit Contents PRN013925

- Ⓐ 2 x Rubber Bungs
- Ⓑ 4 x M5 Black Washers
- Ⓒ 4 x M5 x 8 Black Button Head Bolts
- Ⓓ 12 x Rubber Pads

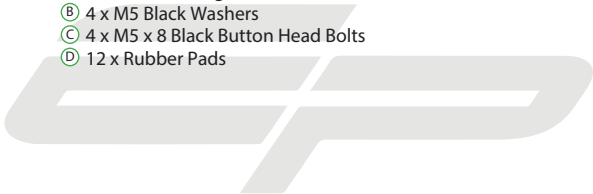

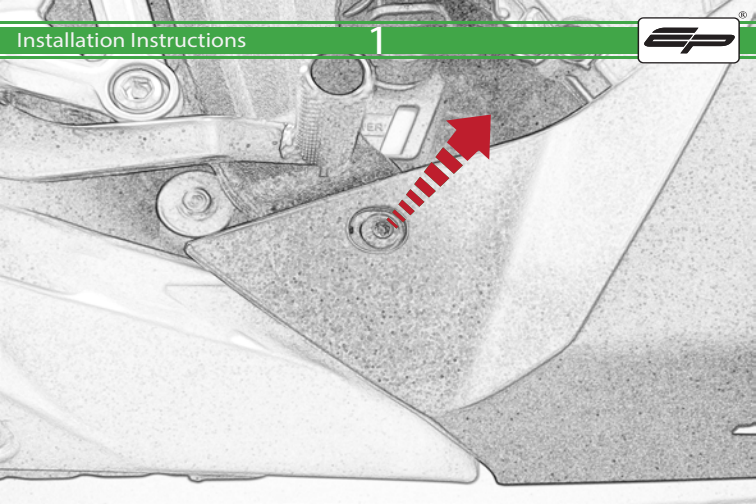

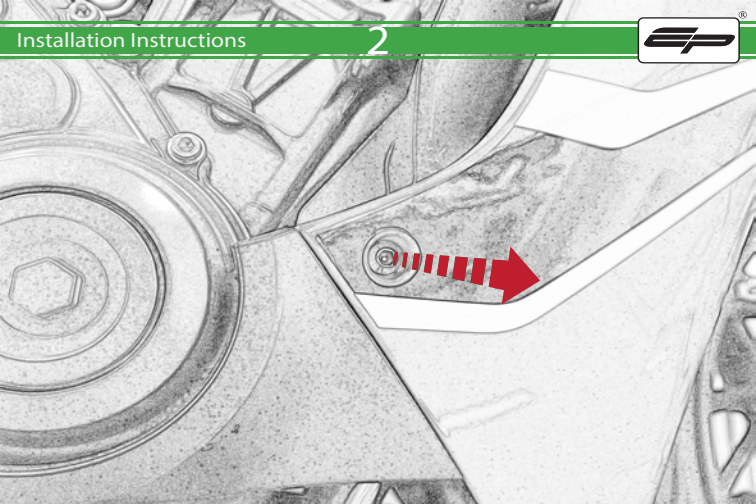

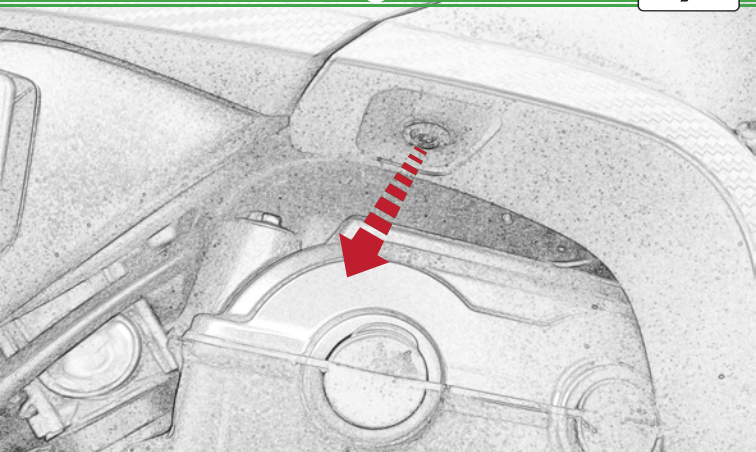

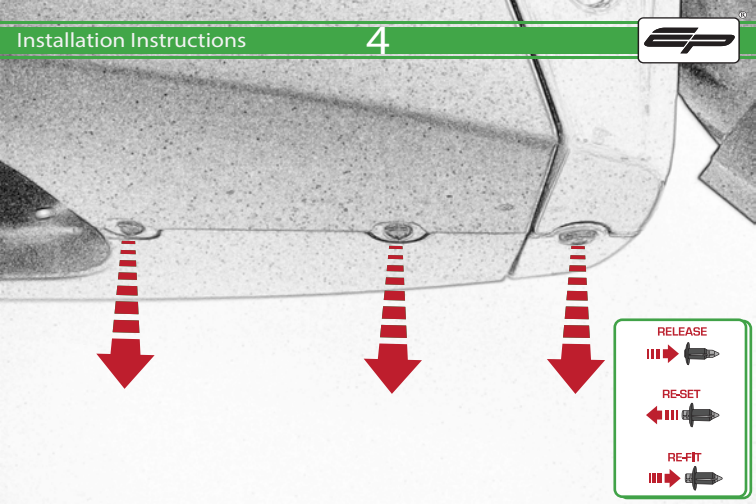



RELEASE



RE-SET



RE-FIT



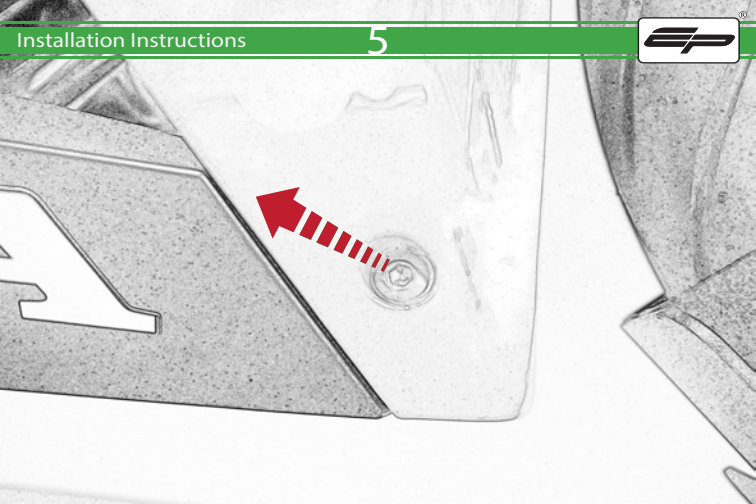

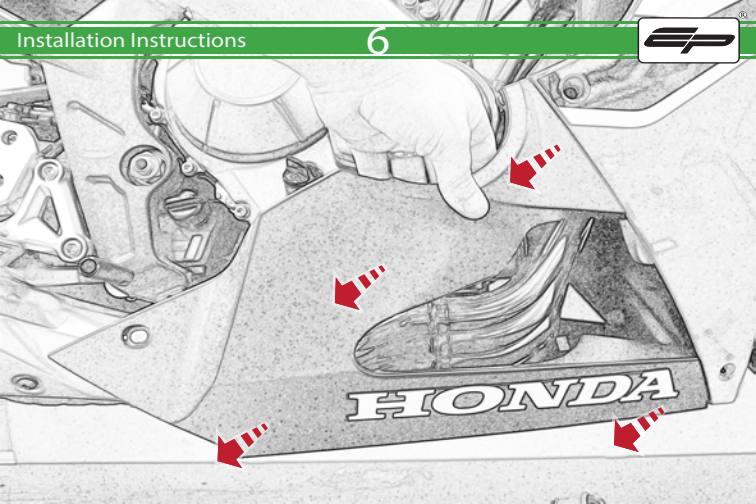

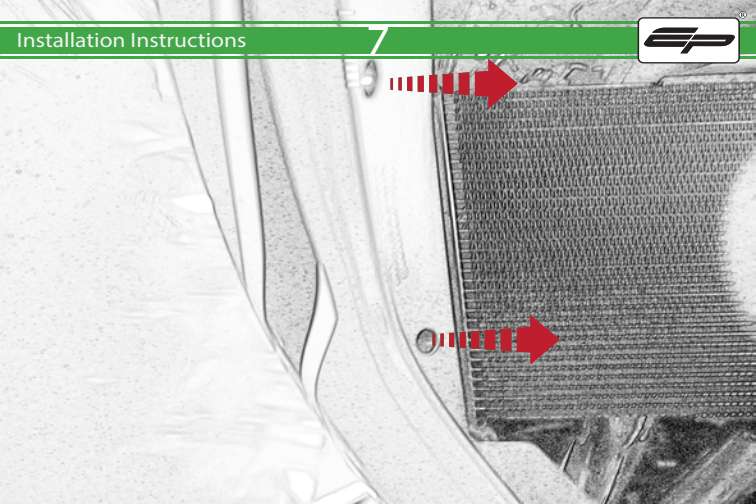



RELEASE



RE-SET



RE-FIT







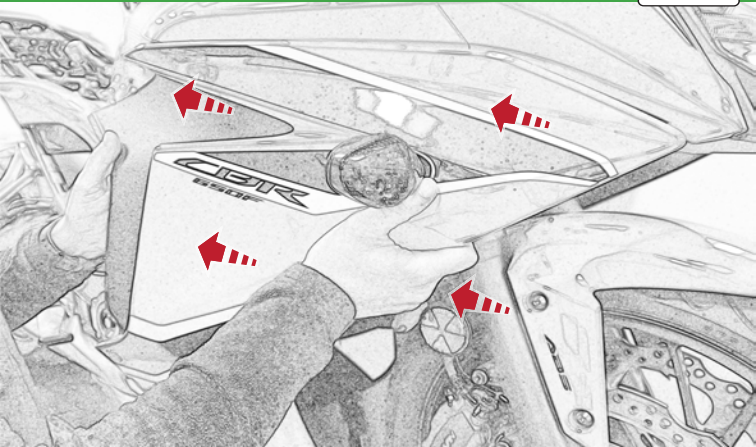

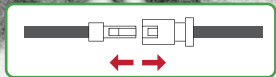

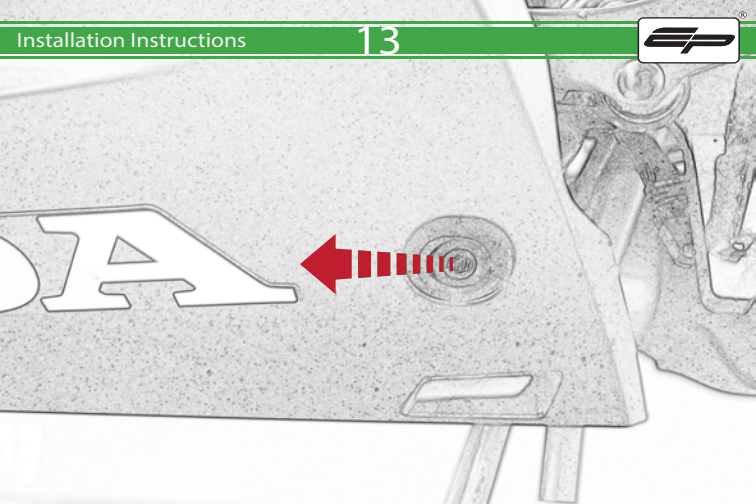



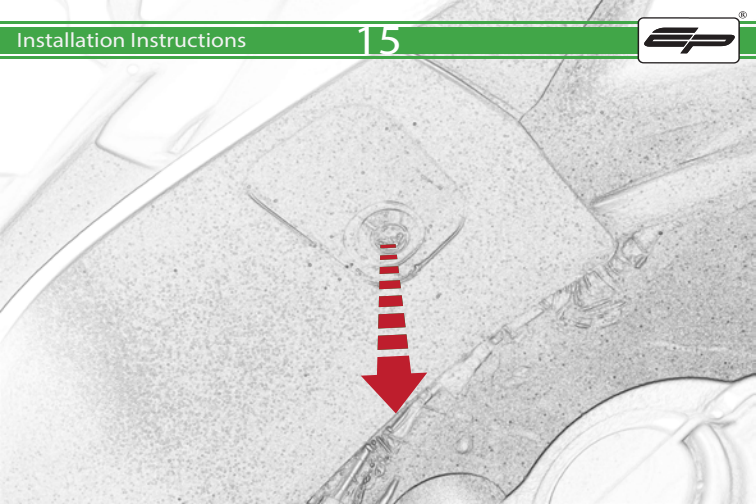



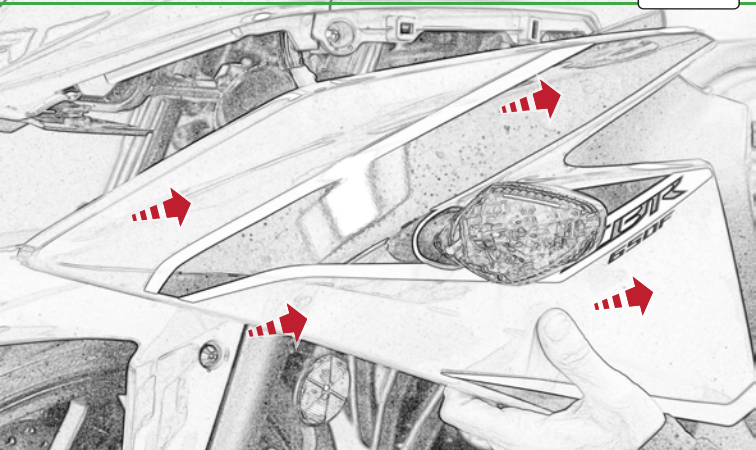

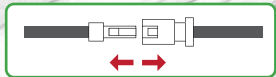
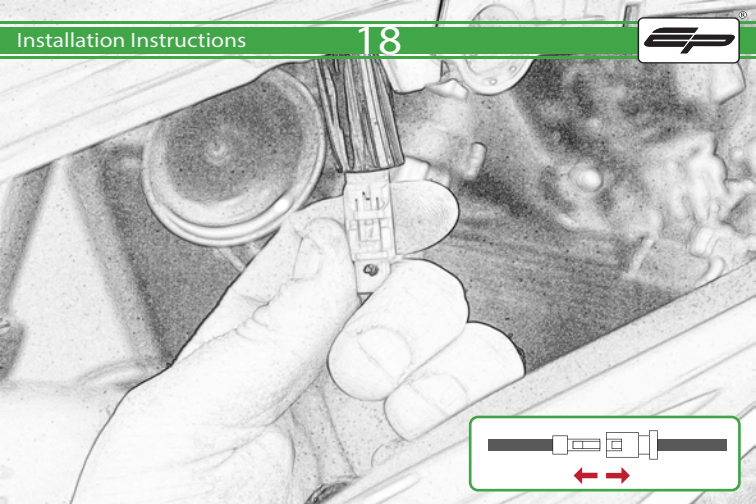

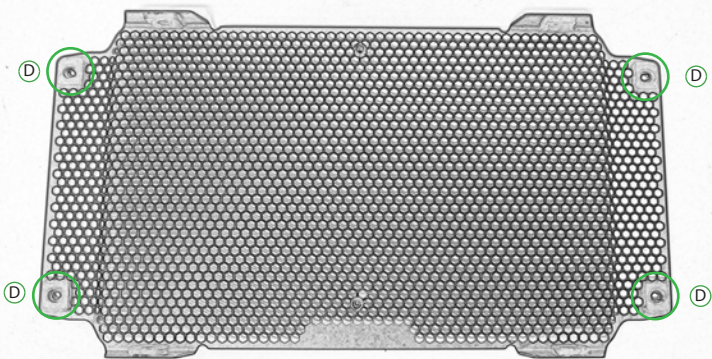

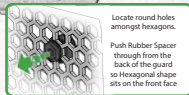
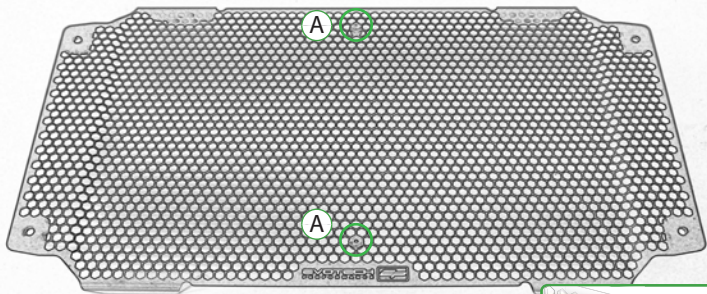

Locate round holes amongst hexagons.

Push Rubber Spacer through from the back of the guard so Hexagonal shape sits on the front face

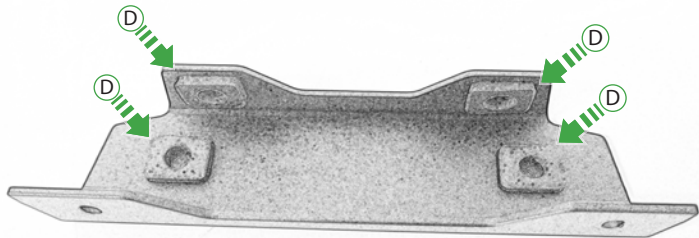

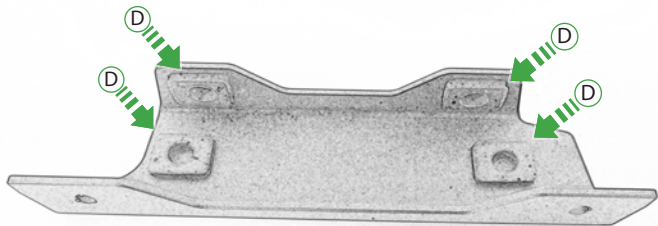

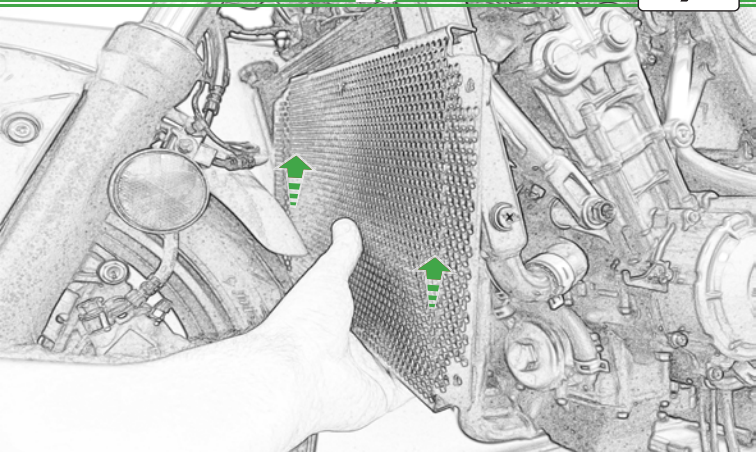

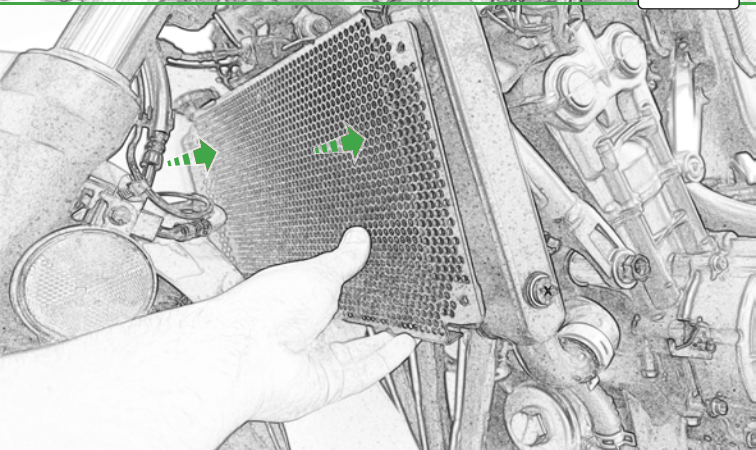



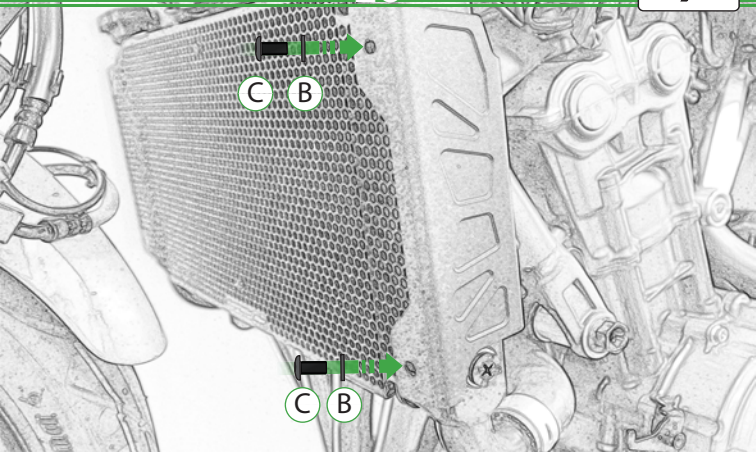

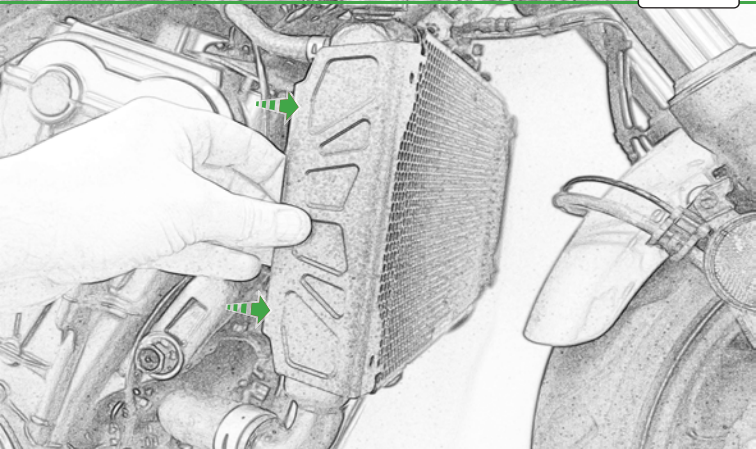

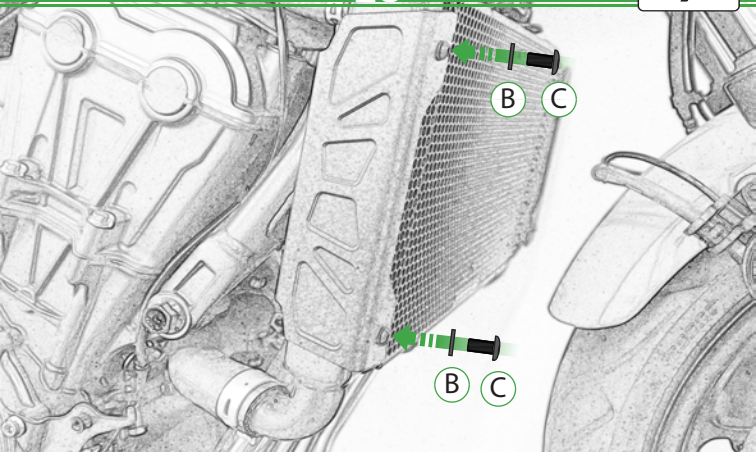



ESSENTIAL CHECKS

It is recommended that periodic inspections are made to ensure that dirt and debris have not become trapped between the guard and the radiator/oil cooler. Such dirt and debris would reduce the cooling efficiency of the radiator/oil cooler.

It is recommended that periodic inspections are made to ensure that all fixings are fully tightend.



EVOTECH®
P E R F O R M A N C E

www.evotech-performance.com