

# HONDA

## INSTALLATION INSTRUCTIONS

Accessory

QUICK SHIFTER  
P/N 08U70-MJM-D10  
08U70-MJM-D11

Application

VFR800F/FD

Publication No.

MII 15026

Issue Date

June 2013

### PARTS LIST

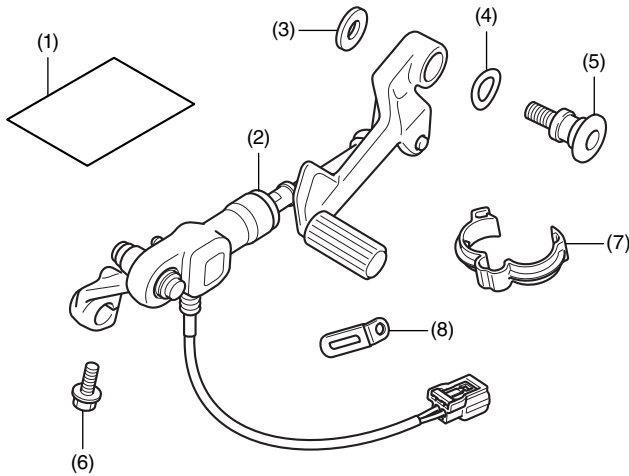

No.	Description	Qty
(1)	Installation Instruction URL	1
(2)	Gear change pedal	1
(3)	Washer	1
(4)	Wave washer	1
(5)	Pivot bolt	1
(6)	6 mm flange bolt	1
(7)	Clip	1
(8)	Clamp	1

### TOOLS AND SUPPLIES REQUIRED

Socket (10 mm)

Ratchet

Open-end wrench (10 mm)

Hex wrench (8 mm)

Marker

Ruler

Grease

Torque wrench

### TORQUE CHART

Tighten all screws, bolts, and nuts to their specified torque values. Refer to the Service Manual for the torque values of the removed parts.

Item	N·m	kgf·m	lbf·ft
6 mm flange bolt	12	1.2	9
Pivot bolt	27	2.8	20

### INSTALLATION

#### ▲ CAUTION

- To prevent burns, allow the engine, exhaust system, radiator, etc., to cool before installing the accessory.

#### NOTE:

- Disconnect the negative (-) cable from the battery before installing this accessory.
- The clock memory will be erased when you disconnect the battery. Reset the clock after reconnecting the battery.
- Reinstall the removed parts on the motorcycle and make sure that the wires and harnesses are not pinched.

- Remove the main seat and passenger seat as shown.

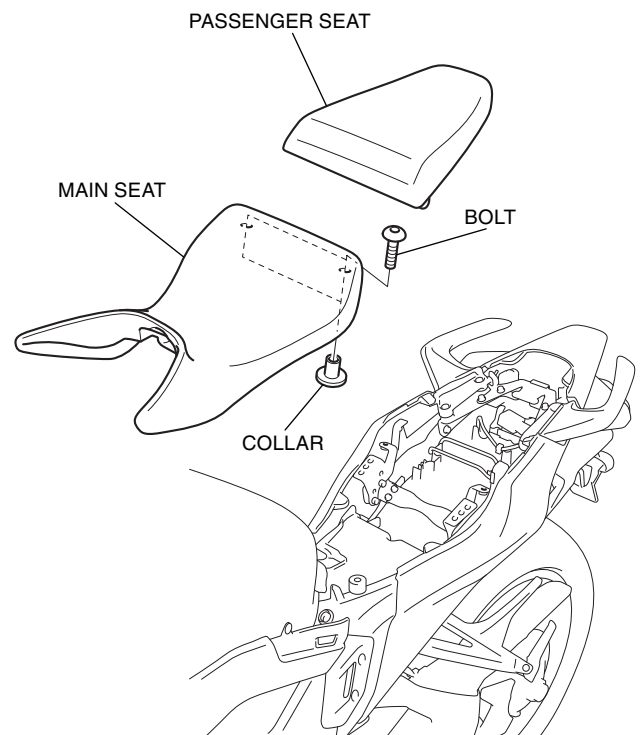

2. Remove the battery cover, and disconnect the negative (-) terminal of the battery as shown.

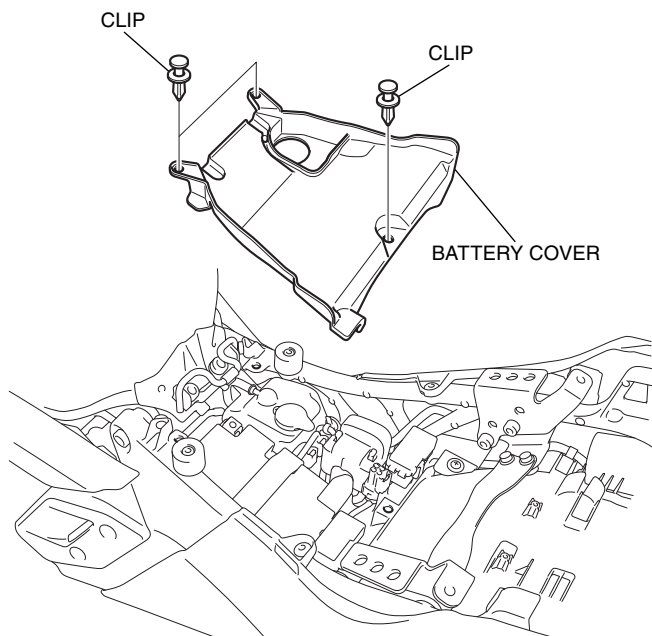

3. Remove the indicated clips from the left inner lower panel.

<Left side>

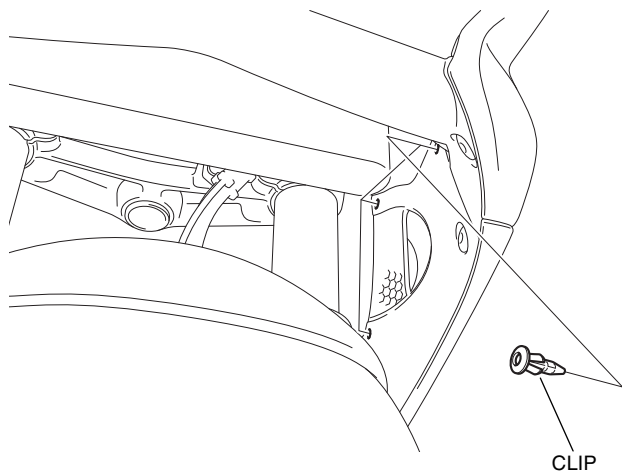

4. Remove the bolt from the inner upper panel as shown.

<Left side>

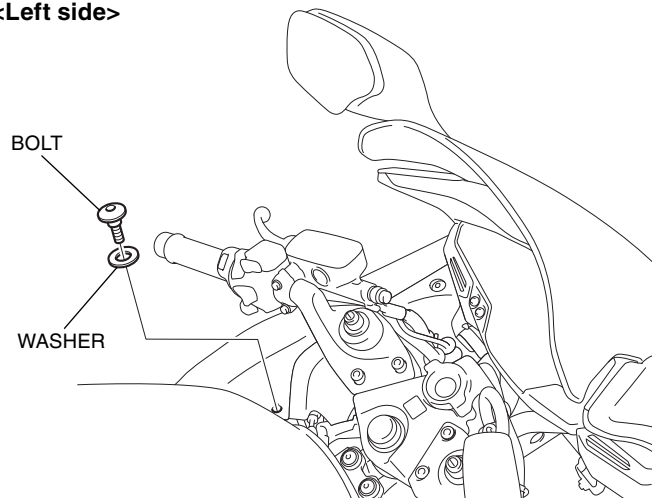

5. Remove the clips as shown.

<Under side>

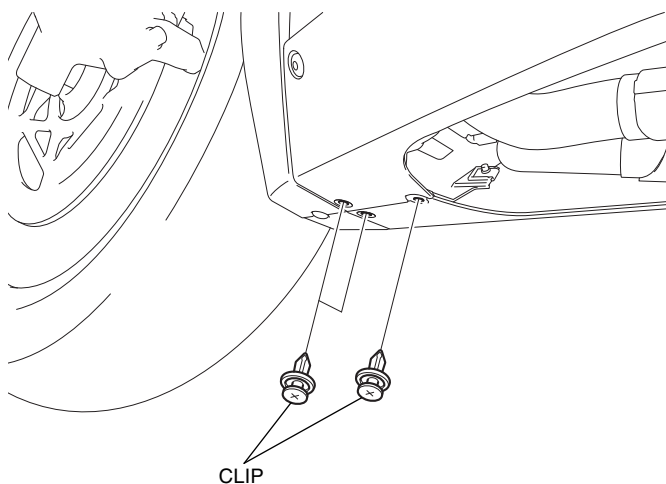

6. Remove the left under cowl as shown.

<Left side>

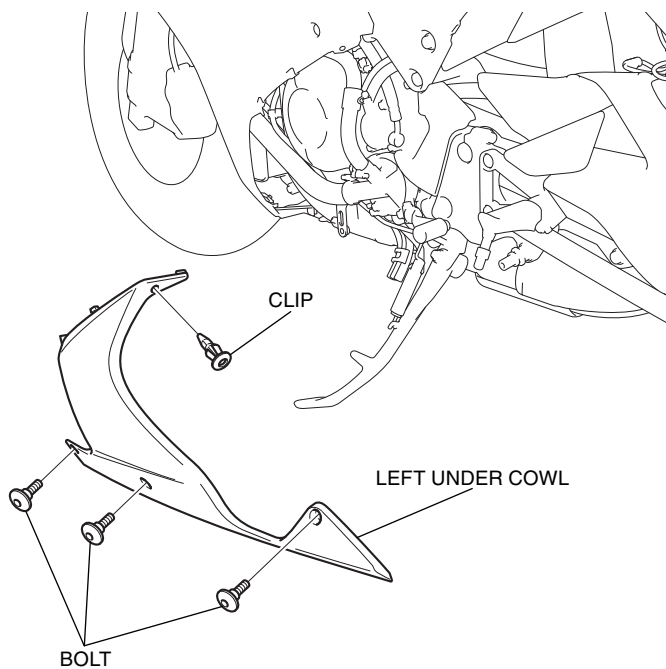

7. Remove the clip and bolt as shown.

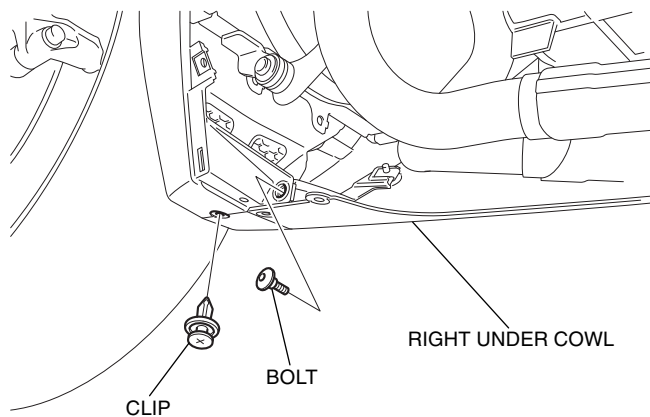

8. Remove the bolts and clips as shown.

<Left side>

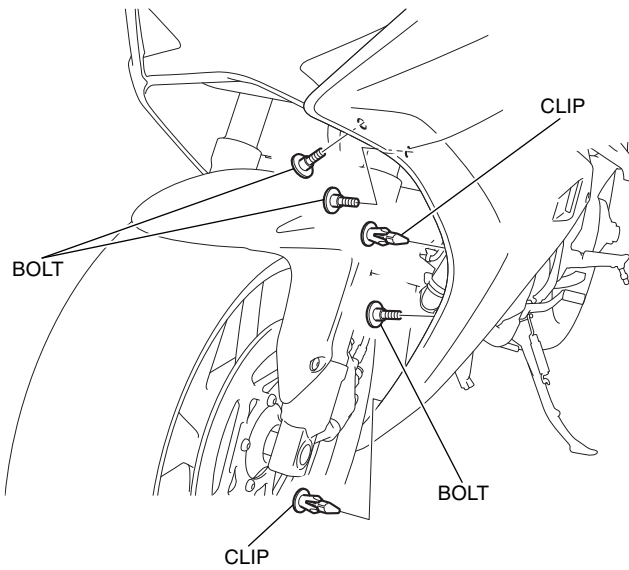

9. Remove the left inner lower cowl and left middle cowl as shown.

<Left side>

LEFT INNER LOWER COWL

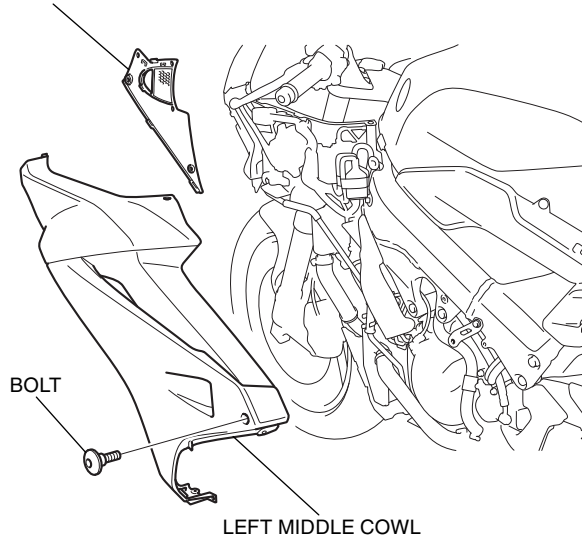

10. Turn up the rubber flap and remove the dummy connector as shown.

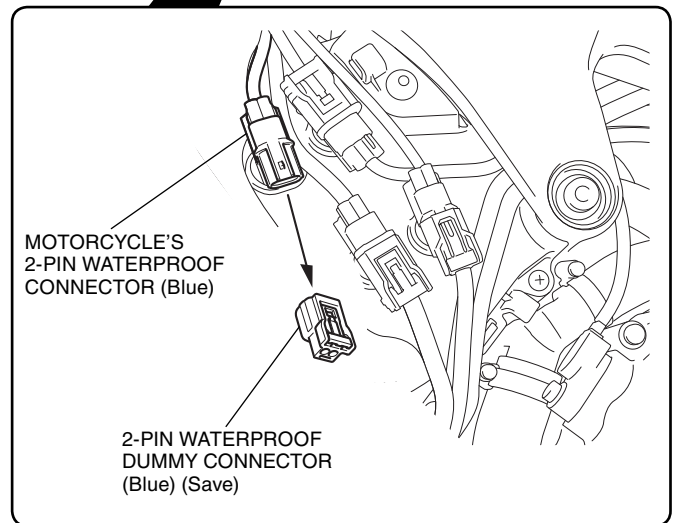
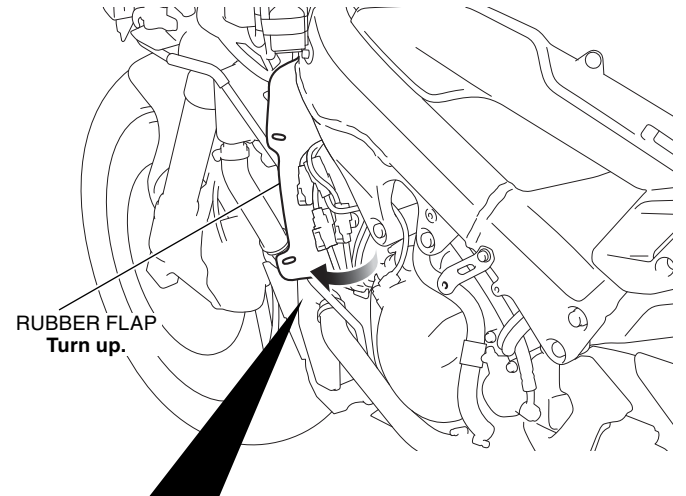

11. Remove the shift pedal as shown.

<Left side>

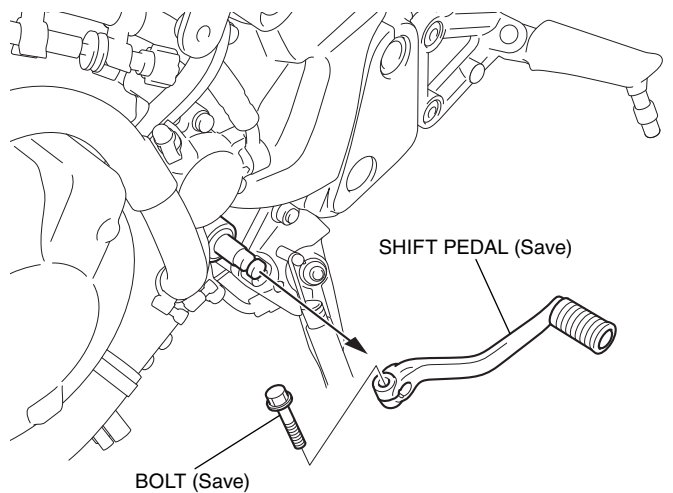

12. Remove the clip as shown.

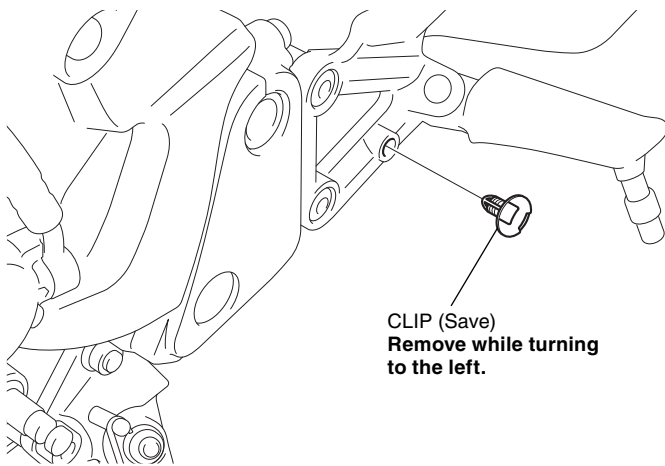

13. Mark the gear change pedal harness in the positions shown.

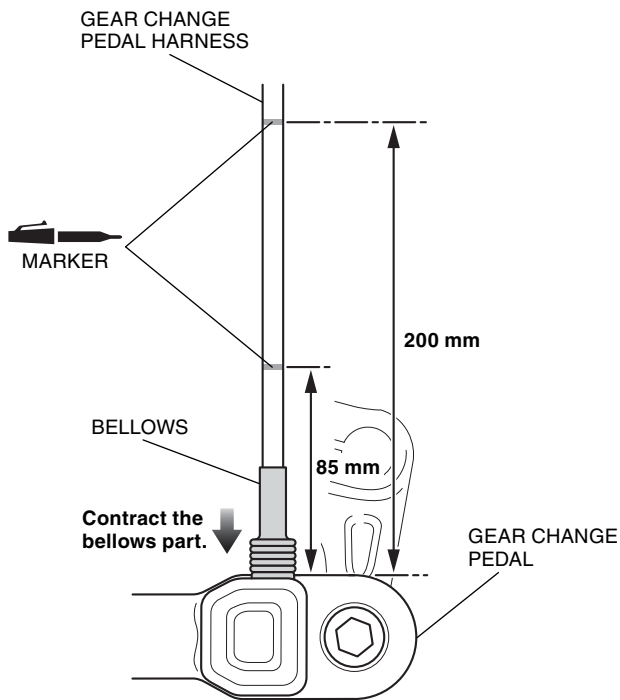

14. Remove the indicated bolt.

<Left side>

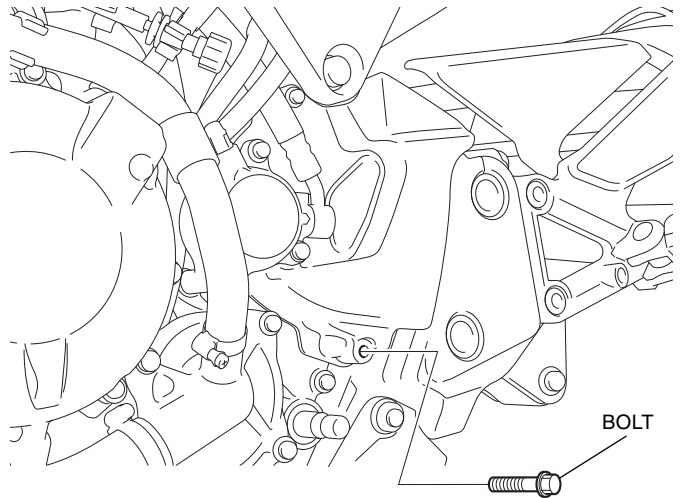

15. Install the clamp as shown.

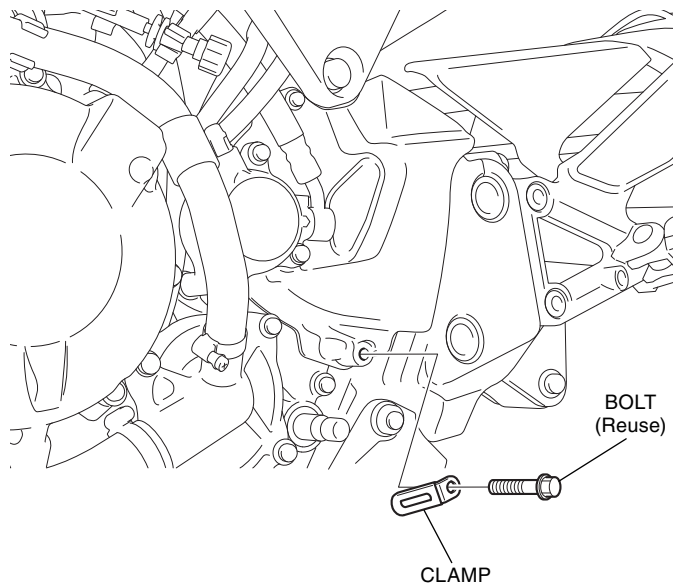

16. Install the accessory gear change pedal as shown.

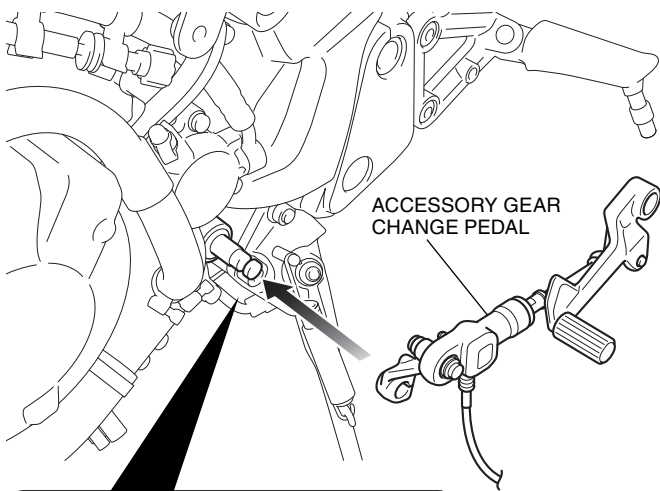

Position the arm as shown.

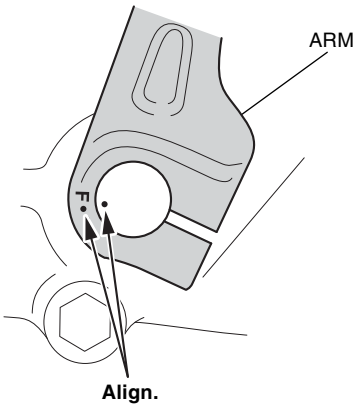

17. Secure the gear change pedal as shown.

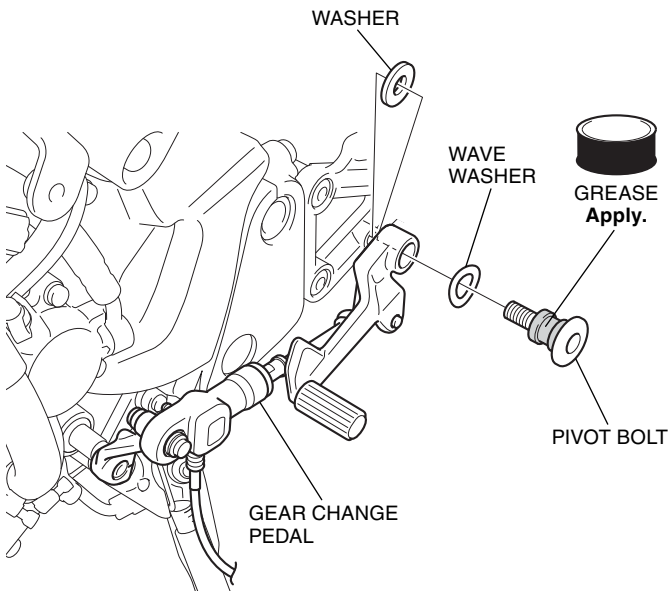

18. Install the 6 mm flange bolt as shown.

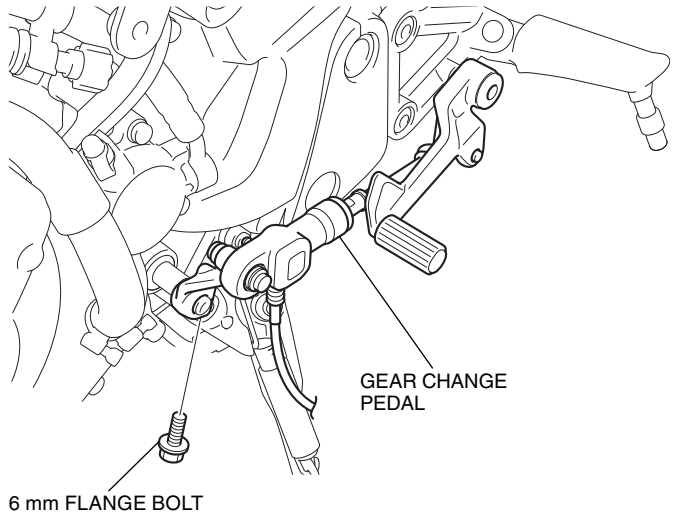

19. Route the gear change pedal harness as shown.

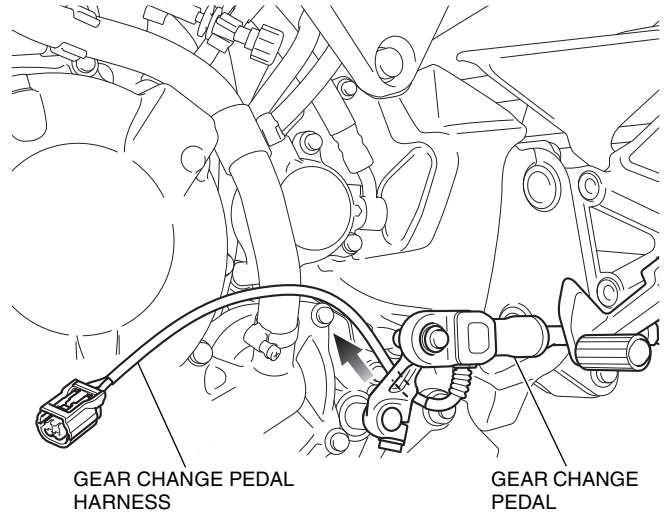

20. Secure the gear change pedal harness with the clamp as shown.

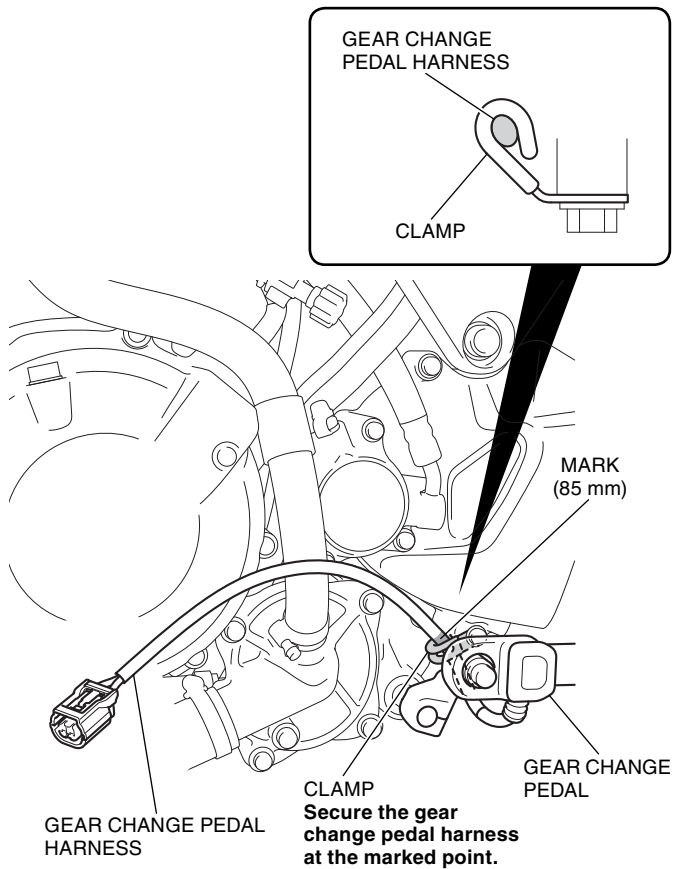

21. Route the gear change pedal harness as shown.

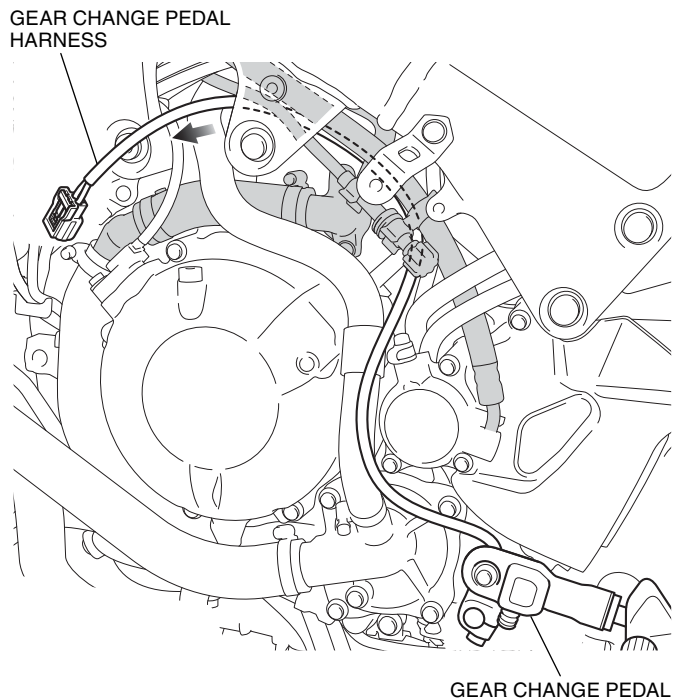

22. Carefully pull out the hose from the stay as shown.

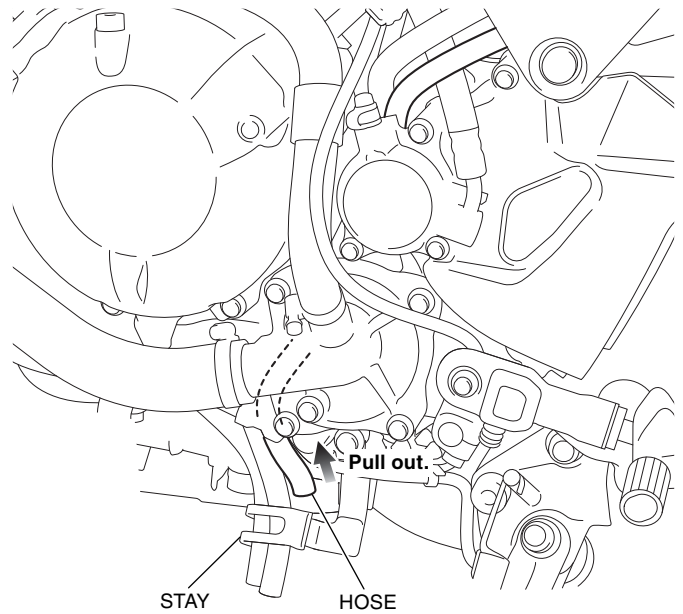

23. Install the clip as shown.

- After installing the clip, return the removed hose to its original position.

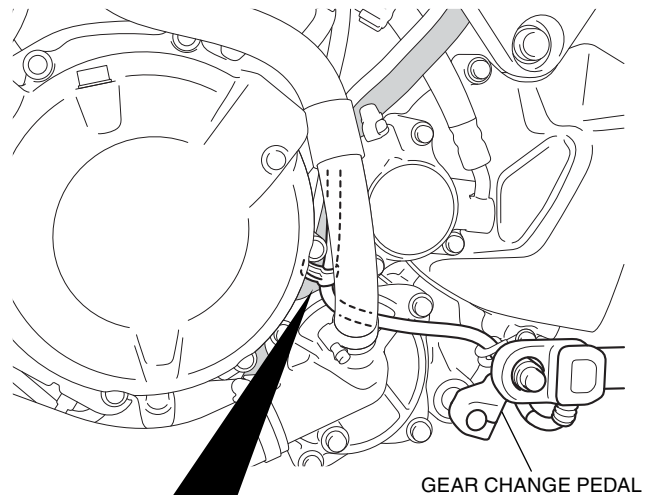

Install the clip to the hose and the gear change pedal harness at the marked point as shown.

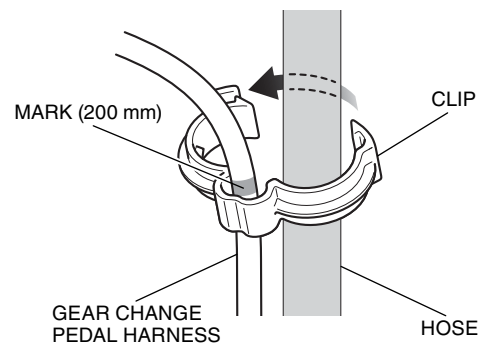

24. Route the gear change pedal harness as shown.

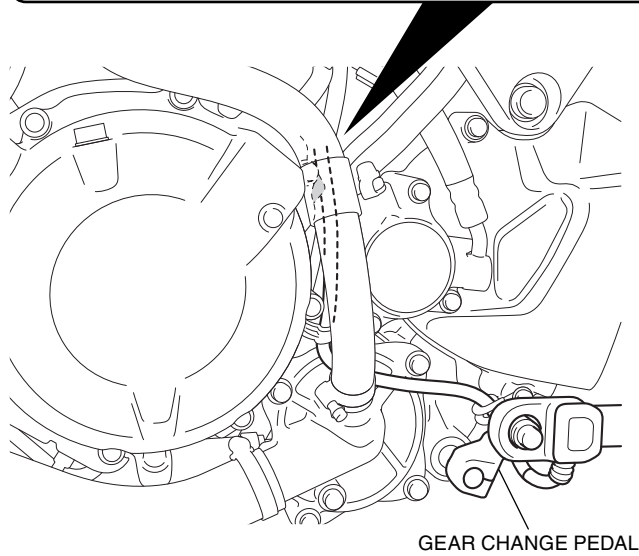
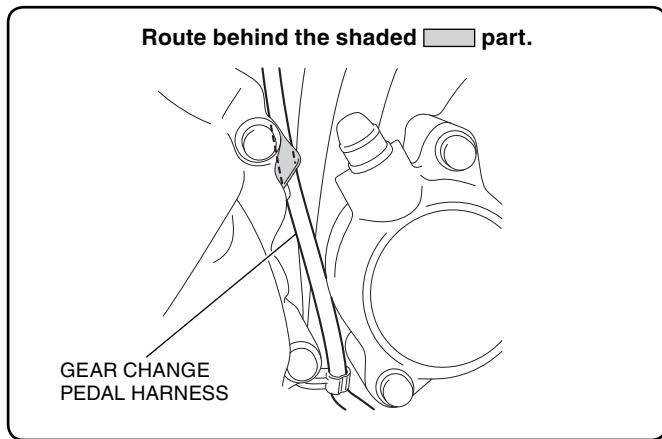

25. Route the gear change pedal harness as shown.

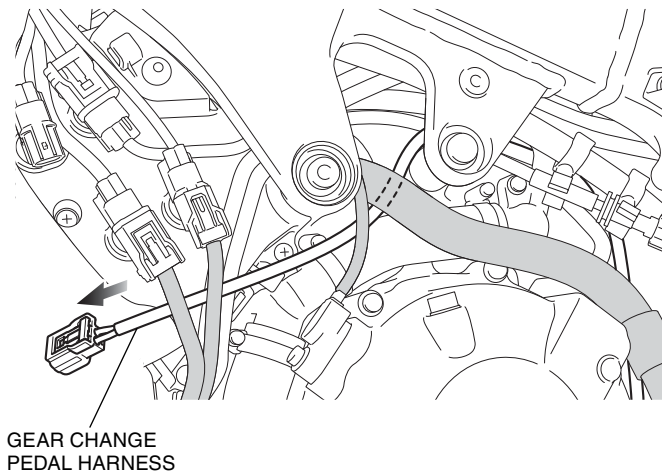

26. Connect the gear change pedal harness as shown.

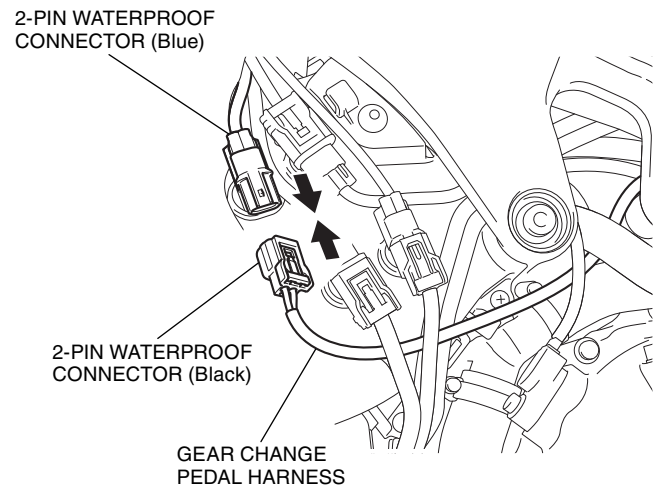

27. Return the rubber flap to its original position.

28. Install the removed parts in the reverse order of removal.

- **Confirm that no wire harness is pinched or too tight.**

29. Check the quick shifter for proper operation.

## OPERATING INSTRUCTIONS

This accessory enables very quick up-shifting without clutch or throttle operations during acceleration (Engine speed is more than 1,500 rpm).

- If the gear position display is abnormal, the shift feeling may change.
- If the accessory quick shifter does not operate normally, the clutch can be used to complete the shift operation.

### <Shift up>

- Up-shift without clutch and throttle operations.

### <Shift down>

- Make sure to operate clutch when down-shifting.

## TROUBLESHOOTING

If you cannot shift up by operating the shift pedal during acceleration (Engine speed is more than 1,500 rpm), a failure may have occurred. Use a test meter and follow the diagnostic procedure below.

