

PARTS LIST

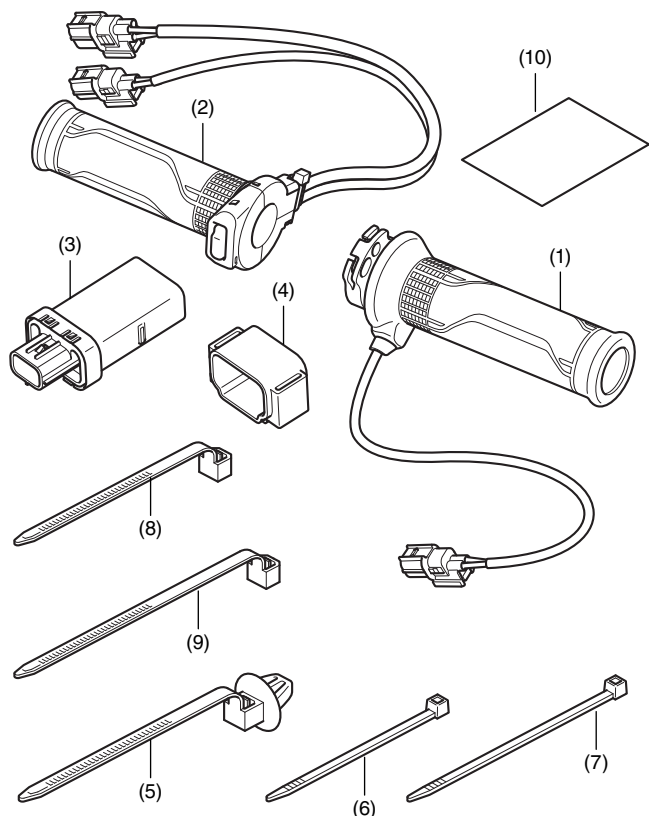

| No. | Description | Qty |
|------|--|-----|
| (1) | Right heated grip | 1 |
| (2) | Left heated grip | 1 |
| (3) | Heater controller | 1 |
| (4) | Suspension (Not used.) | 1 |
| (5) | Clip band | 6 |
| (6) | Wire tie (narrow/short) (Not used.) | 6 |
| (7) | Wire tie (narrow/long) | 6 |
| (8) | Wire tie (wide/short) (Not used.) | 6 |
| (9) | Wire tie (wide/long) (Not used.) | 3 |
| (10) | Installation Instructions URL | 1 |

TOOL AND SUPPLIES REQUIRED

| | |
|----------------------|---------------------------|
| Flat-tip screwdriver | Side cutters |
| Marker | Ruler |
| Electrical tape | Pro Honda Handgrip Cement |
| Thread lock | Grease |
| Isopropyl alcohol | Shop towel |

TORQUE CHART

Refer to the Service Manual for the torque values of the removed parts.

INSTALLATION

▲ CAUTION

- To prevent burns, allow the engine, exhaust system, radiator, etc., to cool before installing the accessory.

NOTE:

- Disconnect the throttle cables from the right grip as instructed in the Service Manual.
- For secure adhesion of the heated grips, use the recommended adhesive agent (Pro Honda Handgrip Cement) or equivalent.
- Be sure to open and close the throttle to check for smooth operation after installation of the right heated grip.
- Disconnect the negative (-) cable from the battery before installing this accessory.
- The clock memory will be erased when you disconnect the battery. Reset the clock after reconnecting the battery.
- Reinstall the removed parts on the motorcycle and make sure that no wires or harnesses are pinched.
- Trim the excess ends off the wire ties after attaching them to the wire harnesses. Do not allow the cut part of the wire tie to interfere with another harness or brake hose.
- After heated grip installation, check the lights (e.g. right / left turn signal lights and brake lights) for proper operation.

1. Remove the indicated clips.

<Left side>

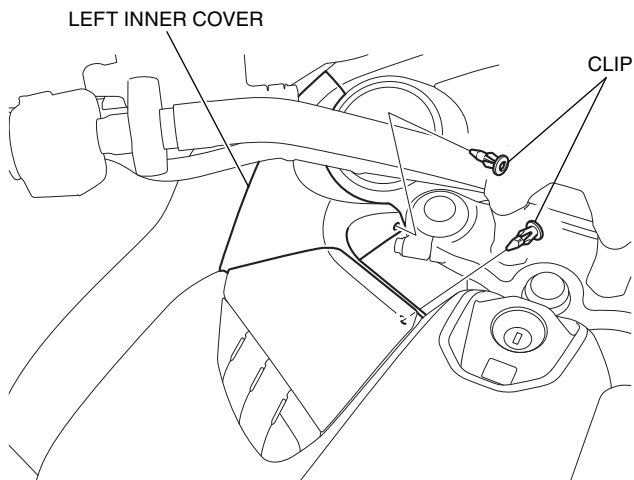

2. Remove the left inner cover and disconnect the negative (-) battery cable.

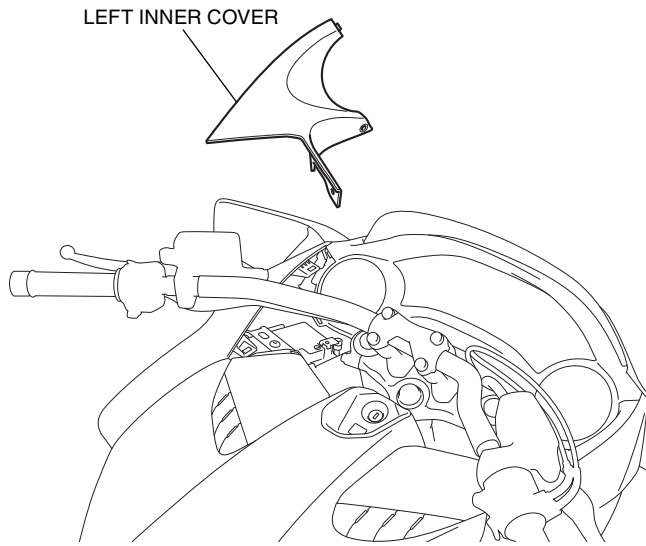

3. Remove the seat as shown.

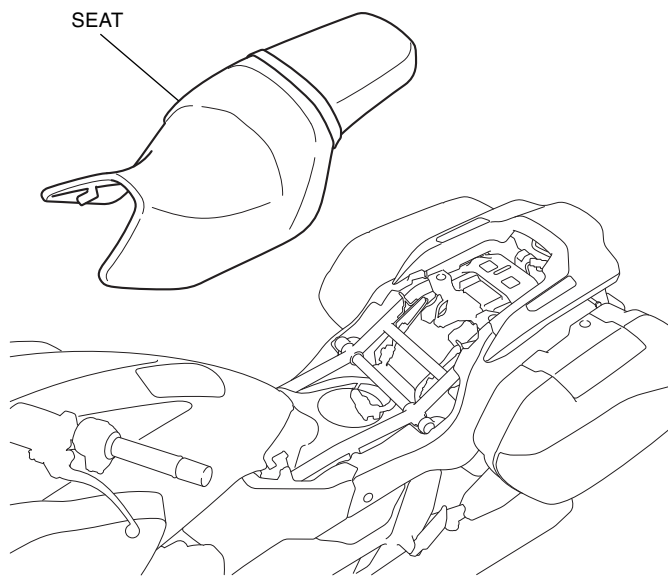

4. Remove the parts as shown.

<Left side>

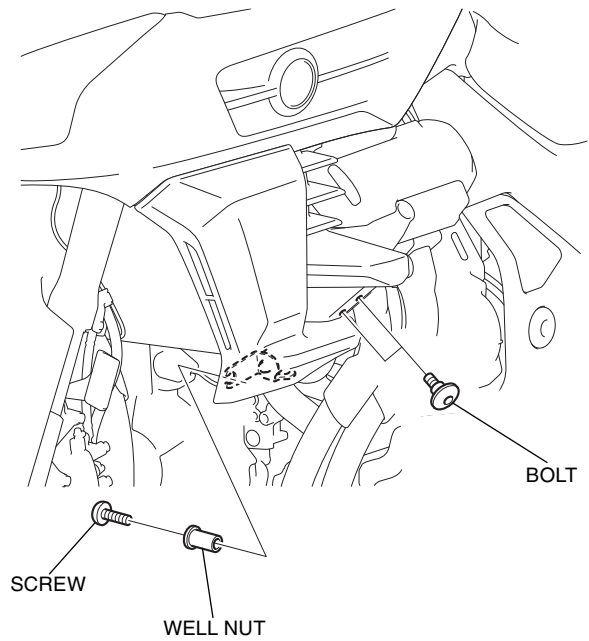

5. Remove the left shroud cover as shown.

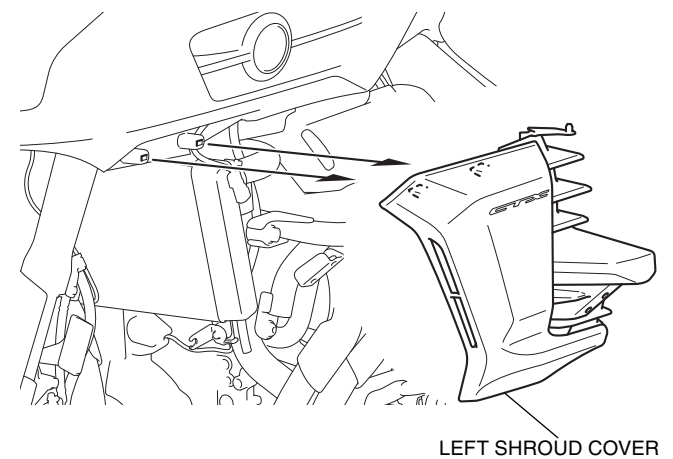

6. Repeat Steps 4 and 5 on the right side.

7. Remove the clip as shown.

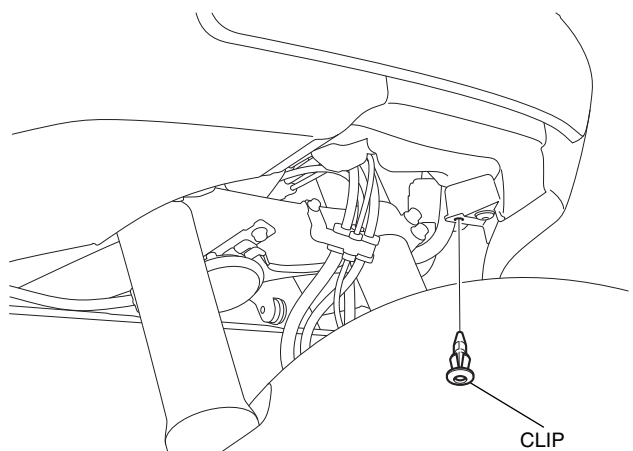

8. Remove the left middle cowl as shown.

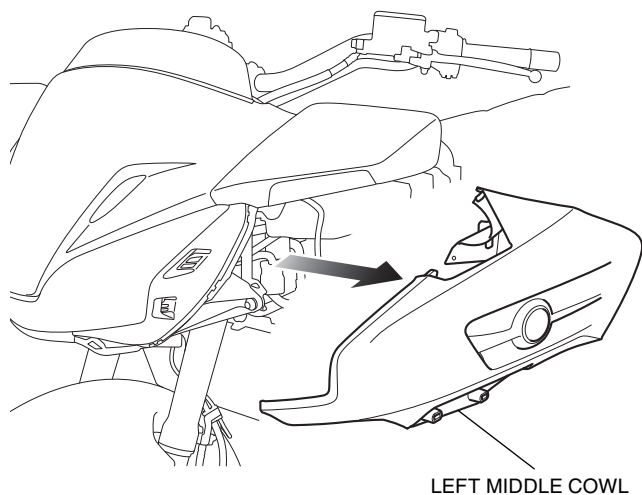

9. Remove the right inner cover as shown.

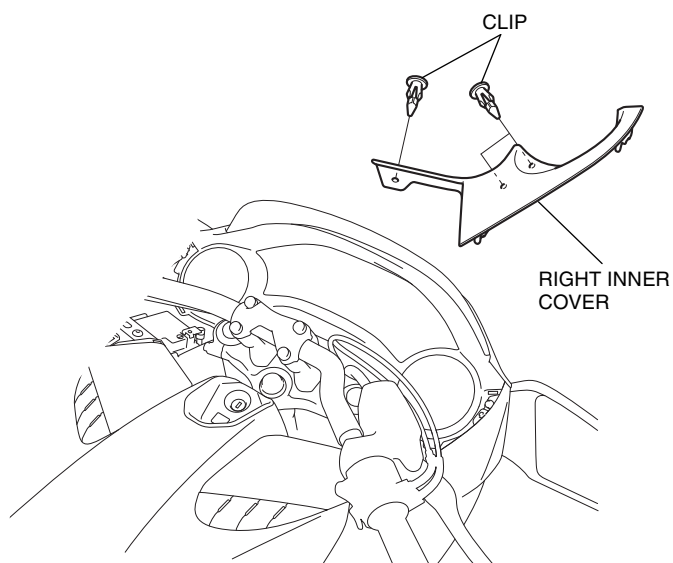

10. Remove the right middle cowl by repeating Steps 7 and 8 on the right side.

11. Remove the left pocket as shown.

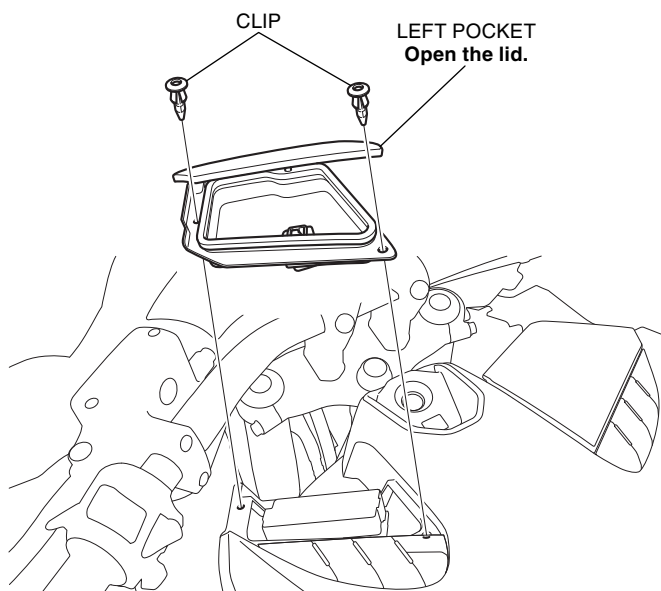

12. (CTX1300A only) Remove the USB connector from the USB connector holder.

<Right side>

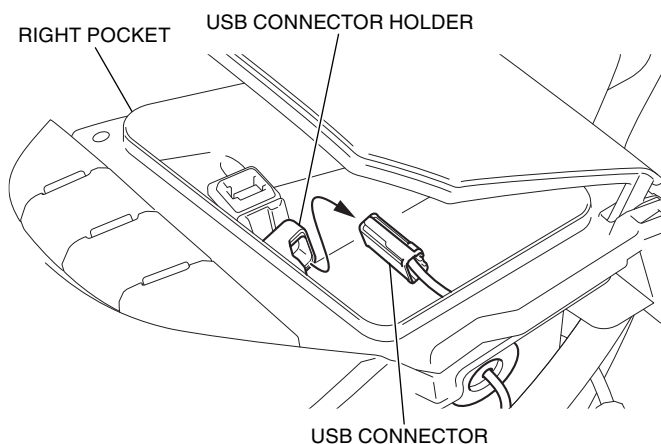

13. (CTX1300A only) Remove the USB cord as shown.

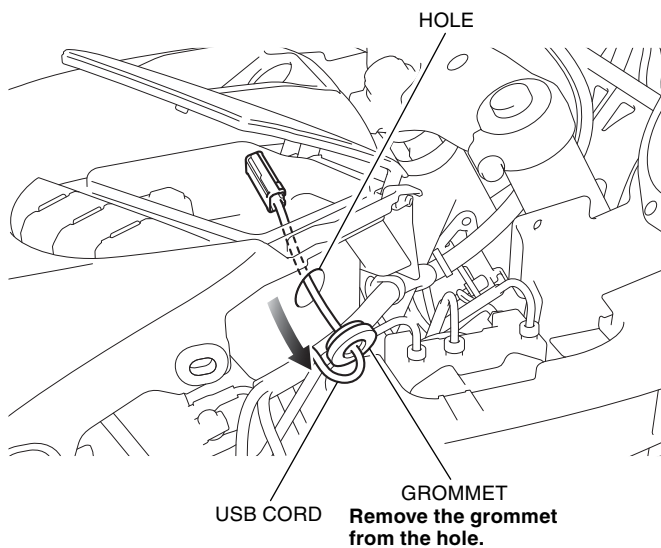

14. Repeat Step 11 on the right side.

15. Remove the bolts as shown.

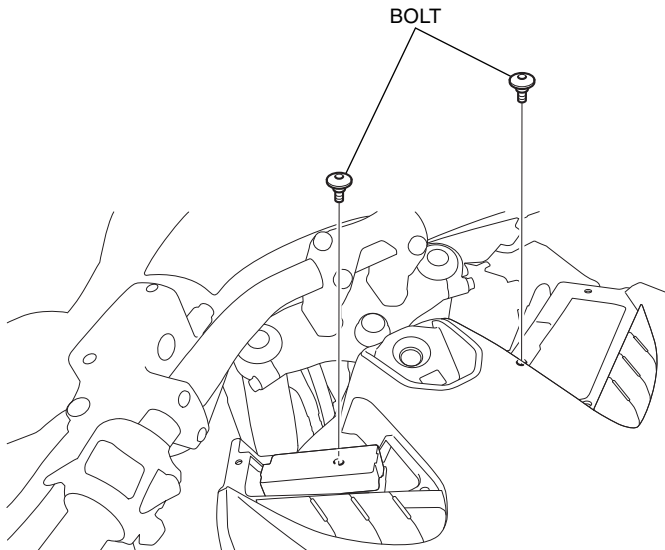

16. Remove the bolt and clip as shown.

- Repeat on the right side.

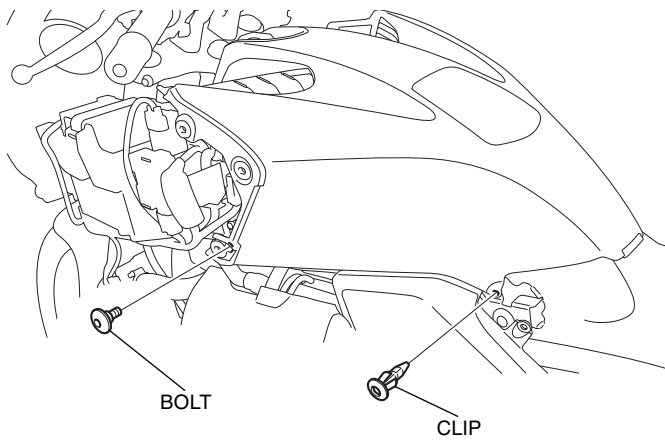

17. Open the fuel lid and remove the wire from the tank cap as shown.

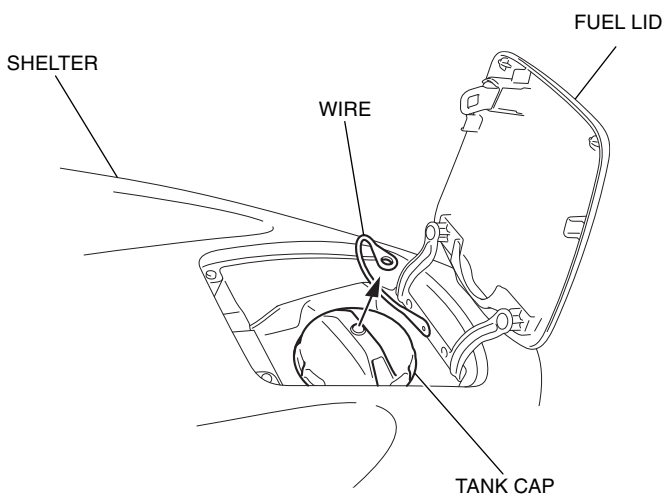

18. Disconnect the connectors and move the shelter to the rear of motorcycle.

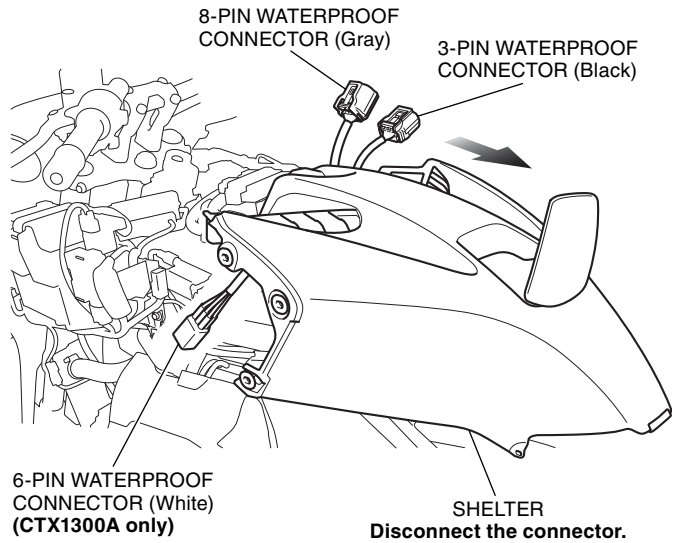

19. Remove the suspension as shown.

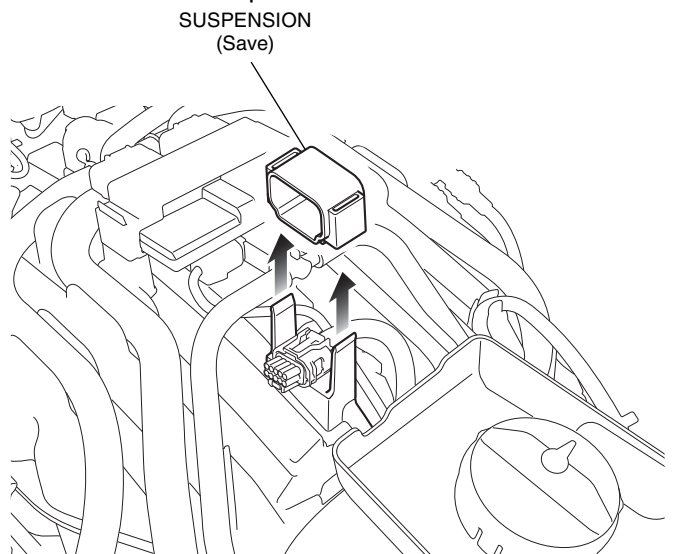

20. Install the suspension as shown.

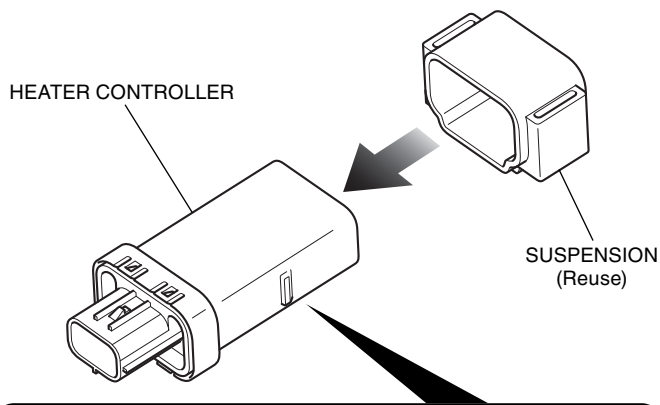

Insert until the end of the suspension stops with the rib as shown.

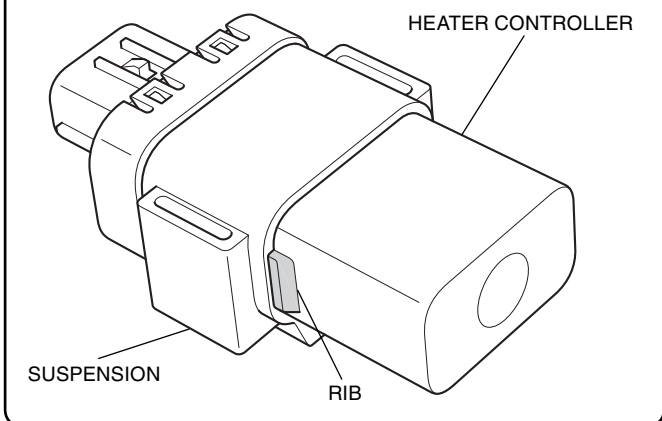

21. Remove the dummy connector as shown.

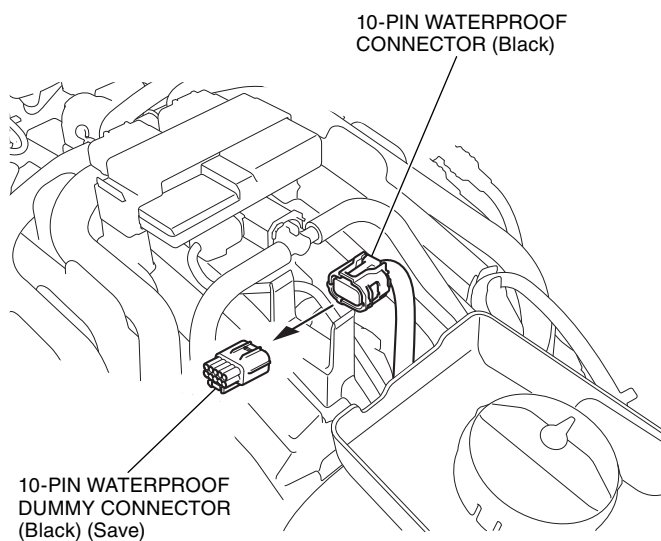

22. Connect the heater controller as shown.

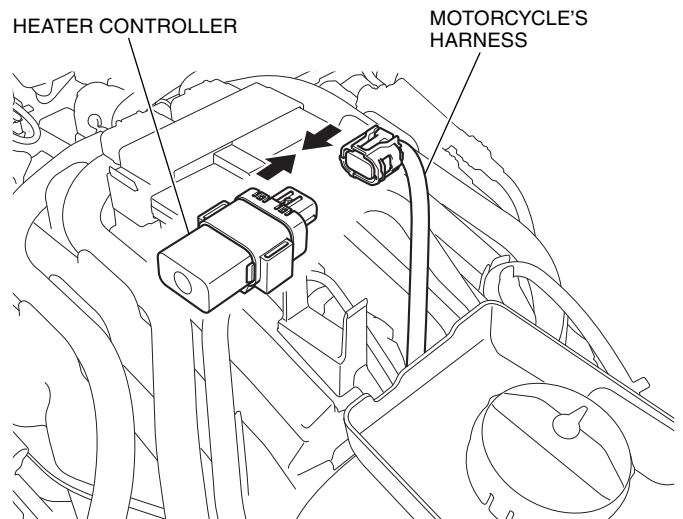

23. Secure the heater controller as shown.

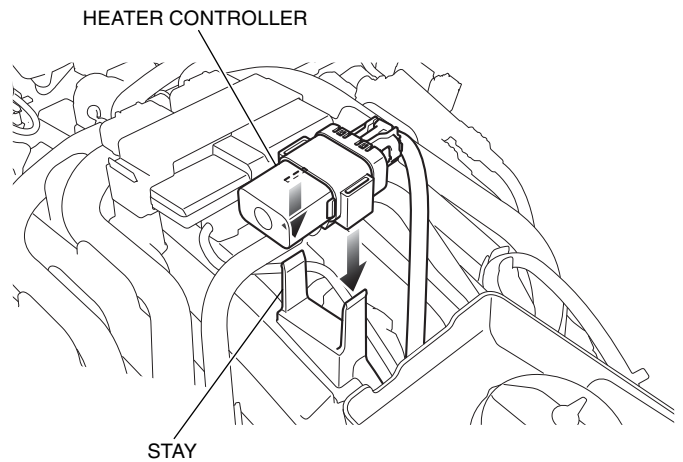

24. Remove the handlebar weight as shown.

- Repeat on the right side.

<Left side>

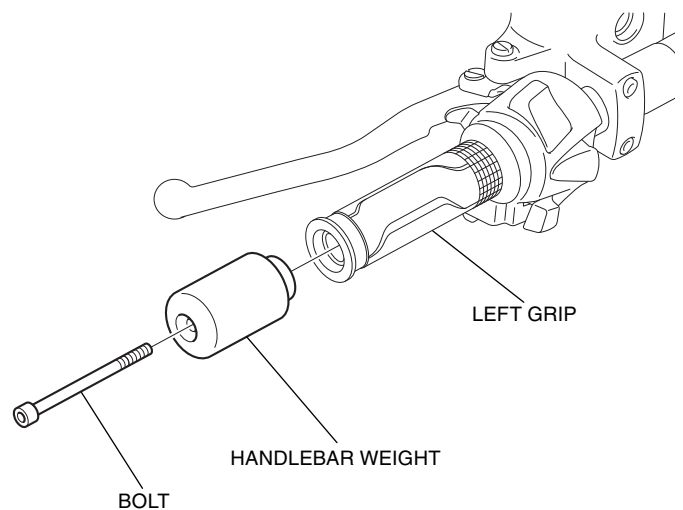

25. Remove the left grip as shown.

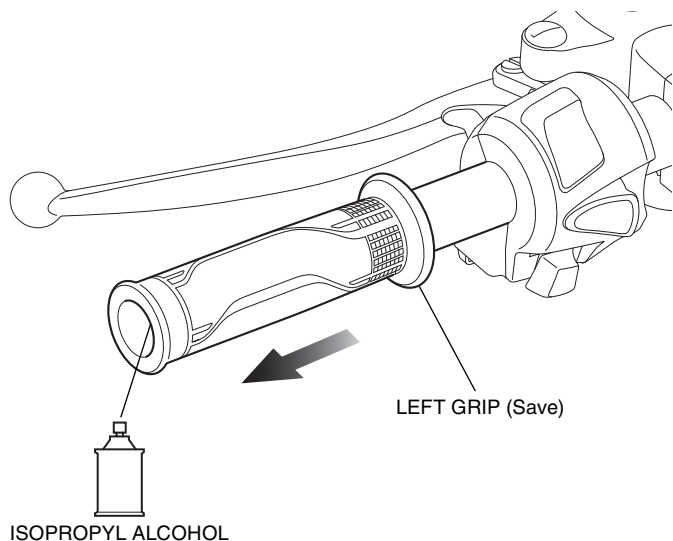

26. Using isopropyl alcohol, remove all traces of adhesive from the left handlebar.

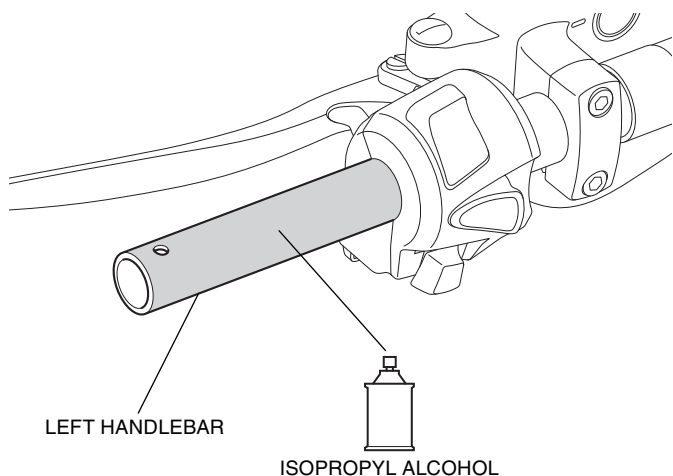

27. Mark the left heated grip harness in the positions shown.

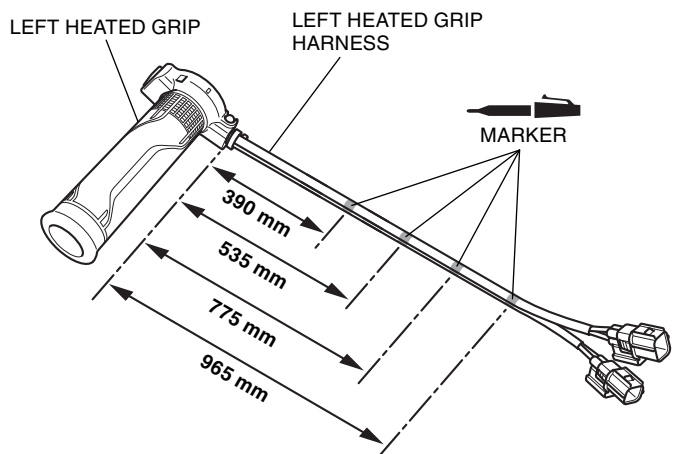

28. Install the clip bands and electrical tape at the marked positions as shown.

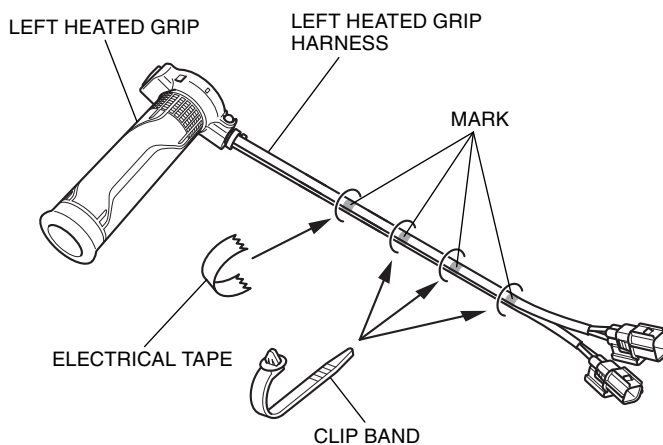

29. Apply Pro Honda Handgrip Cement to the left handlebar as shown.

- Apply evenly to the entire surface of the left handlebar.
- Wait 5 minutes before performing the next step.

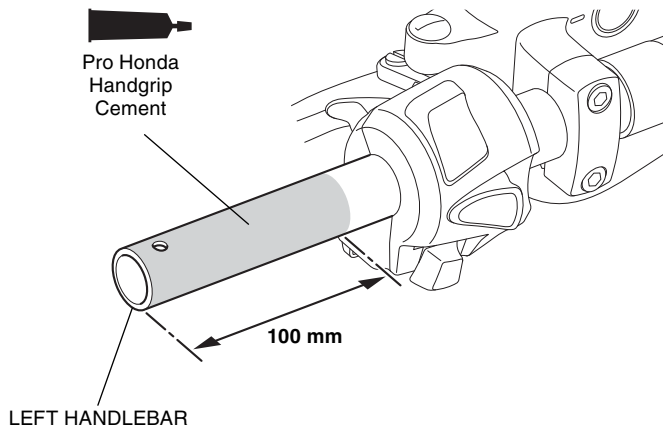

30. Spray isopropyl alcohol over the inside of the heated grip and outside of the left handlebar.

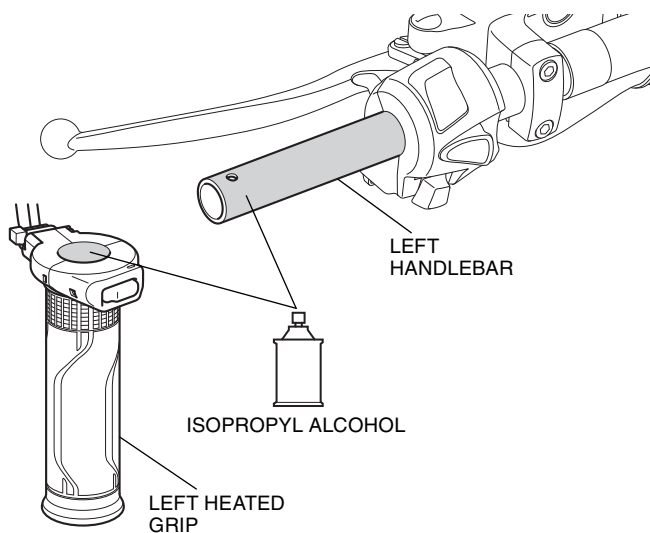

31. Slide the left heated grip onto the left handlebar as indicated.
- Use an assistant to steady the motorcycle while installing the grips.
 - Wipe up excess adhesive at once.

NOTICE

- Do not tap on the grip end with a hammer and do not twist the grip to install the heated grip onto the handlebar, as it can damage the element.

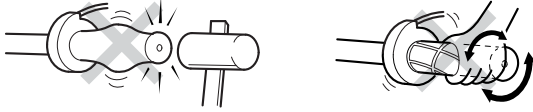

- Avoid putting pressure on the switch part when inserting the left heated grip. There is a possibility that the switch part will break. Also, install so that there is no gap with the switch holder.



- If the grip gets stuck halfway during installation, apply isopropyl alcohol to the gap between the heated grip. Do not try to remove the heated grip using force or a screwdriver, etc. Damage to the heated grip wire can result.
- Do not touch the left handlebar or turn on the heater switch for at least one hour after attachment.

Insert until there is contact with the switch holder, then align to the indicated position.

Align the recess of the left heated grip with the alignment line of the switch holder.

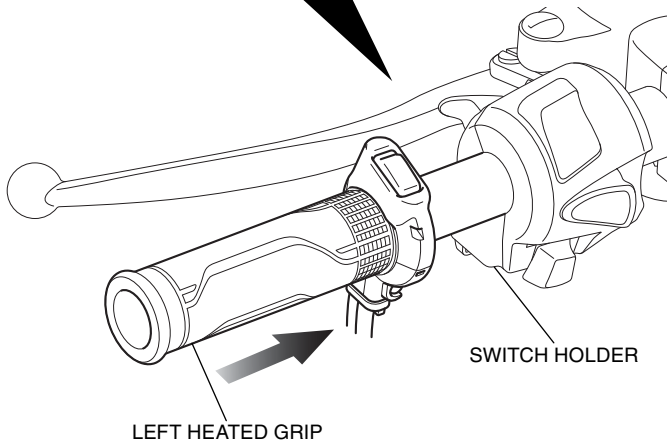
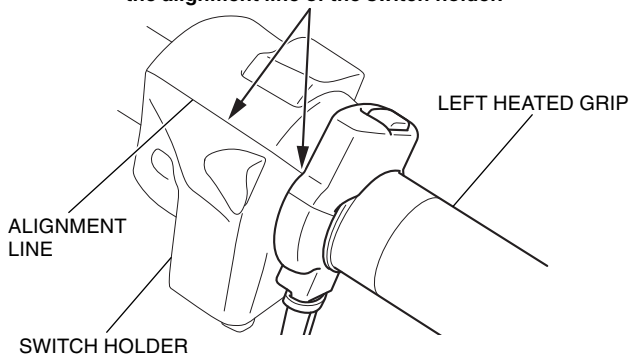

32. Remove the connectors from the stay as shown.

<Front side>

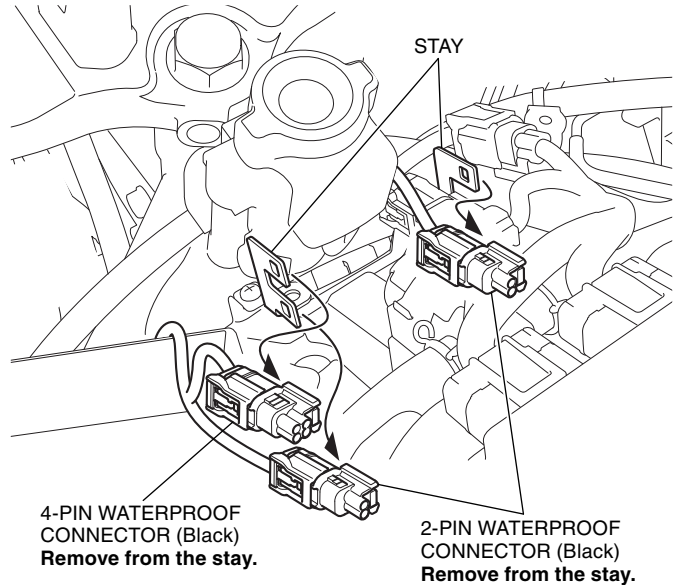

33. Remove the dummy connectors as shown.

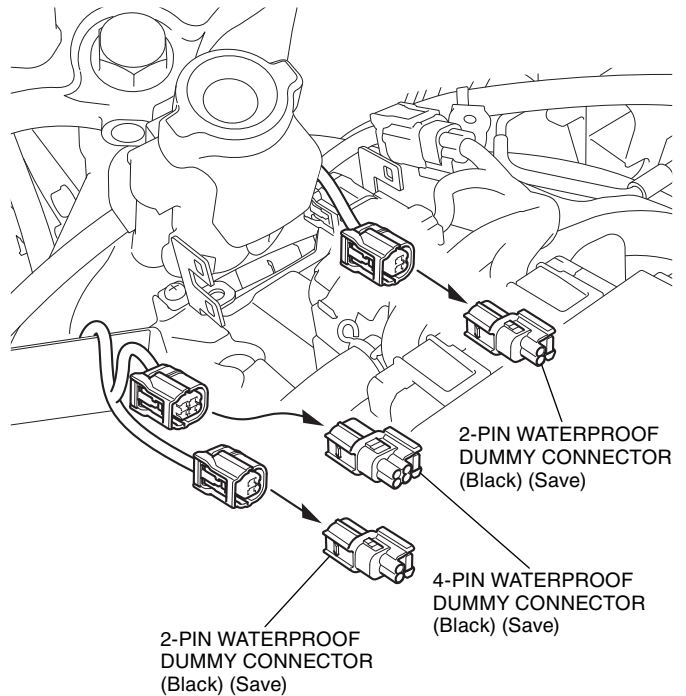

34. Route the left heated grip harness as shown.

<Left side>

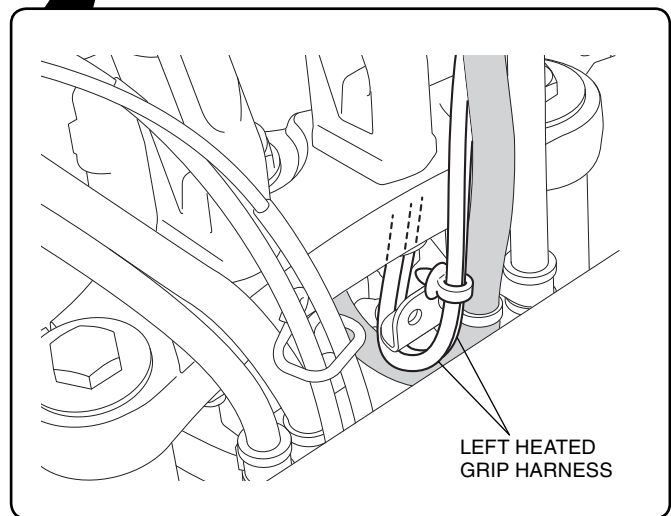
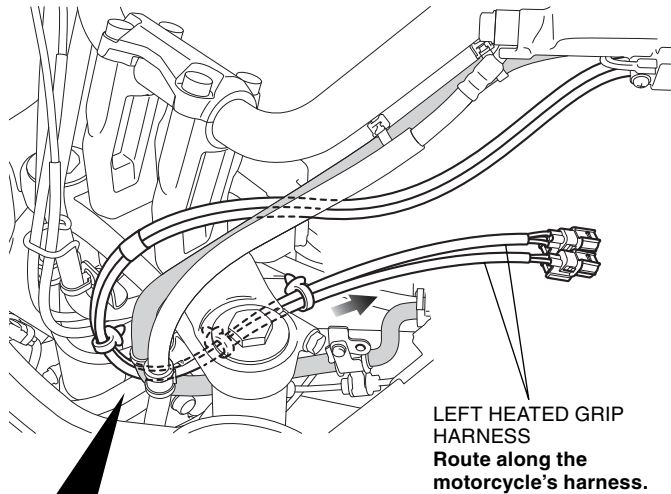

35. Route the left heated grip harness and connect it as shown.

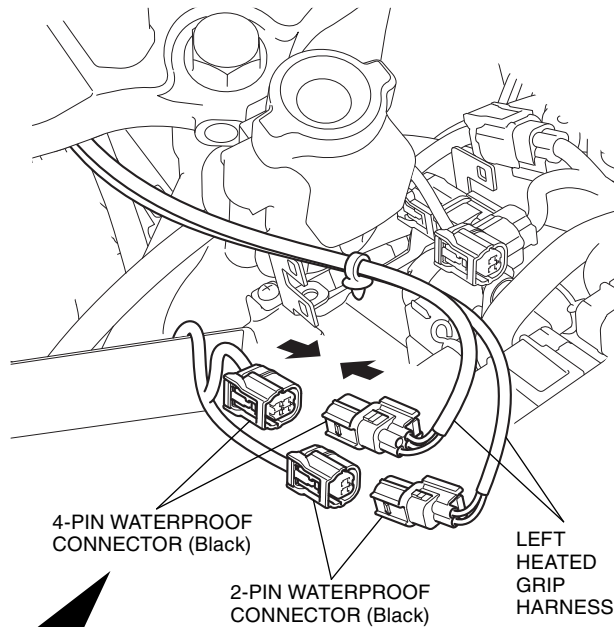

Secure the left heated grip harness to the stay.

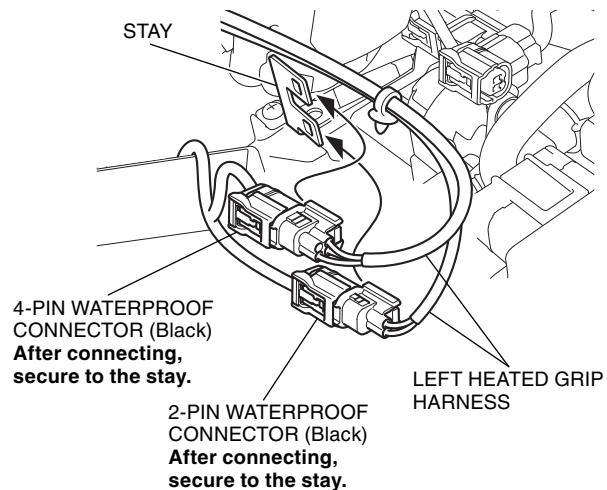

36. Secure the left heated grip harness as shown.

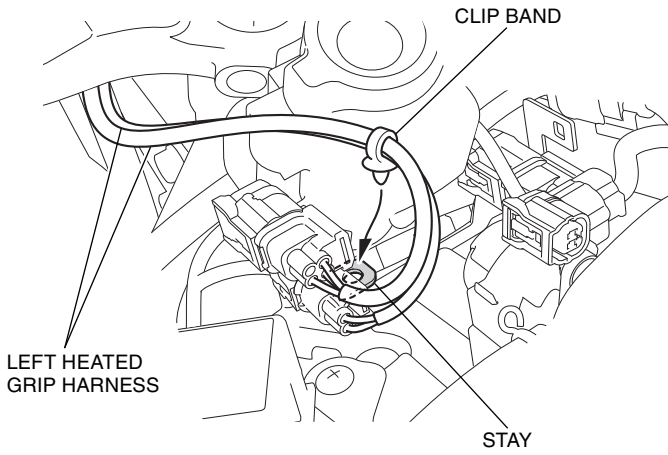

37. Secure the left heated grip harness as shown.

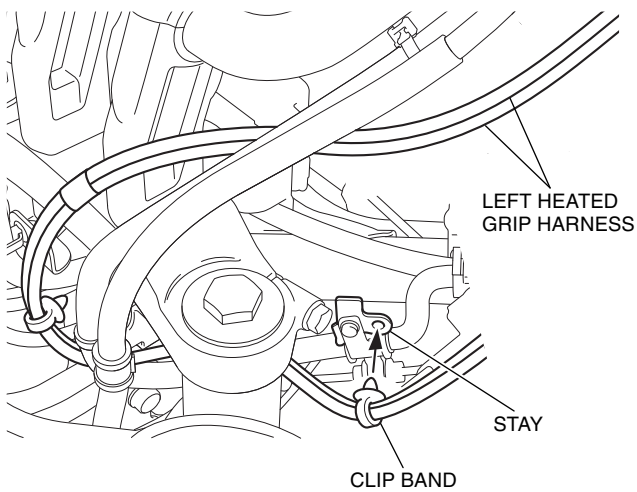

38. Secure the left heated grip harness as shown.

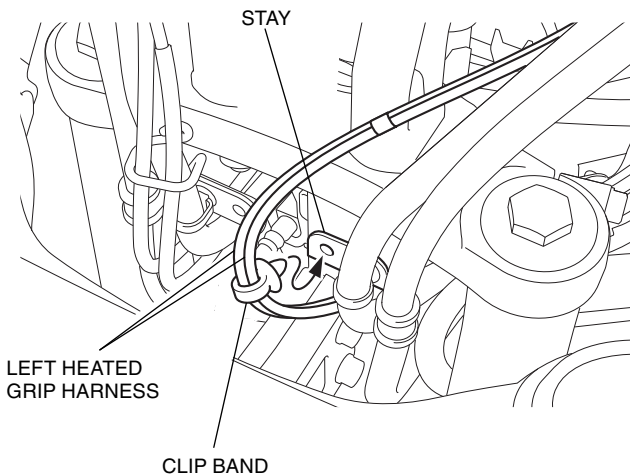

39. Secure the left heated grip harness as shown.

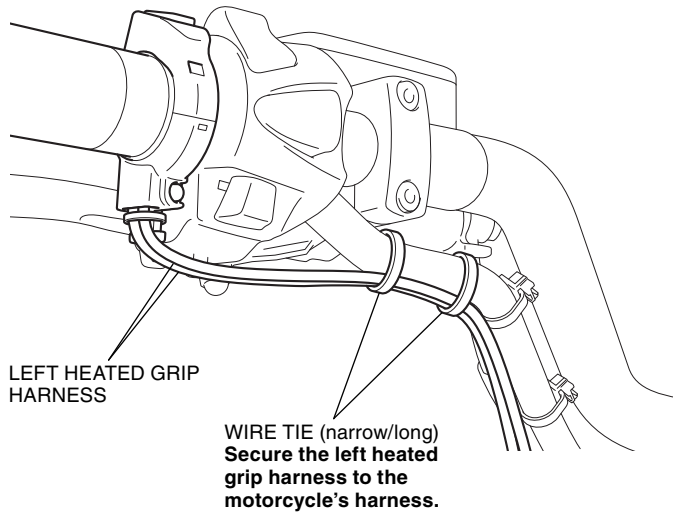

40. Secure the left heated grip harness as shown.

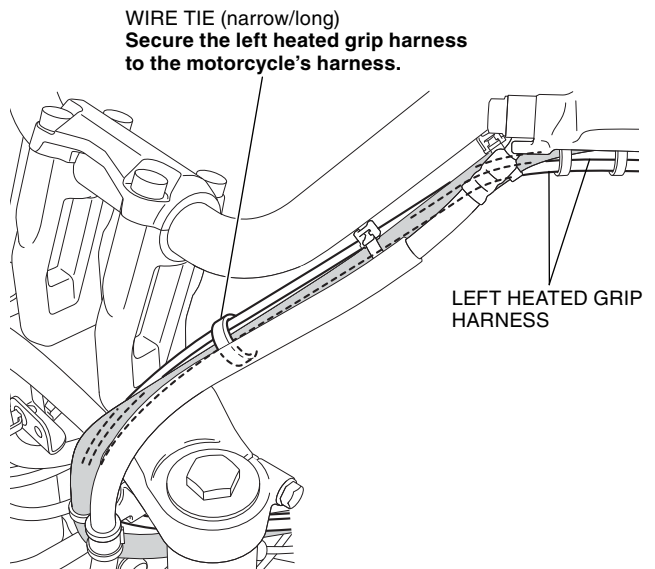

41. Remove the indicated screws.

<Right side>

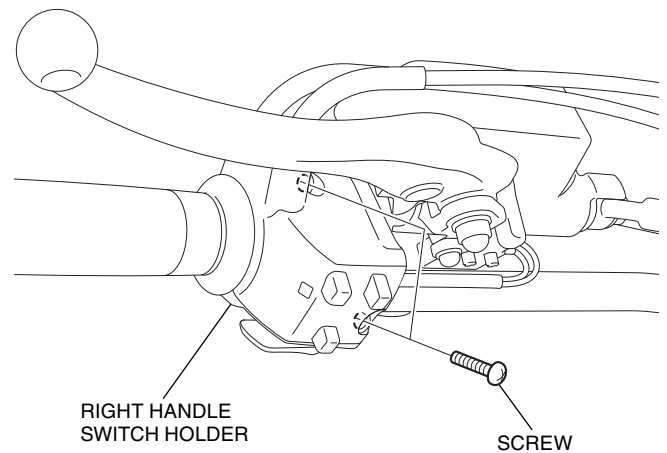

42. Remove the right grip as shown.

NOTE

Disconnect the throttle cables from the right grip as instructed in the Service Manual. Do not try to disconnect the cable with force using pliers, etc.

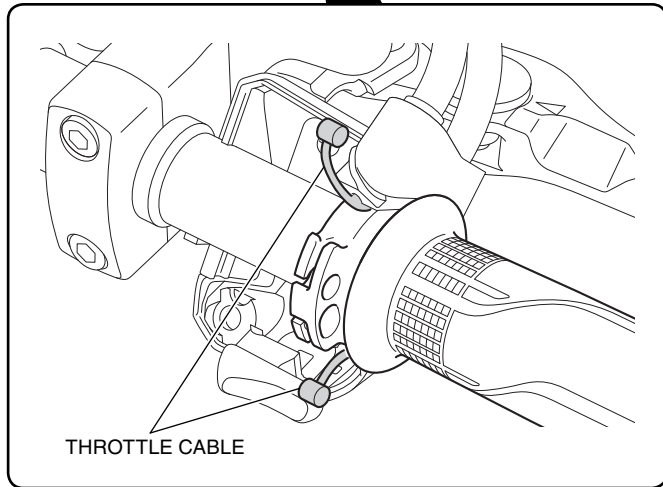
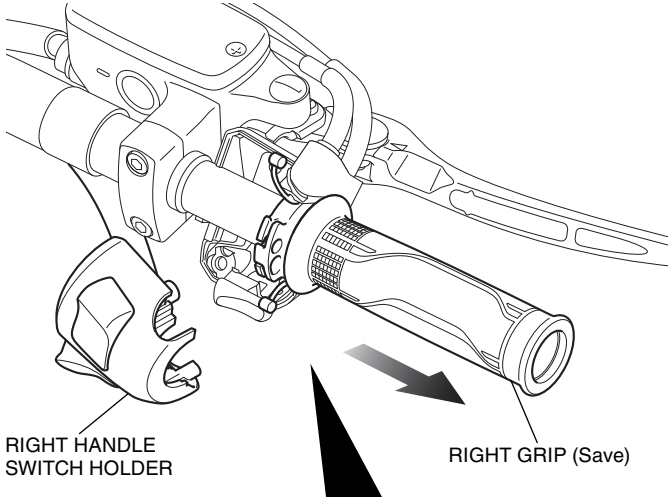

43. Mark the right heated grip harness in the positions shown.

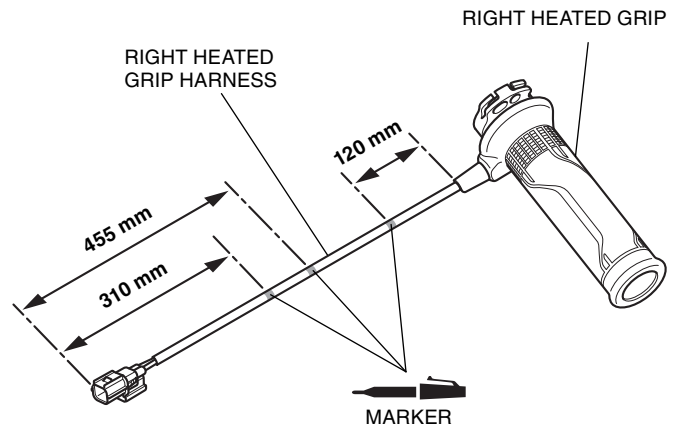

44. Wind the electrical tape on the marked position as shown.

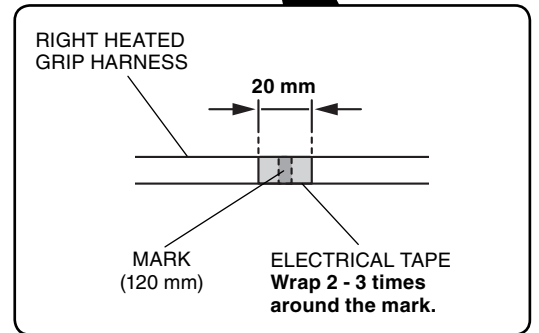
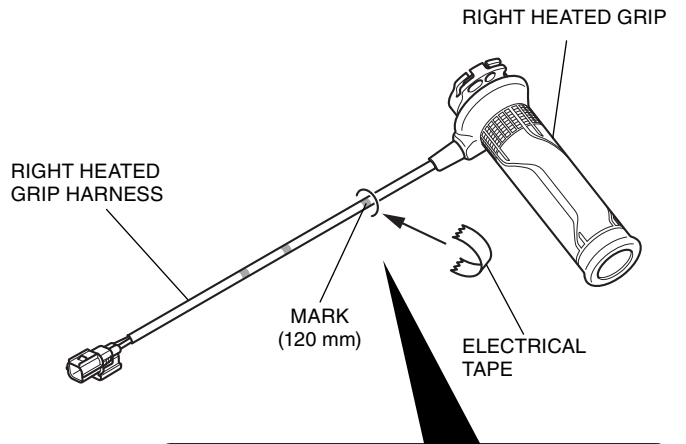

45. Install the clip bands at the marked position as shown.

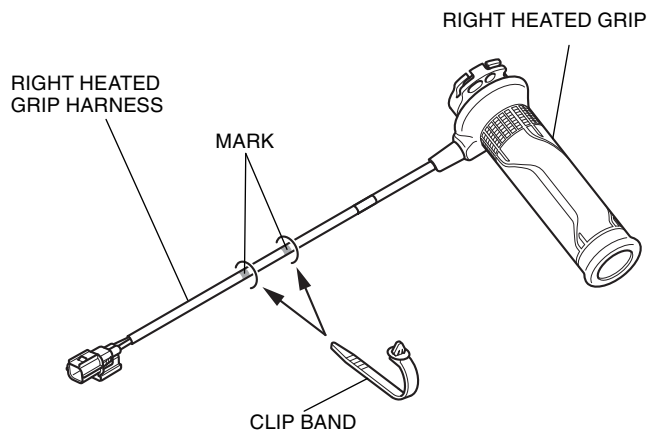

46. Apply grease to the  parts of the throttle cables and inner grip as shown.

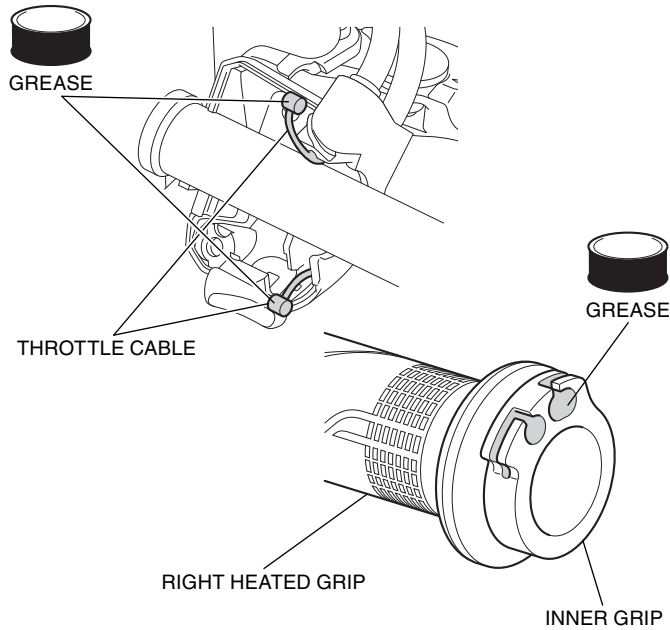

47. Install the right heated grip and right switch holder in the reverse order of removal.

- **After installation, refer to the Service Manual and adjust the throttle freeplay.**

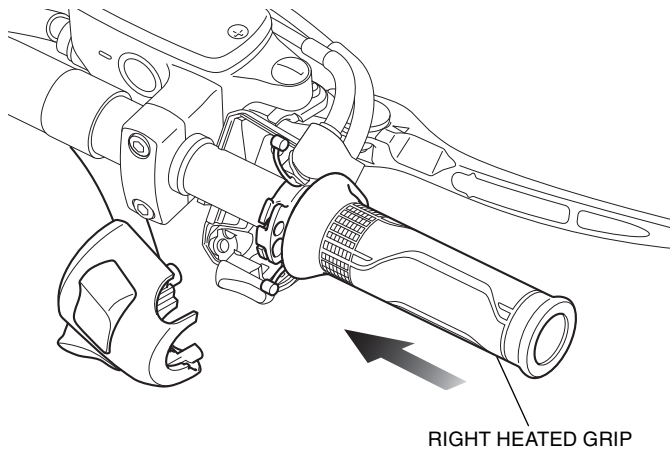

48. Twist the throttle grip as shown.

- **Check for smooth operation of the throttle and that it opens fully and automatically closes in all steering positions.**

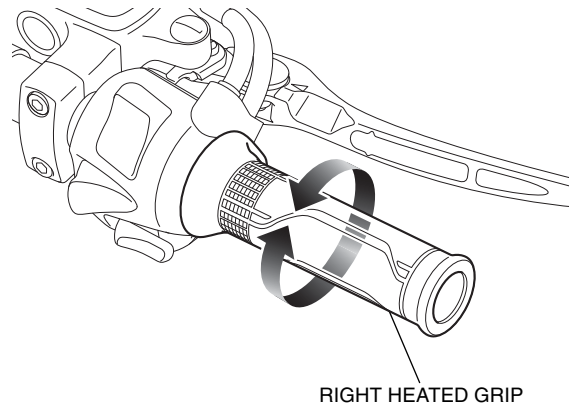

49. Route the right heated grip harness as shown and secure the harness with the wire tie.

- **Open and close the throttle and confirm that there is no tightness of the heated grip harness.**

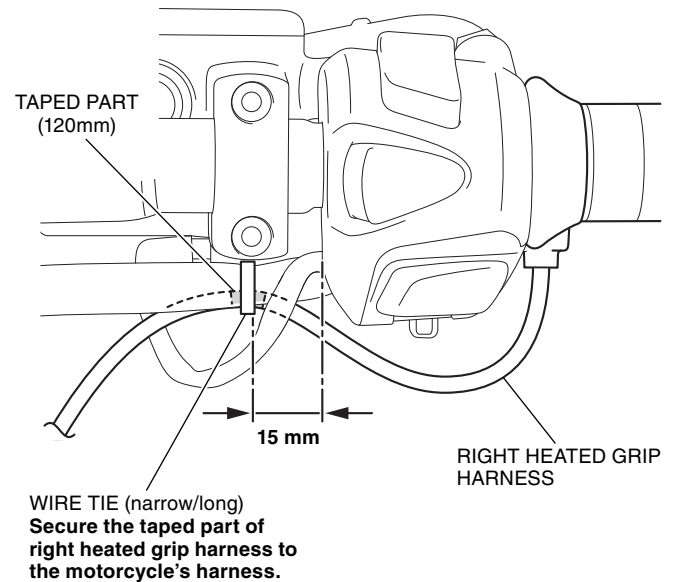

50. Route the right heated grip harness as shown.

<Right side>

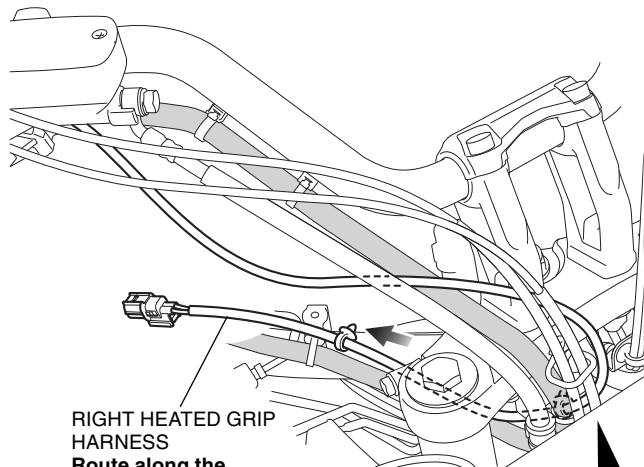

RIGHT HEATED GRIP HARNESS
Route along the motorcycle's harness.

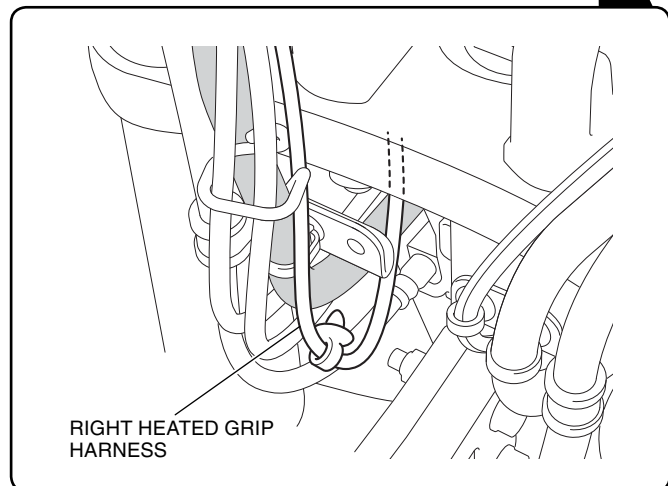

RIGHT HEATED GRIP HARNESS

51. Route the right heated grip harness as shown.

RIGHT HEATED GRIP HARNESS

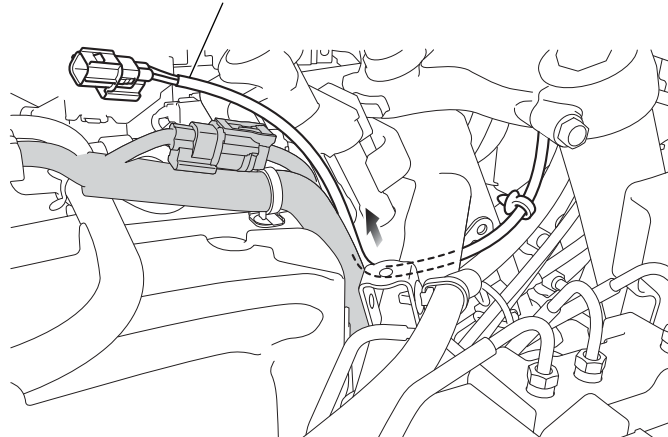

52. Connect the right heated grip harness as shown.

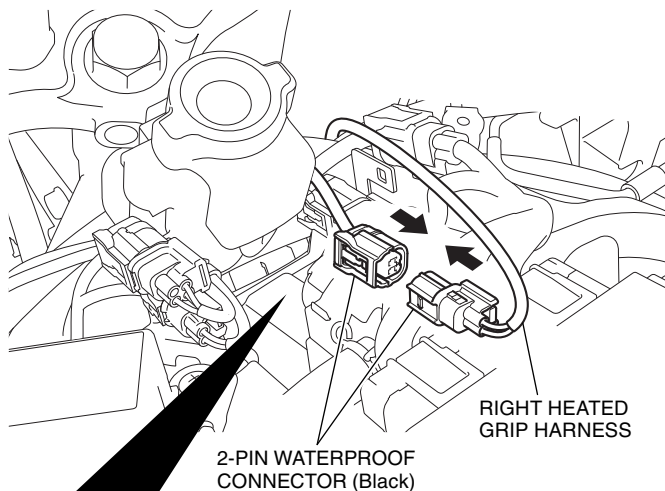

2-PIN WATERPROOF CONNECTOR (Black)

RIGHT HEATED GRIP HARNESS

Secure the right heated grip harness to the stay.

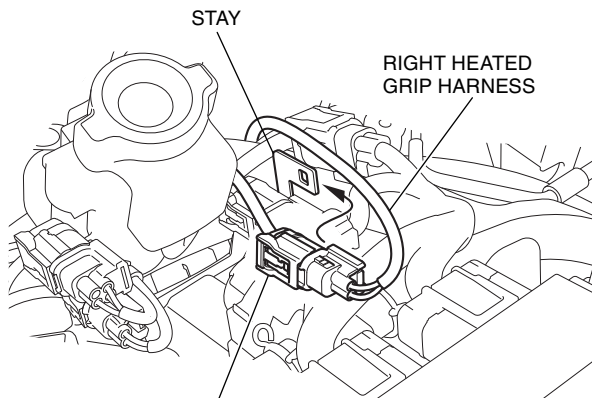

STAY

RIGHT HEATED GRIP HARNESS

2-PIN WATERPROOF CONNECTOR (Black)
After connecting, secure to the stay.

53. Secure the right heated grip harness as shown.

RIGHT HEATED GRIP HARNESS

STAY

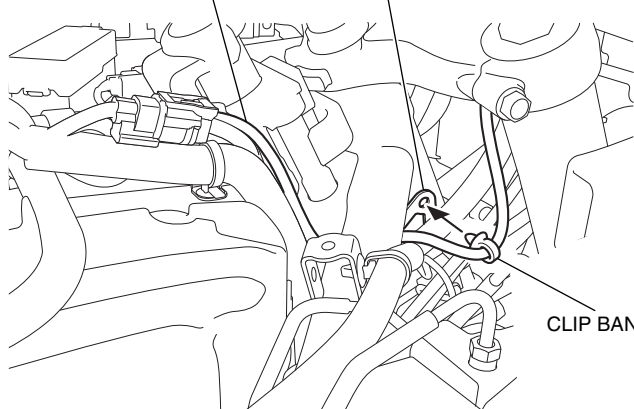

CLIP BAND

54. Secure the right heated grip harness as shown.

<Front side>

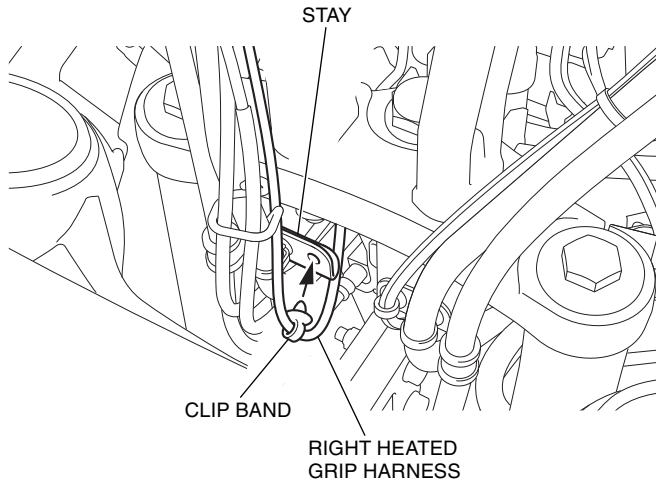

55. Secure the right heated grip harness as shown.

<Right side>

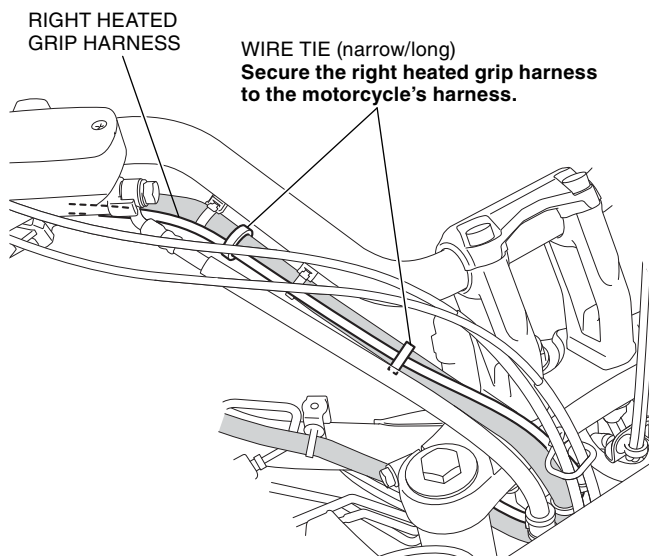

56. Check each harness for sufficient play.

- Move the handlebar right and left and check that the harnesses are not pinched by neighboring components and that they are not pulled taut.

57. Reinstall the handlebar weight as shown.

- Clean with isopropyl alcohol before applying thread lock.
- Be sure to apply to the threads of the bolt.
- Repeat on the right side.

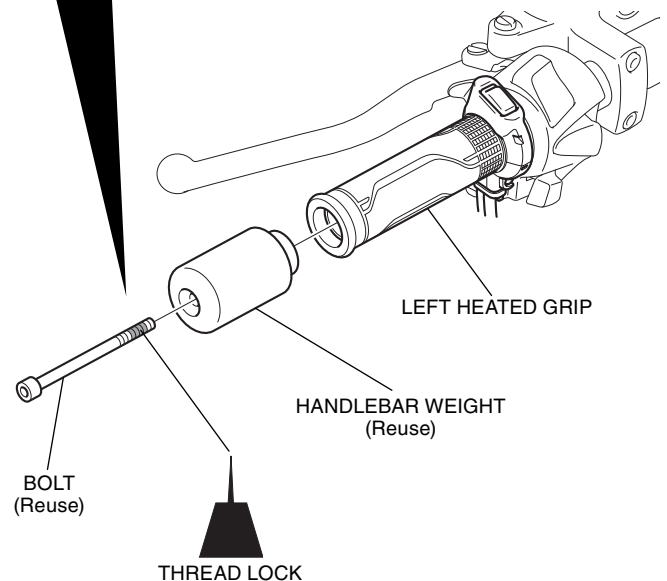
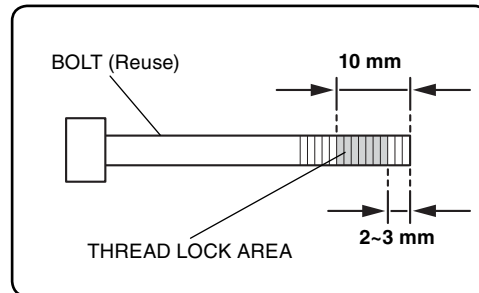

58. Install the removed parts in the reverse order of removal.

- Confirm that no wire or harness is caught or too tight.

59. Check the heated grip, throttle, headlight, and the other lights for proper operation.

- Perform the operation check at least one hour after attaching the left heated grip. Do not set the heater level at more than 3 as the handgrip cement will be softened.
- Make sure to turn off the heater switch after the operation check.

Please Convey The Following Information To The Customer Before Delivery.

- Do not set the heater level higher than 1 for one week after installation to allow the handgrip cement to fully cure.