

# HONDA

## INSTALLATION INSTRUCTIONS

Accessory  
**SADDLEBAG SUPPORT STAY**  
 P/N 08L71-MJJ-D30

Application  
**After '12 NC700X/XD**

Publication No.  
**MII 15736**  
 Issue Date  
**March 2016**

**Honda Dealer: Please give a copy of these instructions to your customer.**

### PARTS LIST

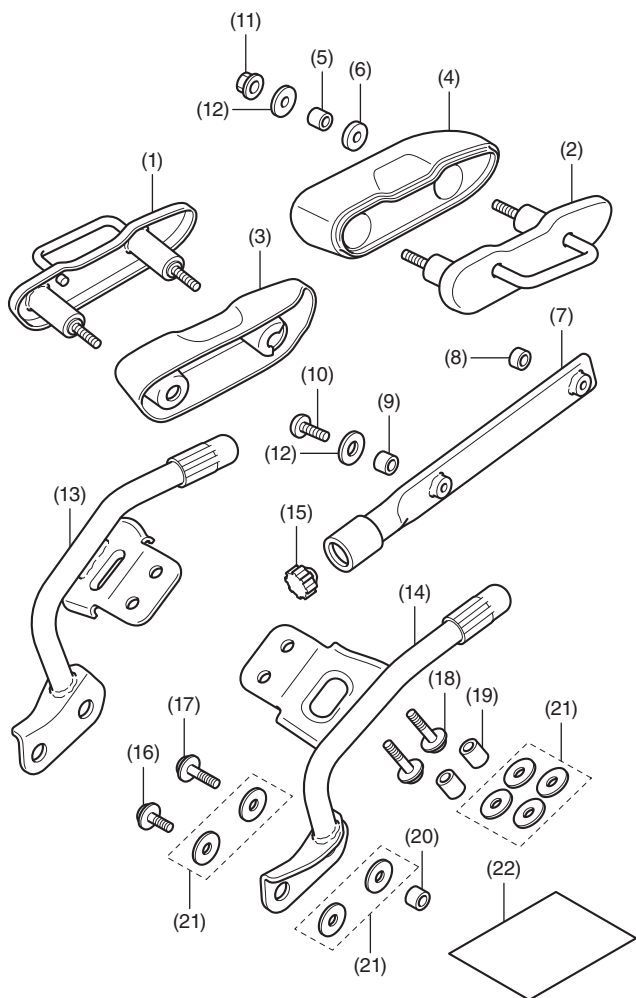

No.	Description	Qty
(1)	Right saddlebag hook	1
(2)	Left saddlebag hook	1
(3)	Right hook cover	1
(4)	Left hook cover	1
(5)	Collar A (I.D. 6.5 mm, Length 10 mm)	4
(6)	Collar B (I.D. 6.5 mm, Length 4.5 mm)	4
(7)	Saddlebag bracket	2
(8)	Collar C (I.D. 6.3 mm, Length 4.5 mm)	2
(9)	Collar D (I.D. 6.3 mm, Length 6.5 mm)	2
(10)	6 mm socket bolt	4
(11)	6 mm flange nut	4
(12)	6 mm washer	8
(13)	Right saddlebag support stay	1
(14)	Left saddlebag support stay	1
(15)	Rubber stop	2
(16)	8 mm socket bolt [Length 20mm] (short)	2

No.	Description	Qty
(17)	8 mm socket bolt [Length 30 mm] (medium)	2
(18)	8 mm socket bolt [Length 33 mm] (long)	4
(19)	Collar E (I.D. 8.5 mm, Length 15.5 mm)	4
(20)	Collar F (I.D. 8.5 mm, Length 10.8 mm)	2
(21)	8 mm washer	16
(22)	Installation Instruction URL	1

### REAR CARRIER

Sold separately

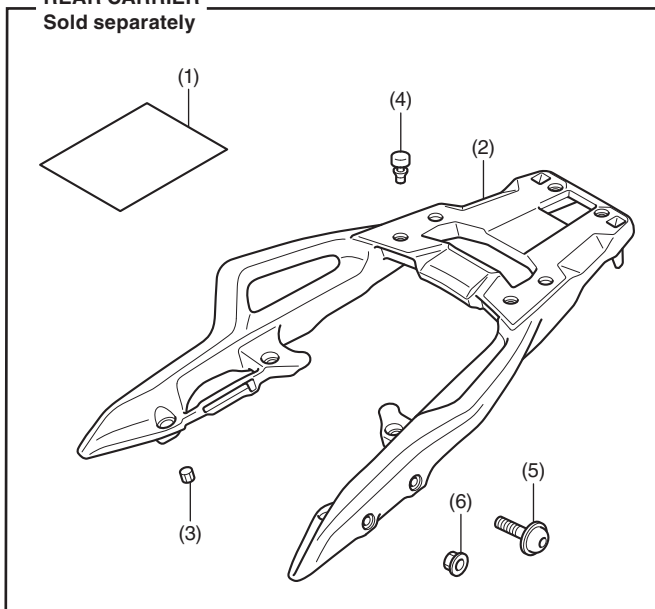

No.	Description	Qty
(1)	Installation Instruction URL	1
(2)	Rear carrier	1
(3)	6 mm plug	4
(4)	Rubber cushion	4
(5)	8 mm socket bolt <b>(Not used.)</b>	4
(6)	8 mm flange nut <b>(Not used.)</b>	4

### TOOLS REQUIRED

Hex wrench (4 and 5 mm)  
 Box-end wrench (10 mm)  
 Side cutters  
 File  
 Ruler  
 Torque wrench

## TORQUE CHART

Tighten all screws, bolts, and nuts to their specified torque values. Refer to the Service Manual for the torque values of the removed parts.

Item	N·m	kgf·m	lbf·ft
6 mm socket bolt	10	1.0	7
6 mm flange nut	12	1.2	9
8 mm socket bolt	24	2.4	18

## INSTALLATION

### ⚠ CAUTION

- To prevent burns, allow the engine, exhaust system, radiator, etc., to cool before installing the accessory.

### NOTE:

- Take care not to damage the painted surfaces of the motorcycle.
- Illustration shows NC700X type, other types are similar.**

- Install the left saddlebag hook and hook cover as shown.
  - Repeat on the right side.**

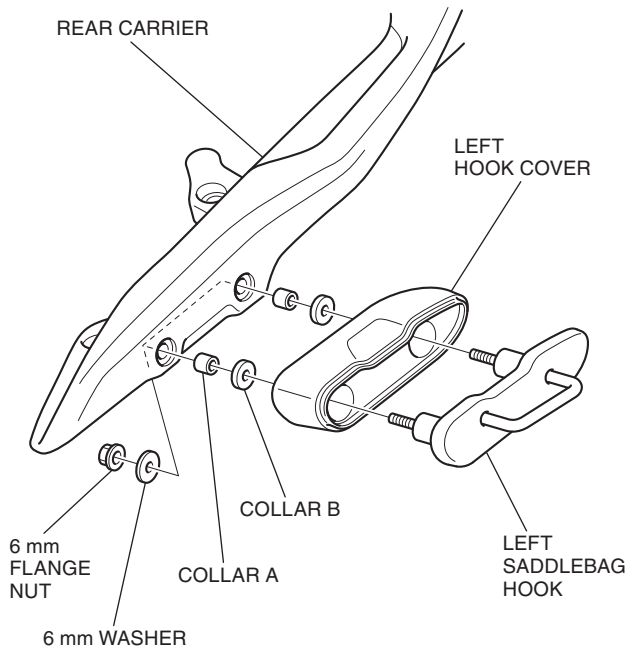

- Refer to the Installation Instruction of the rear carrier, install the rear carrier.

- Refer to the Service Manual for the motorcycle. Remove the drive chain case.

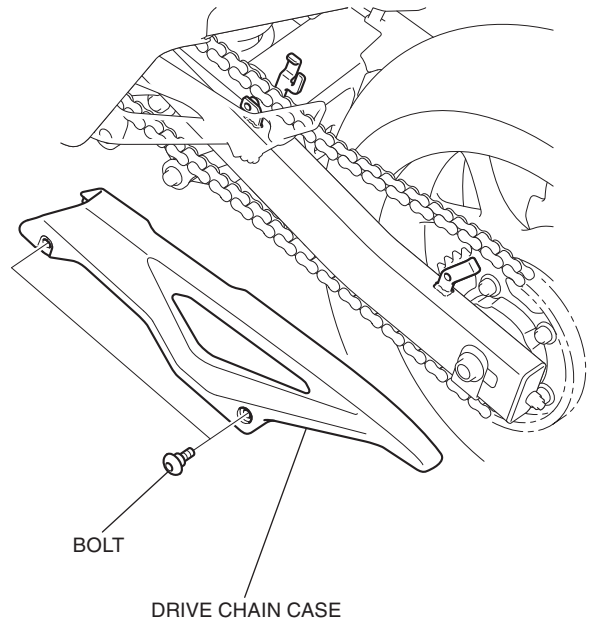

- Work on the rear fender B as shown.
  - Be careful not to damage the harness.**
  - Remove any burrs from the edge of the hole.**
  - Repeat on the right side.**

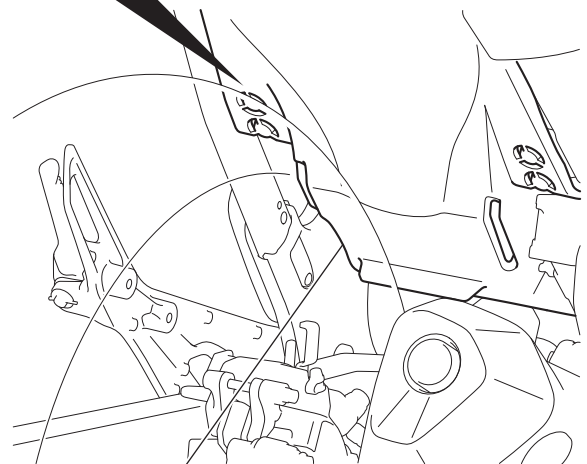
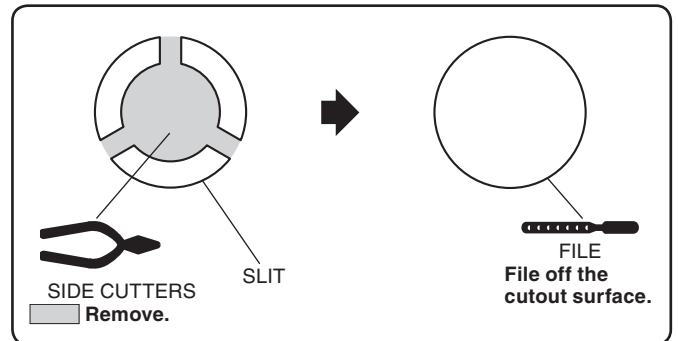

REAR FENDER B

5. Loosely install the left saddlebag stay as shown.

- Repeat on the right side.

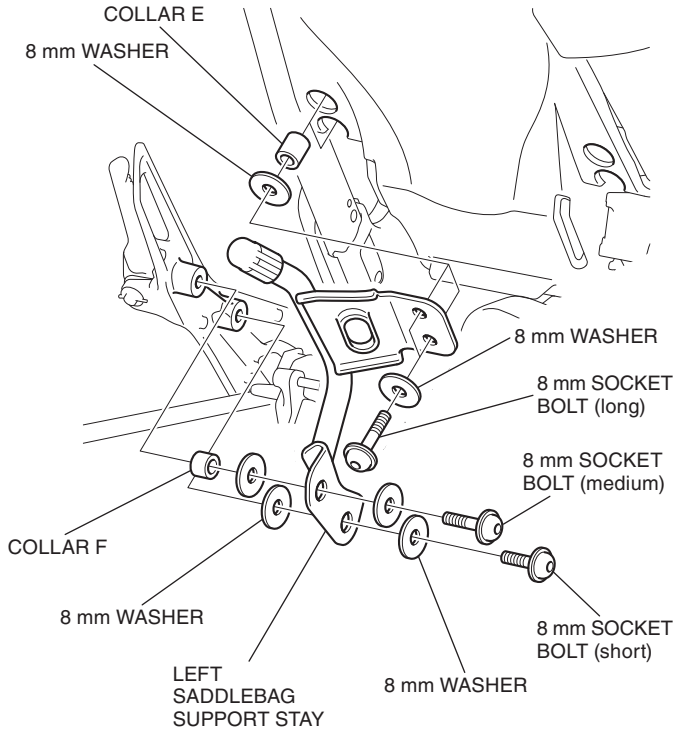

6. Install the rubber stop as shown.

- Make two sets.

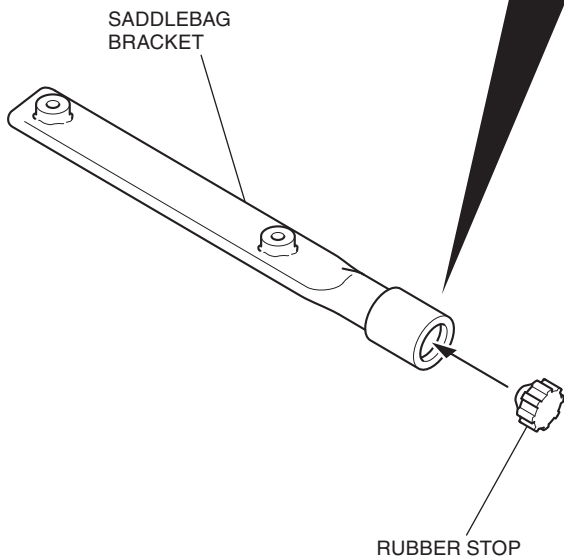
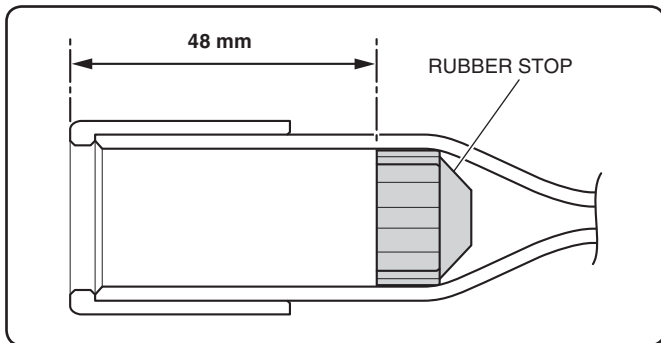

7. Install the saddlebag bracket as shown.

- Repeat on the right side.

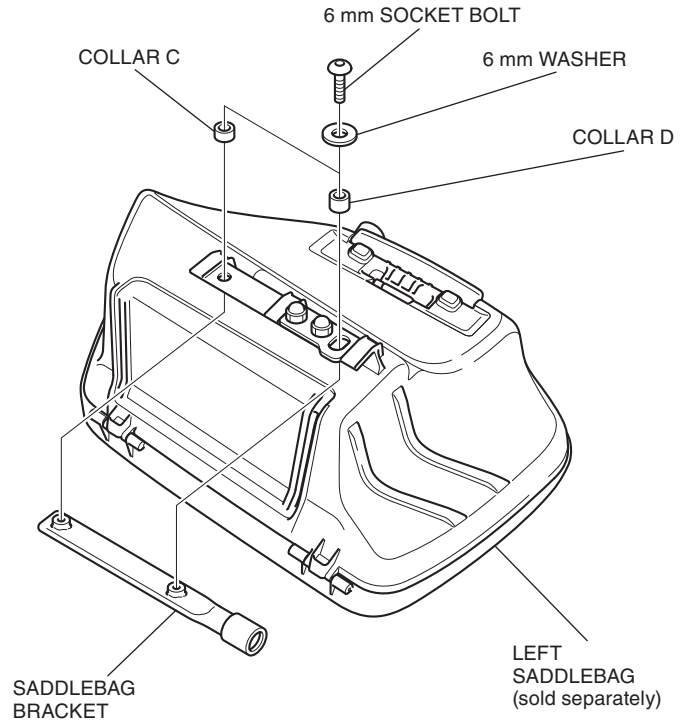

8. Install the left saddlebag and tighten all loosely installed hardware to the specifications in the torque chart.

- When securing the saddlebag support stay, first tighten the upper bolts.
- Repeat on the right side.

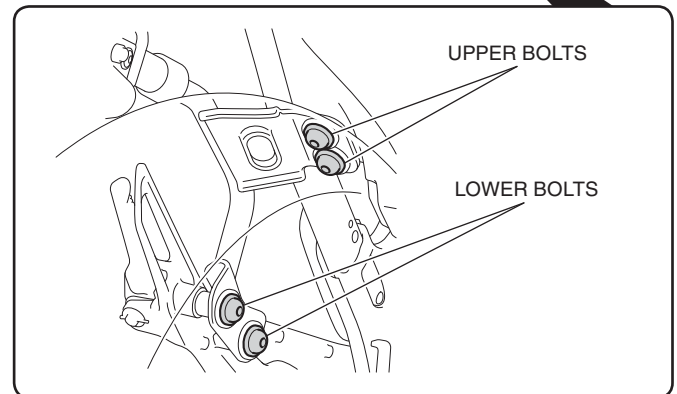
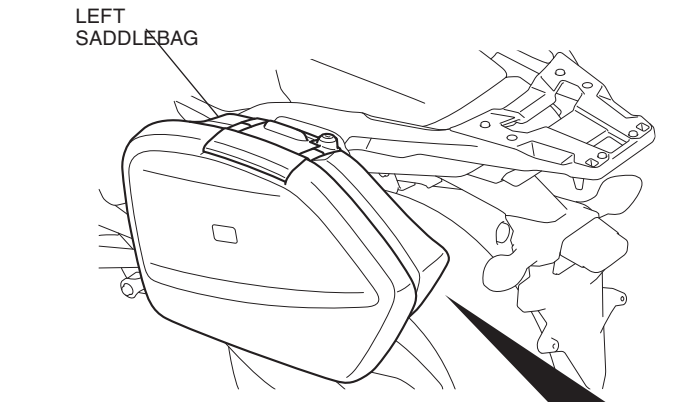

9. Install the motorcycle's parts in the reverse order of removal.