

HONDA

INSTALLATION INSTRUCTIONS

Accessory
Dual Clutch Transmission
SHIFT PEDAL
P/N 08U70-MGH-J20

Application
VFR1200XD

Publication No.
MII 15640
Issue Date
April 2016

Honda Dealer: Please give a copy of these instructions to your customer.

PARTS LIST

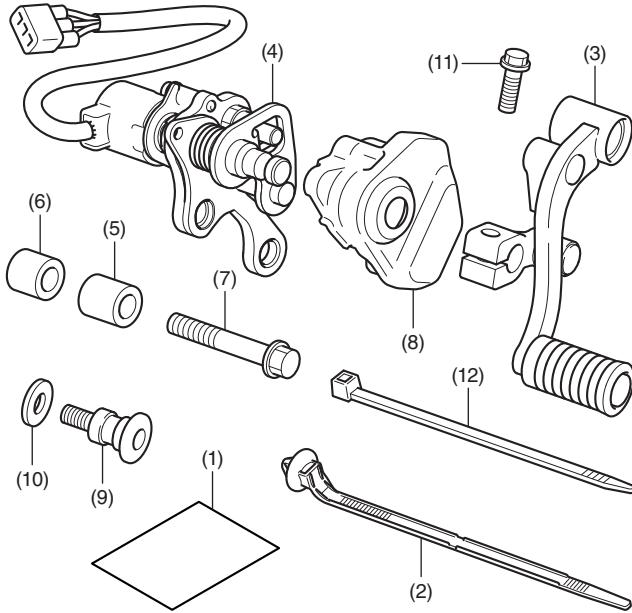

| No. | Description | Qty |
|------|------------------------------|-----|
| (1) | Installation Instruction URL | 1 |
| (2) | Wire tie clip | 1 |
| (3) | Gear change pedal | 1 |
| (4) | Gear change switch | 1 |
| (5) | Collar (long) | 1 |
| (6) | Collar (short) | 1 |
| (7) | 10 mm flange bolt | 2 |
| (8) | Shift cover | 1 |
| (9) | Pivot bolt | 1 |
| (10) | Washer | 1 |
| (11) | 6 mm flange bolt | 1 |
| (12) | Wire tie | 3 |

TOOLS AND SUPPLIES REQUIRED

Socket (10 and 14 mm)
Ratchet
Hex wrench (6 mm)
Side cutters
Marker
Ruler
Grease
Torque wrench

TORQUE CHART

Tighten all screws, bolts, and nuts to their specified torque values. Refer to the Service Manual for the torque values of the removed parts.

| Item | N-m | kgf-m | lbf-ft |
|-------------------|-----|-------|--------|
| 6 mm flange bolt | 10 | 1.0 | 7 |
| Pivot bolt | 22 | 2.2 | 16 |
| 10 mm flange bolt | 39 | 4.0 | 29 |

<Notes regarding the Gear change switch>

- The shift pedal angle sensor is factory pre-set. Do not disassemble it.
- Do not loosen or tighten the white painted screws as doing so can cause shift pedal angle sensor malfunction.

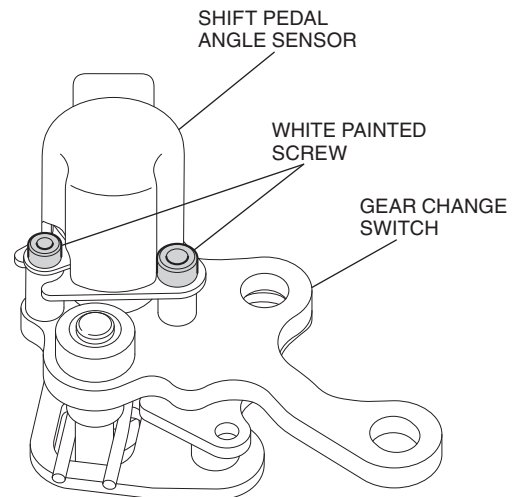

INSTALLATION

⚠ CAUTION

- To prevent burns, allow the engine, exhaust system, radiator, etc., to cool before installing the accessory.

NOTE:

- Do not disassemble the gear change switch.
 - Disconnect the negative (-) cable from the battery before installing this accessory.
 - The clock will be erased when you disconnect the battery. Reset the clock after reconnecting the battery.
 - Reinstall the removed parts on the motorcycle and make sure that the wires and harnesses are not pinched.
 - Trim the excess ends off the wire ties after attaching them to the wire harnesses. Do not allow the cut part of the wire tie to interfere with another harness or brake hose.
 - A Registration procedure is necessary to be performed after installing this accessory.
1. Remove the seat, and disconnect the negative (-) battery cable.
 - **Support your motorcycle securely using a maintenance stand or a hoist.**

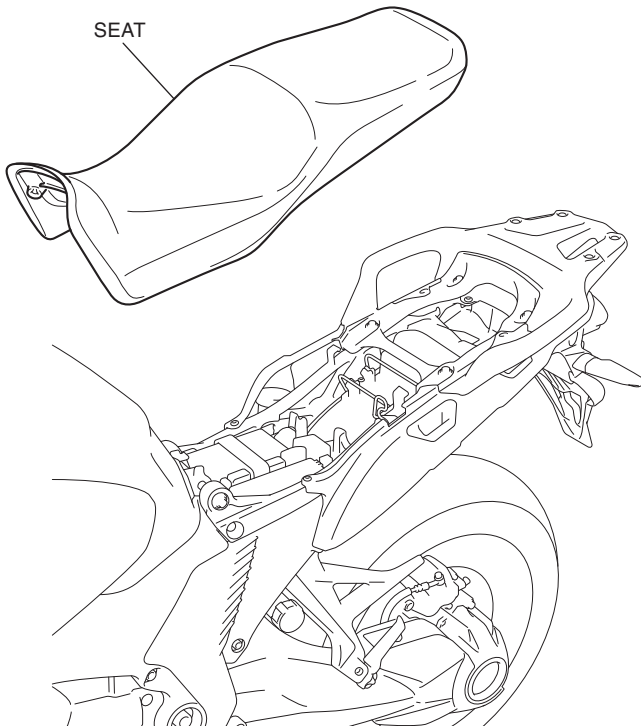

2. Remove the left under cowl and side gear case cover as shown.

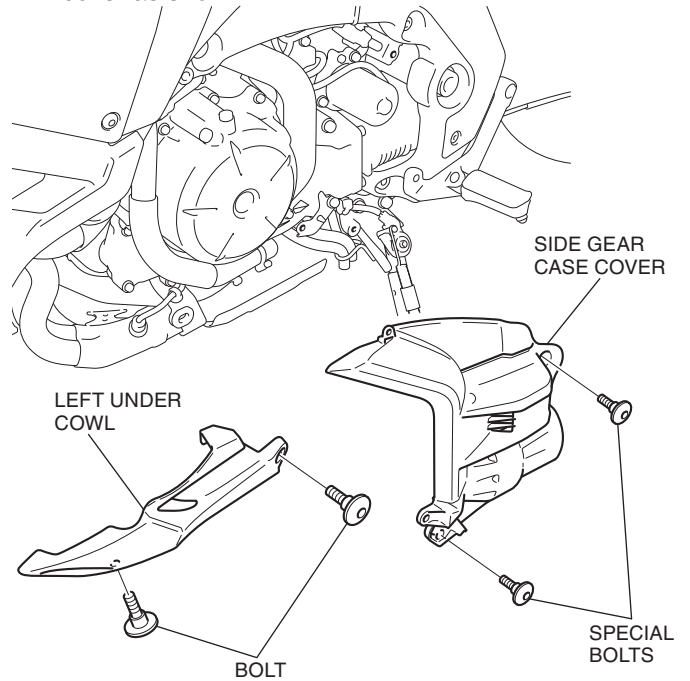

3. Remove the 3-pin waterproof dummy connector as shown.

<Left side>

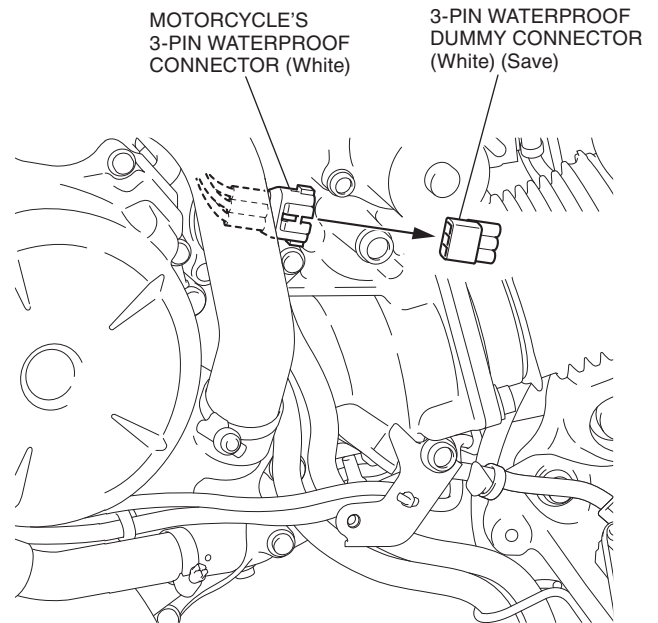

4. Install the shift cover on the gear change switch as shown.

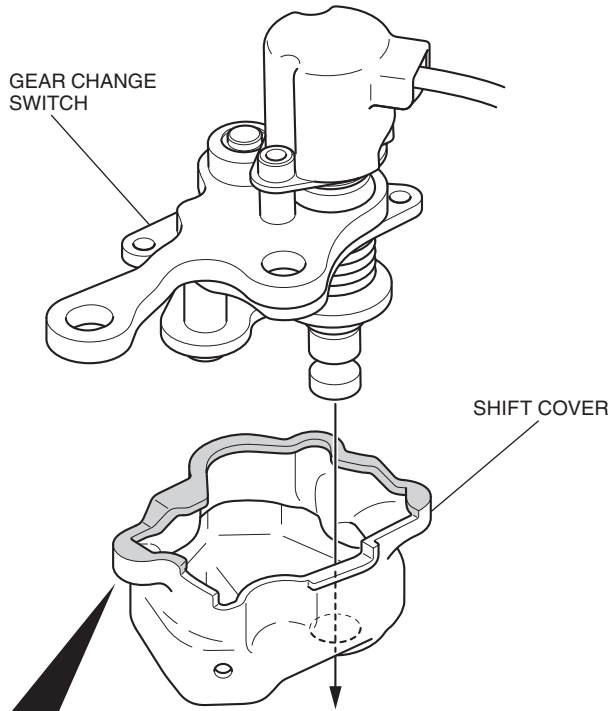

Place the  area of shift cover on the gear change switch.

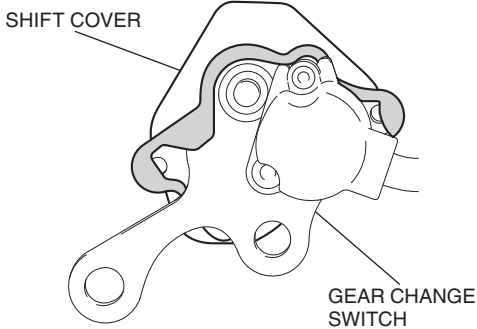

5. Remove the wire tie as shown.

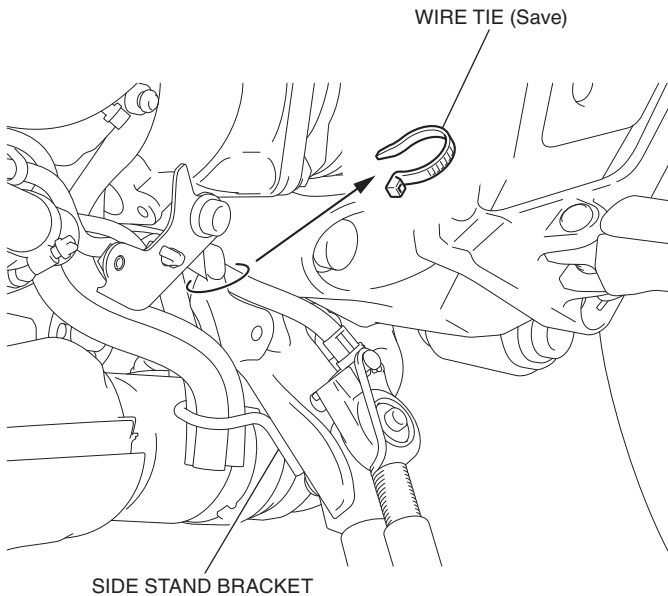

6. Remove the clip and put a mark on the side stand switch harness as shown.

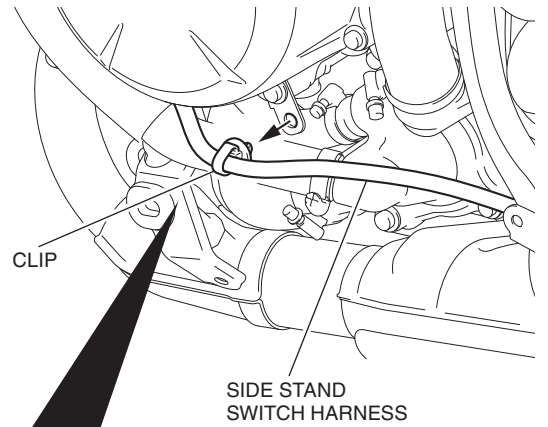

Measure then mark at the point shown.

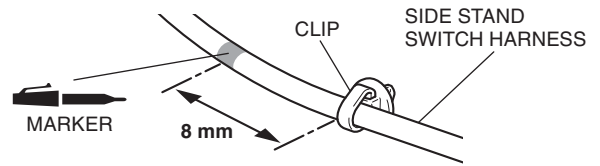

7. Remove the clip from the side stand switch harness as shown.

- Be careful not to damage the harness.

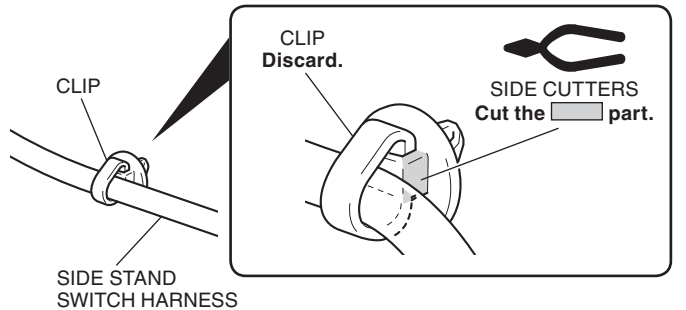

8. Install the new wire tie clip as shown.

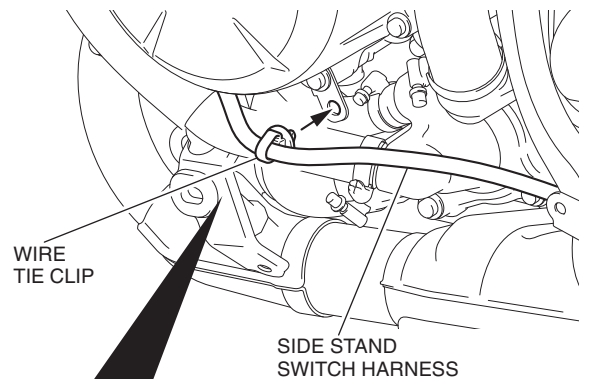

Install the wire tie clip on the marked position as shown.

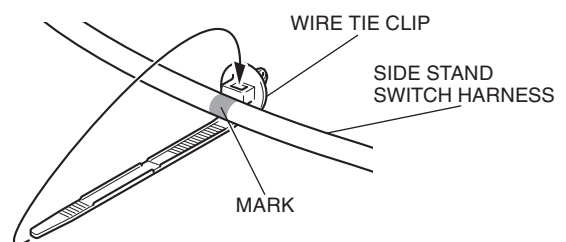

9. Remove the drain hoses and bolt from the side stand bracket. Remove the clip from the left step holder.

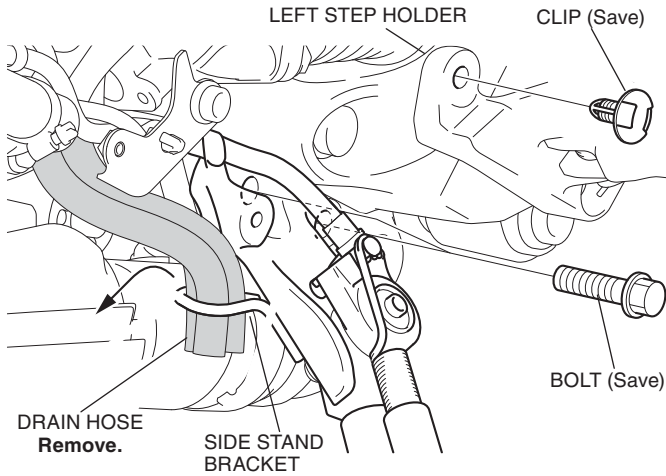

10. Assemble the gear change switch to the side stand bracket.

- To ease overall installation, loosely install the gear change switch to the side stand bracket.
- Be careful not to pinch the side stand switch harness.

SIDE STAND SWITCH HARNESS
Route around the side stand bracket hole.

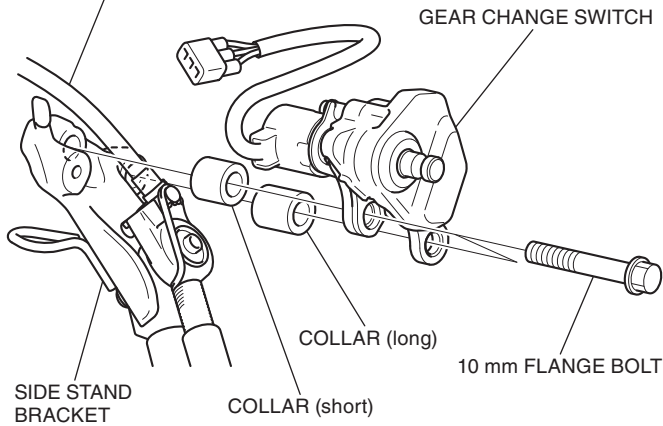

11. Secure the side stand switch harness in the position shown using a wire tie.

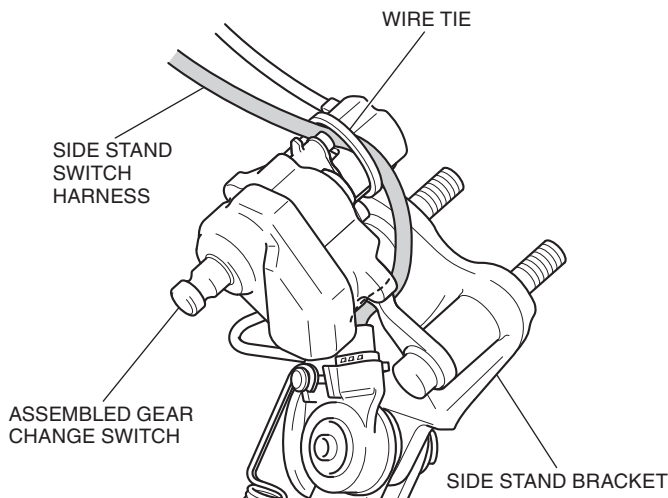

12. Install the assembled gear change switch as shown.

- Be careful not to pinch the side stand switch harness and gear change switch harness.

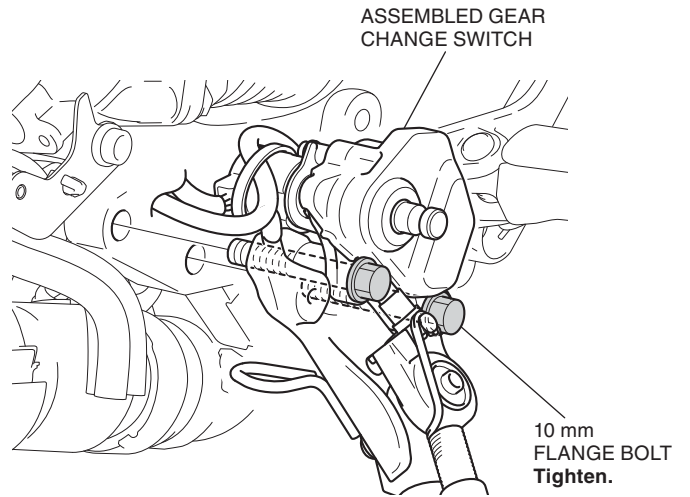

13. Route the gear change switch harness and connect it as shown.

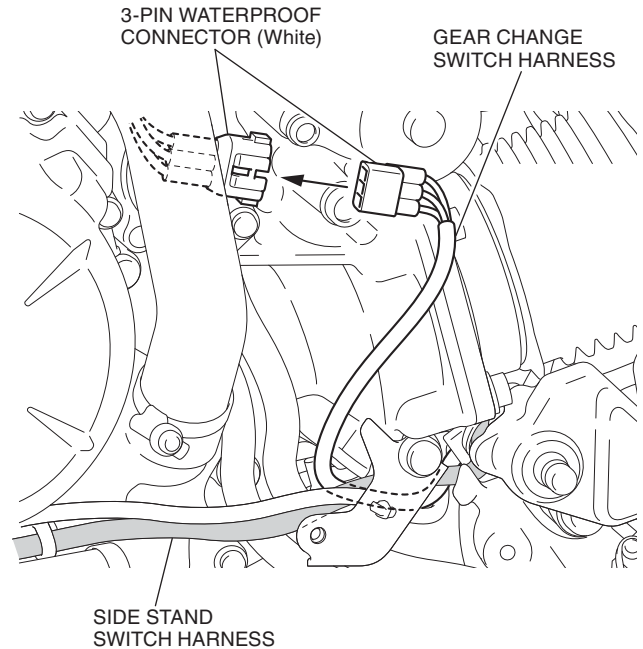

14. Secure the gear change switch harness in the position shown using a wire tie.

- **Route along the motorcycle's harness and secure it.**

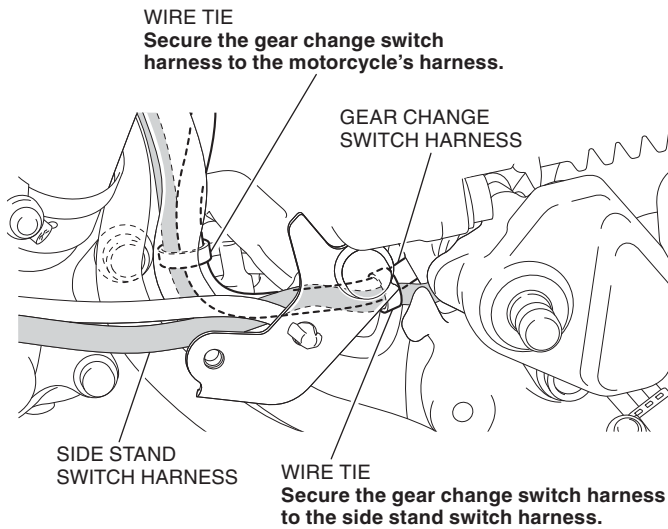

15. Reinstall the drain hose in reverse order of the removal.
16. Install the motorcycle's parts in the reverse order of removal.
17. Install the gear change pedal as shown.

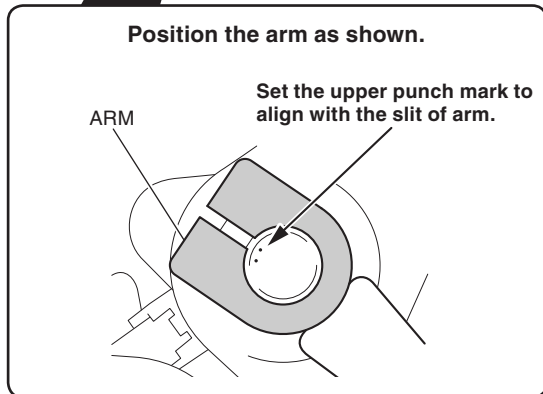
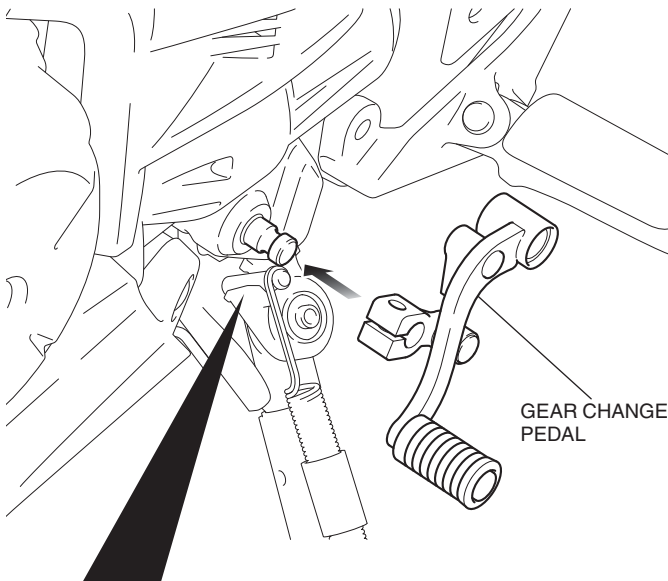

18. Secure the gear change pedal as shown.

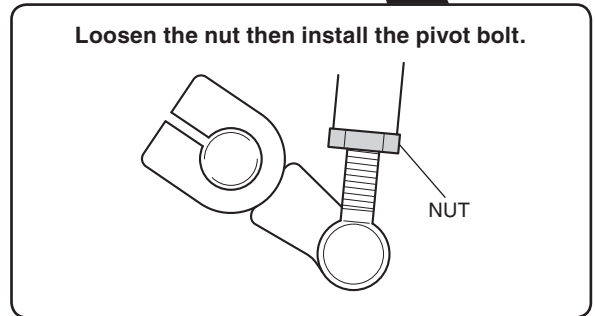
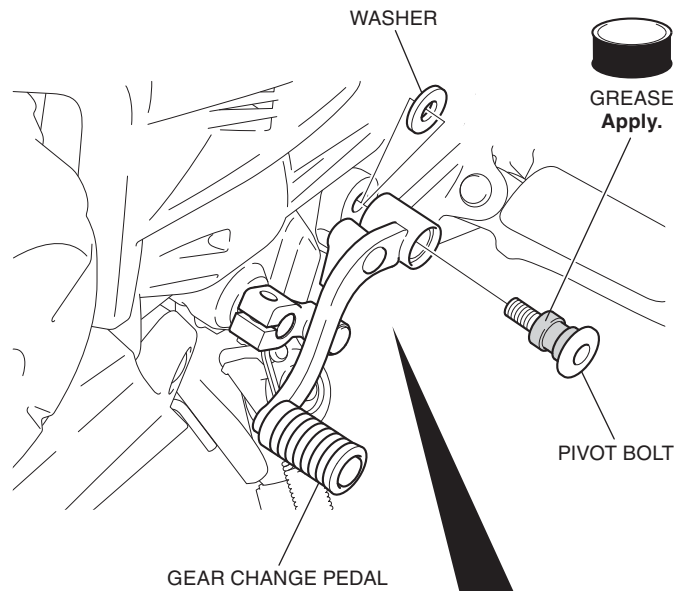

19. Tighten the loosened nut as shown.

- **Check that the gear change pedal operates smoothly.**
- **When changing the height of gear change pedal, refer to the GEAR CHANGE PEDAL HEIGHT ADJUSTMENT.**

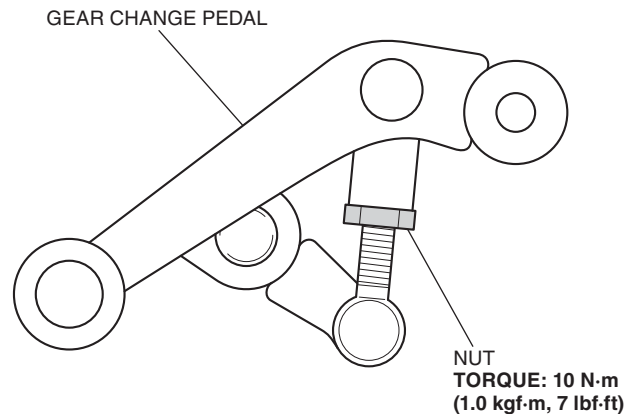

20. Install the 6 mm flange bolt as shown.

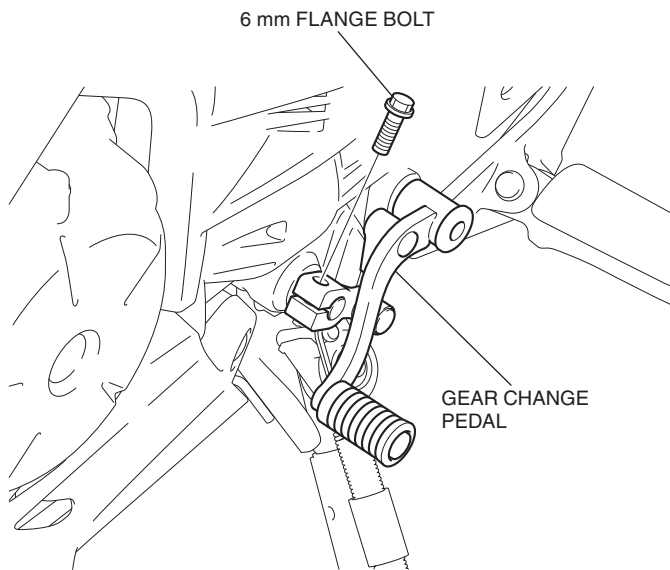

21. Refer to the registration procedure to register this accessory to the motorcycle.

GEAR CHANGE PEDAL HEIGHT ADJUSTMENT

Height adjustment is available for the gear change pedal. Adjust to the preferred position.

1. Remove the gear change pedal.
2. Loosen the nut to adjust the length of the rod within the available range as shown below.

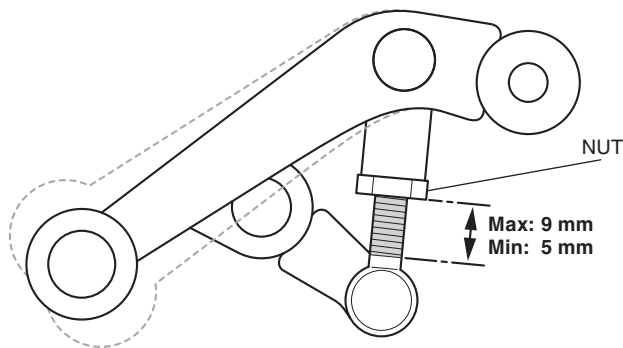

3. Install the gear change pedal in the reverse order of removal and tighten the nut.
4. Check that the gear change pedal operates smoothly.

REGISTRATION

- Check that this accessory is installed securely.
1. Turn the main switch to ON. The S gear shift indicator and D gear shift indicator blink at the same time after 2 seconds.
 - **Do not start the engine at this time.**
 - **Check that the transmission is in neutral.**

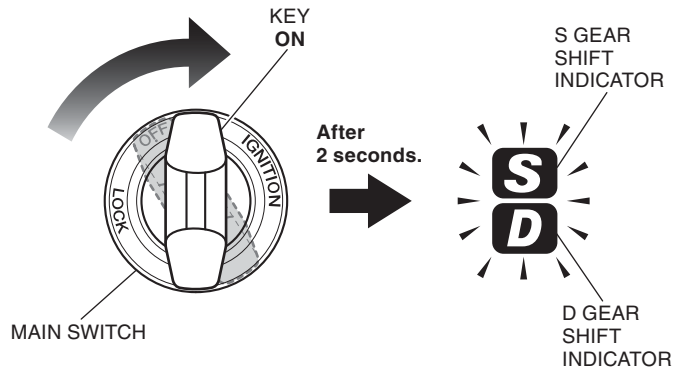

2. Operate the gear change pedal as shown.
 - **Start this procedure within 5 seconds after turning the ignition switch to ON.**

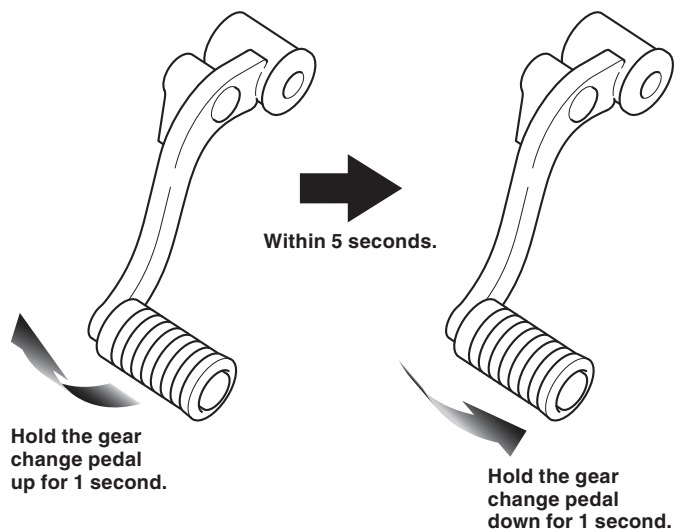

3. The S gear shift indicator and D gear shift indicator blink alternately one time after the registration is successfully completed.

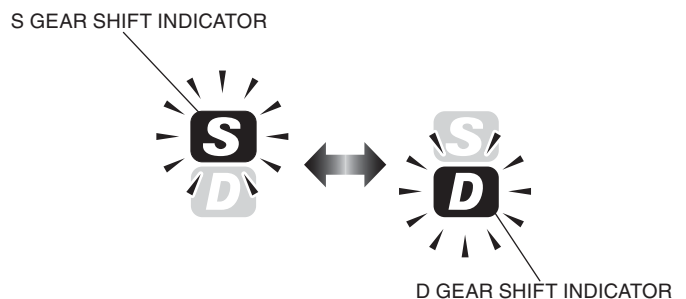

<If the gear shift indicator does not blink as described>

- **Registration is not complete. Turn the main switch to OFF and perform the registration procedure from step 1.**

4. Turn the main switch to OFF.

DEREGISTRATION

- Deregistration is necessary after removing this accessory.
1. Remove this accessory.
 2. Turn the main switch to ON while pressing the shift up switch and shift down switch at the same time as shown.
 - **Do not start the engine at this time.**
 - **Check that the transmission is in neutral.**

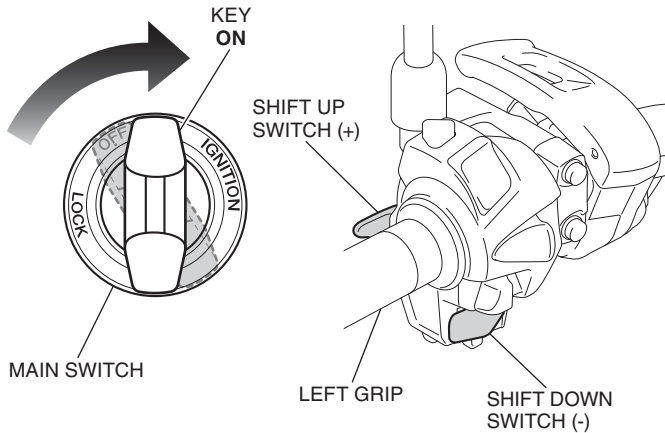

3. The S gear shift indicator and D gear shift indicator blink at the same time.
 - **Continue pressing the switches.**

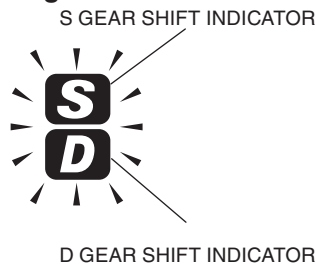

4. S gear shift indicator and D gear shift indicator blink alternately one time 5 seconds after deregistration is successfully completed.

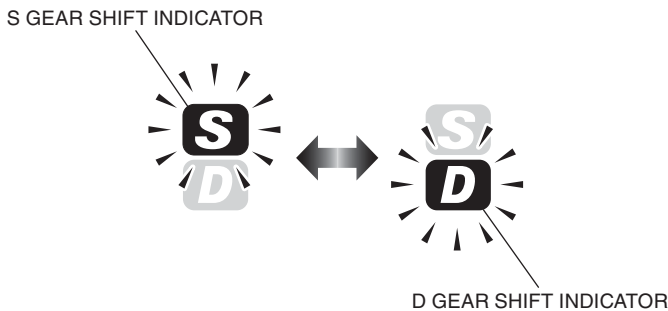

<If the gear shift indicator does not blink as described>

- **Deregistration is not completed properly. Turn the main switch to OFF and perform the deregistration procedure from step 2.**
5. Turn the main switch to OFF.