

HONDA

INSTALLATION INSTRUCTIONS

Accessory
12V ACCESSORY SOCKET
P/N 08U70-MJM-D00

Application
VFR800F/D

Publication No.
MII 14983
Issue Date
June 2014

PARTS LIST

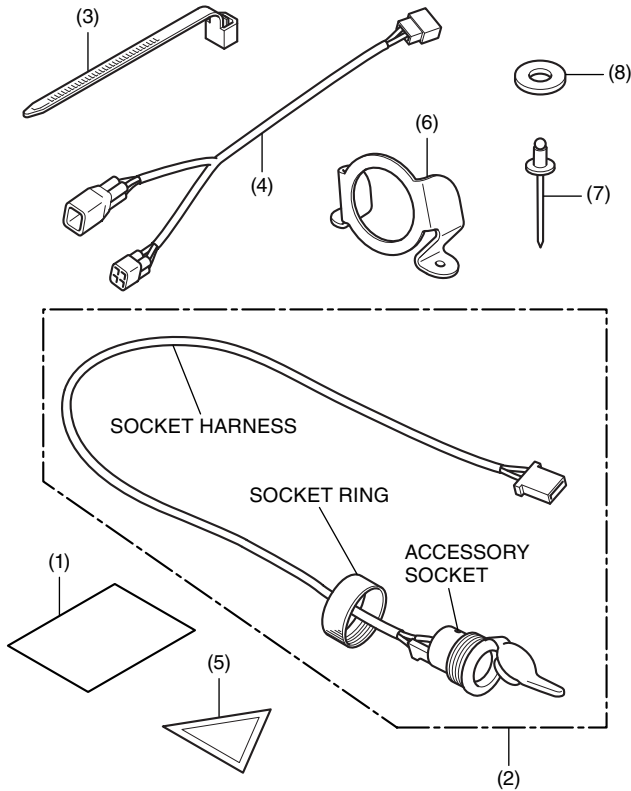

No.	Description	Qty
(1)	Installation Instruction URL	1
(2)	Socket assy.	1
(3)	Wire tie	1
(4)	Sub harness	1
(5)	Safety label	1
(6)	Accessory socket bracket	1
(7)	Rivet	4
(8)	Washer	4

SUPPLIES REQUIRED

Side cutters
Ruler
Electrical tape
Rivet tool
Electric drill
3.5 mm drill bit (9/64 in)
Isopropyl alcohol
Shop towel

TORQUE CHART

Refer to the Service Manual for the torque values of the removed parts.

INSTALLATION

NOTE:

- Heat the bonding surfaces with a hair dryer if the ambient air temperature is below 70°F (21°C).
- The adhesive reaches full strength in 72 hours. Wait at least 24 hours before riding your motorcycle.
- Disconnect the negative (-) cable from the battery before installing this accessory.
- The clock memory will be erased when you disconnect the battery. Reset the clock after reconnecting the battery.
- Reinstall the removed parts on the motorcycle and make sure that the wires and harnesses are not pinched.
- Trim the excess ends off the wire ties after attaching them to the wire harnesses. Do not allow the cut part of the wire tie to interfere with another harness or brake hose.

1. Remove the main seat and passenger seat as shown.

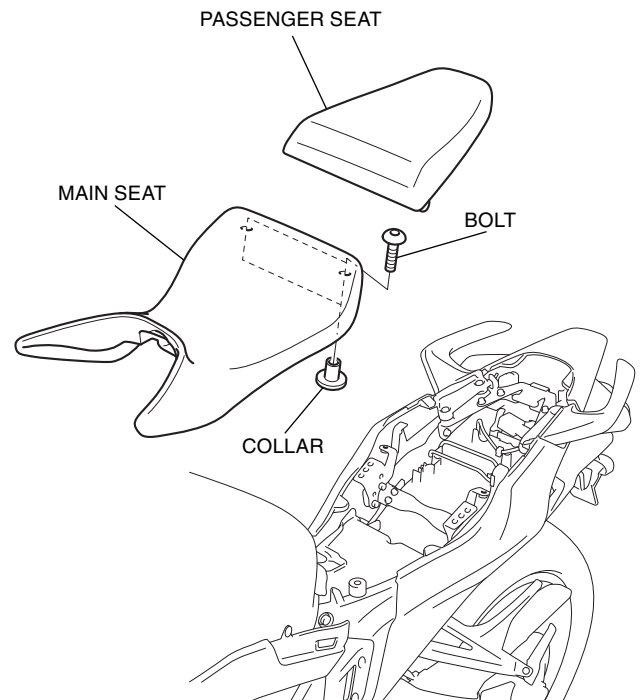

- Remove the battery cover and disconnect the negative (-) terminal of the battery as shown.

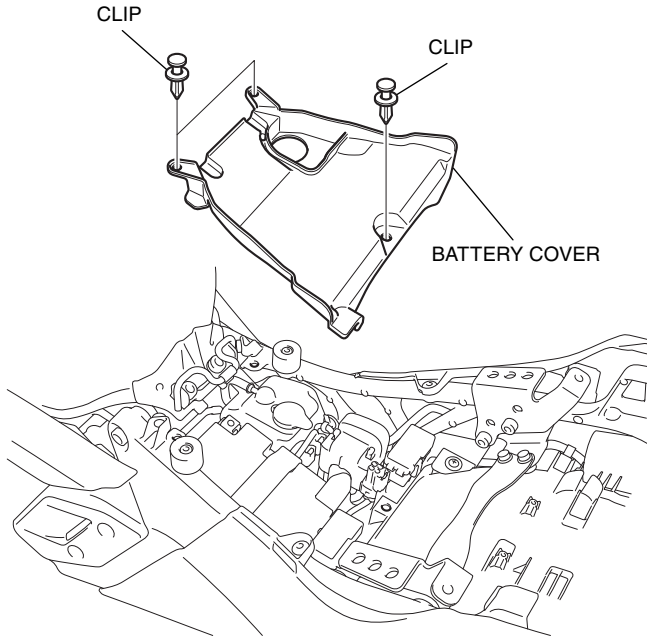

- Remove the connectors as shown.

<Left side>

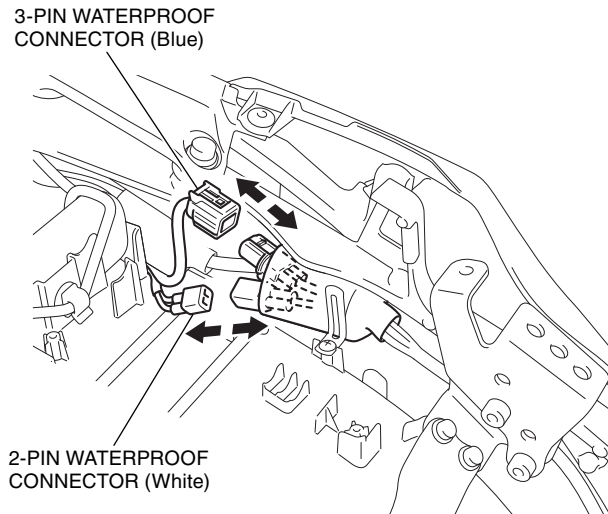

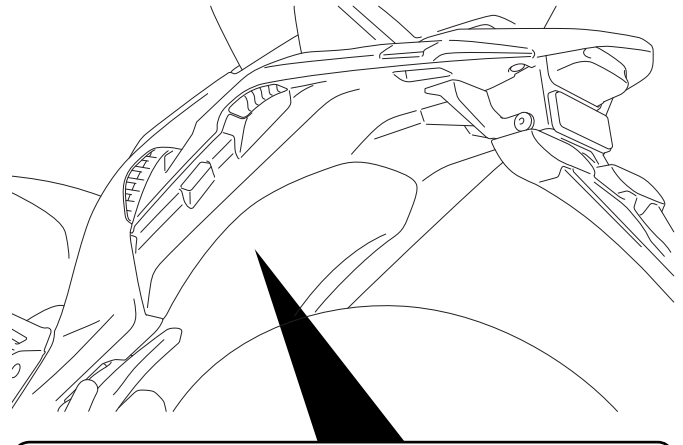

- Drill holes in the recess as shown.
 - Be careful not to damage the harness.
 - Remove any burrs from the edge of the hole.

<Rear side>

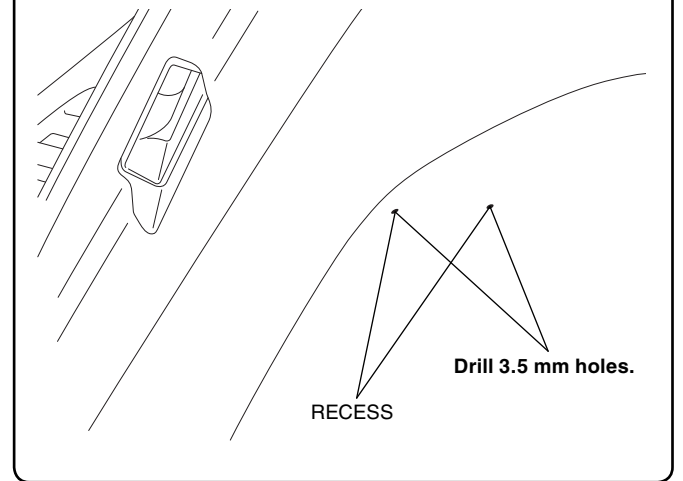

<Backside of the rear fender>



- Return the connectors to their original positions.
 - Secure the  part of the connector with the clamp.

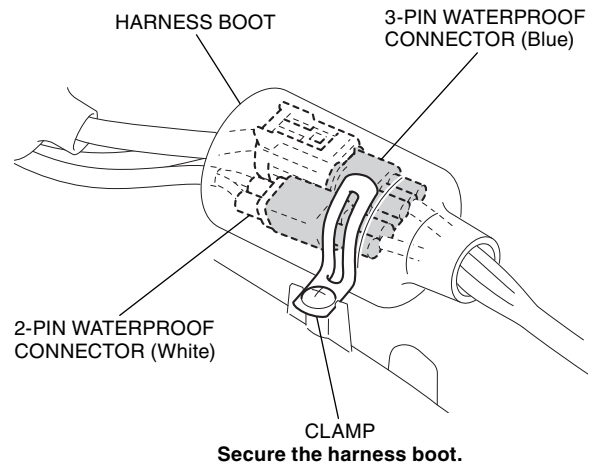

6. Install the accessory socket bracket as shown using two washers and two rivets.

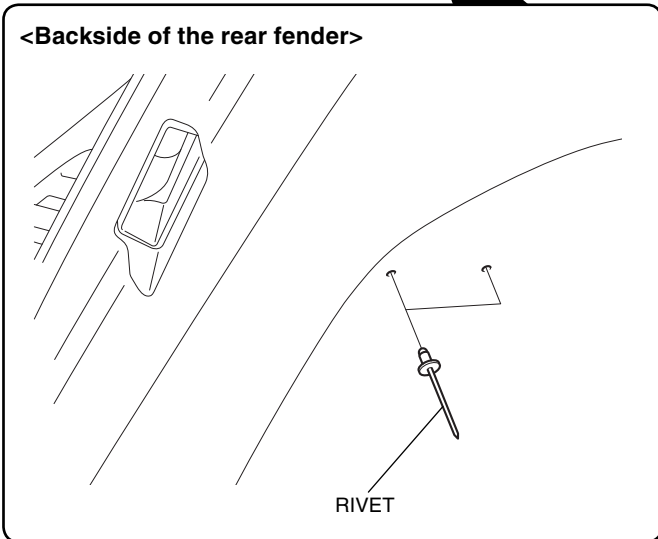
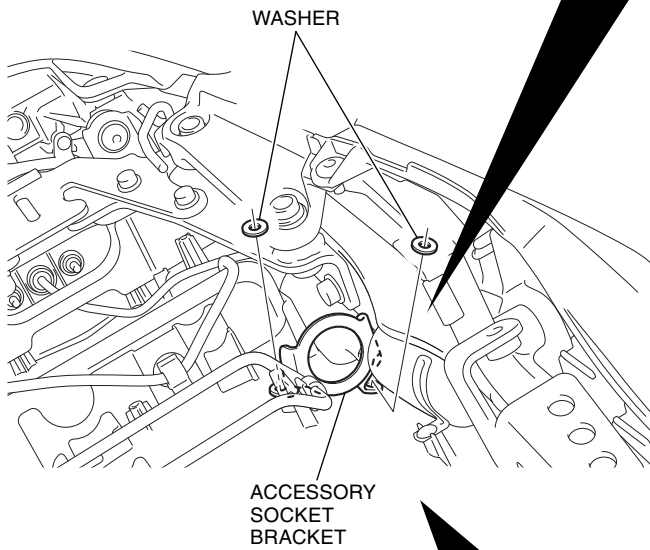
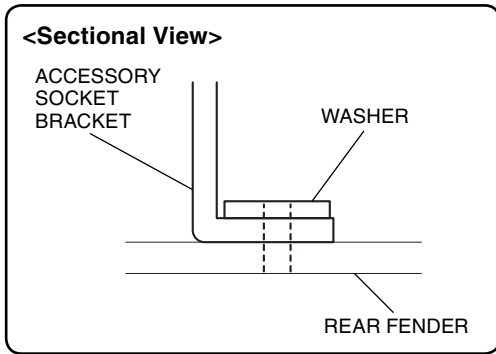

7. Install the accessory socket to the accessory socket bracket as shown.

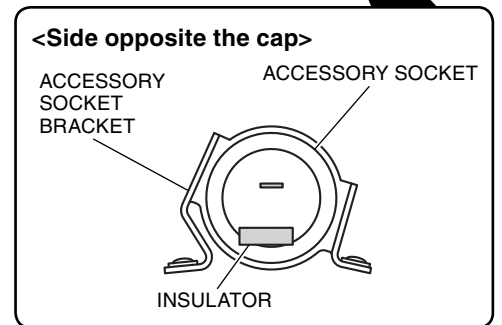
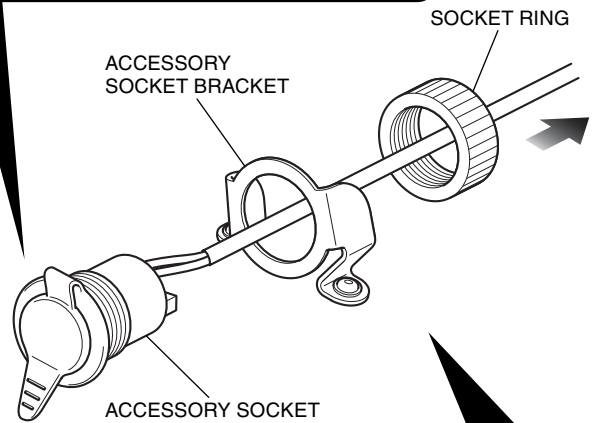
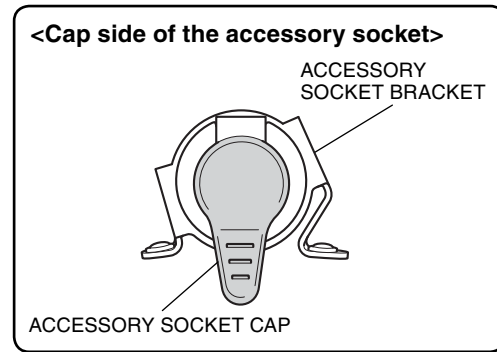

8. Attach the safety label as shown.

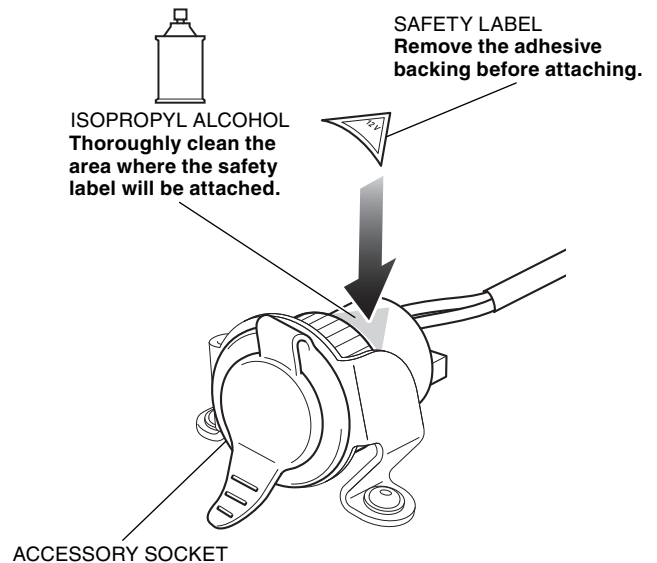

9. Route the socket harness as shown.

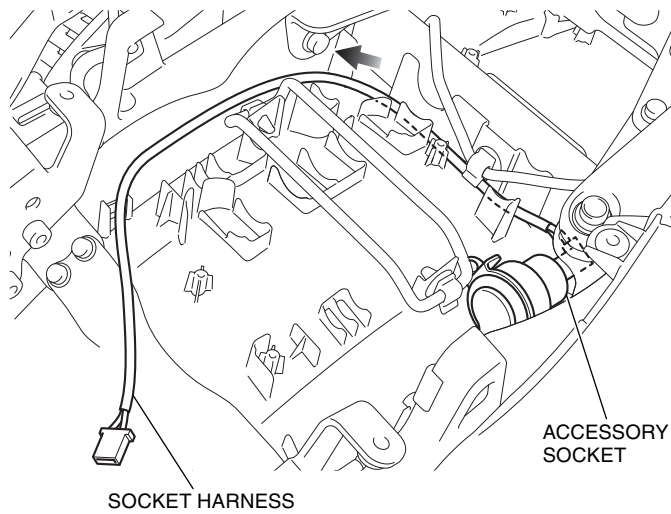

10. Remove the connector as shown.

<Left side>

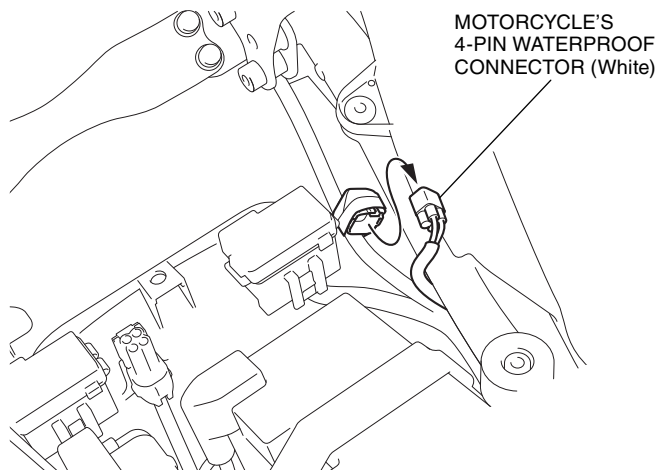

11. Connect the sub harness as shown.

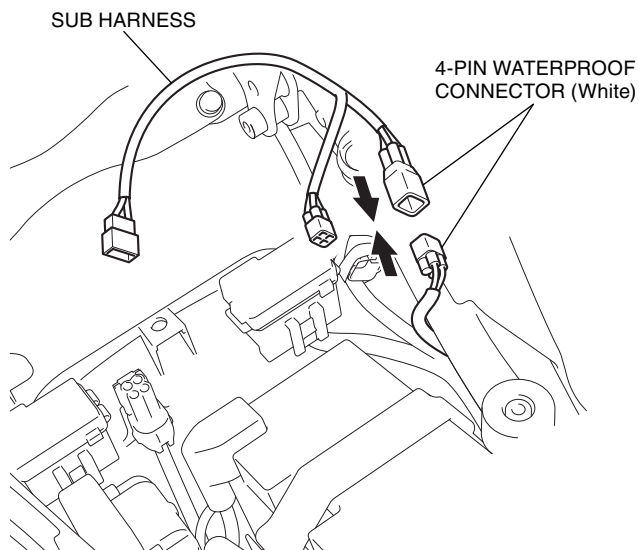

12. Connect the sub harness as shown.

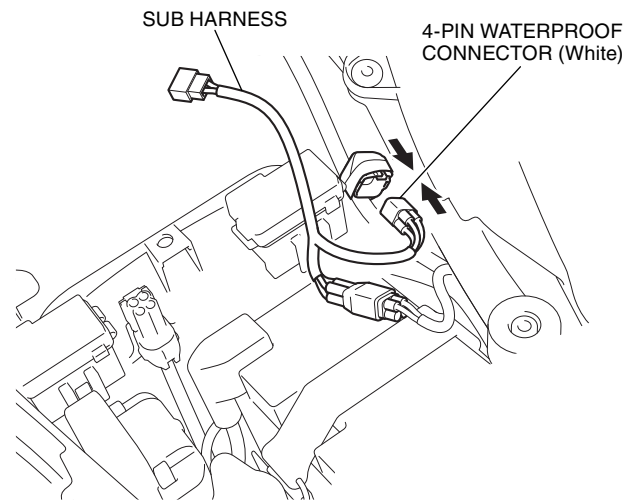

13. Route and connect the socket harness as shown.

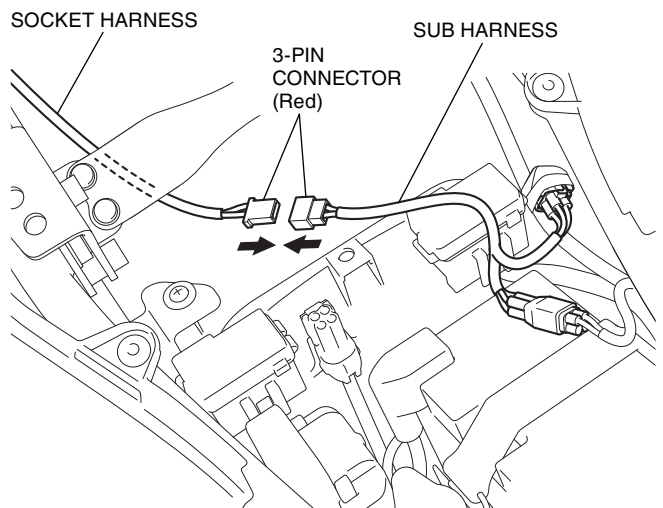

14. Secure the connected connector with electrical tape as shown.

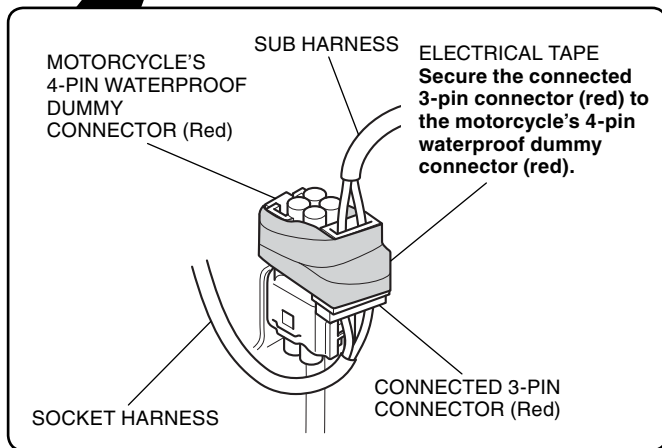
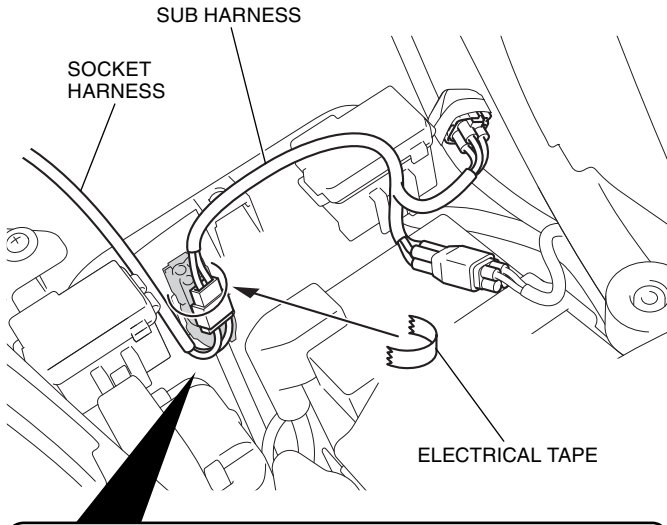

15. Stow the connected harnesses in the position shown.

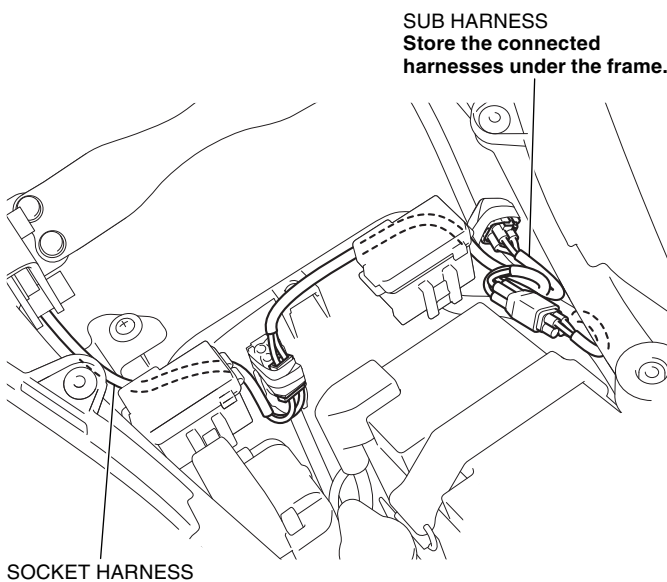

16. Bundle the socket harness with the wire tie as shown.

<Right side>

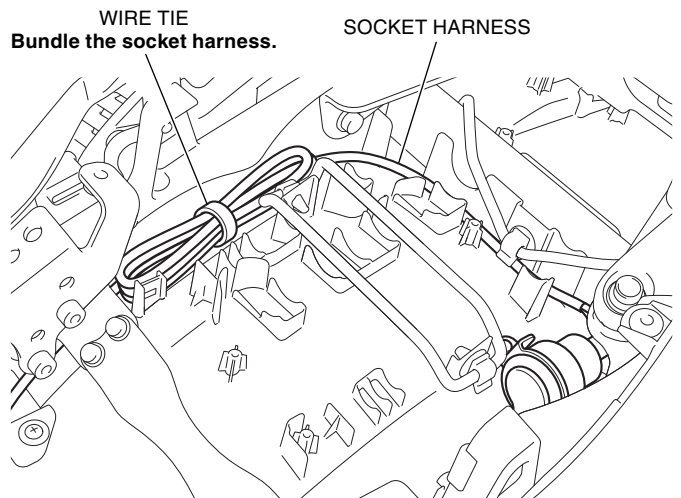

17. Install the motorcycle's parts in the reverse order of removal.

- Confirm that no wire harness is caught or too tight.