



INSTALLATION INSTRUCTIONS

Accessory

REAR TRUNK, 35 Liter
P/N 08L77-MGS-A50ZA
P/N 08L77-MGS-A51ZA

Application

COMMON

Publication No.

MII 14198

Issue Date

Revised August 2016

Honda Dealer: Please give a copy of these instructions to your customer.

PARTS LIST

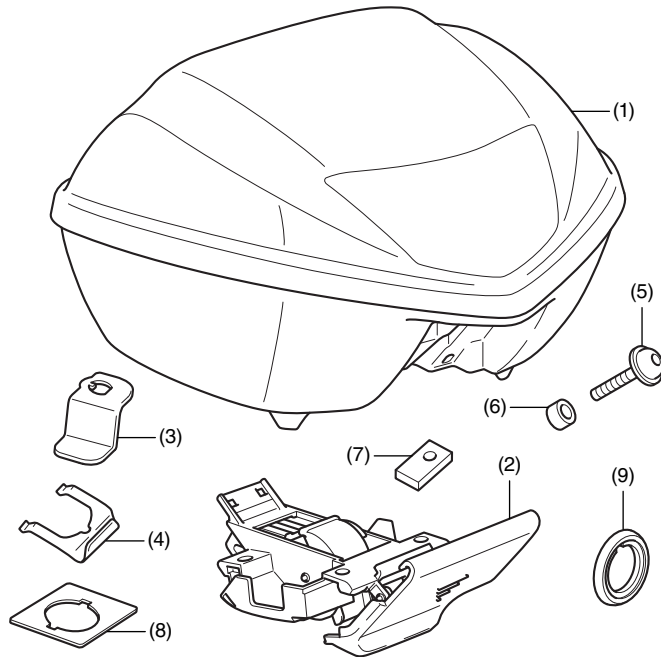

No.	Description	Qty
(1)	Rear trunk	1
(2)	Lock assembly	1
(3)	Cam plate	1
(4)	Spring	1
(5)	6 mm socket bolt	4
(6)	Collar	4
(7)	Nut	4
(8)	Lock washer	1
(9)	Spacer	1

INNER CYLINDER SET

Sold separately

<1 KEY BODY PARTS>

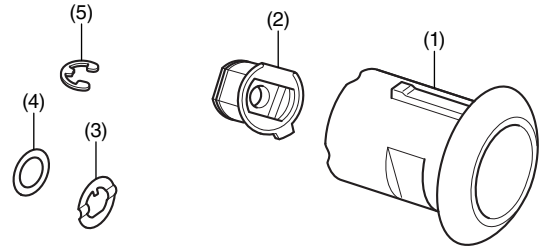

<1 KEY INNER CYLINDER>

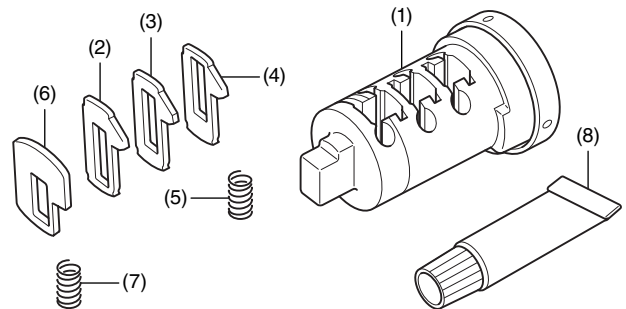

1 KEY BODY PARTS

No.	Description	Qty
(1)	Cylinder body	1
(2)	Inner joint	1
(3)	Set ring	1
(4)	Washer	1
(5)	E-ring	1

1 KEY INNER CYLINDER

No.	Description	Qty
(1)	Inner cylinder	1
(2)	Tumbler A (Gold)	5
(3)	Tumbler B (Silver)	5
(4)	Tumbler C (Gold)	5
(5)	Spring (Silver)	10
(6)	Stopper tumbler	3
(7)	Stopper spring (Black)	3
(8)	Grease	1

CARRIER BRACKET / REAR CARRIER

Sold separately

The items below are required for rear trunk installation.

- Carrier Bracket
- Rear Carrier

TOOLS AND SUPPLIES REQUIRED

Hex wrench (4 mm)

Long nose pliers

Torque wrench

TORQUE CHART

Tighten all screws, bolts, and nuts to their specified torque values. Refer to the Service Manual for the torque values of the removed parts.

Item	N·m	kgf·m	lbf·ft
6 mm socket bolt	10	1.0	7

USE AND CARE INFORMATION

- The weight of the cargo must not exceed the following maximum weight capacity:

Maximum Weight Capacity	
Rear trunk	6.6 lb (3.0 kg)

- Be sure that the rear trunk is installed securely before riding.
- The rear trunk is not perfectly watertight, and water may enter when washing the motorcycle or when it rains.
- Check the accessory mounts frequently and retighten if necessary.

< Notes regarding the key cylinder >

- This product is used to assemble a key cylinder matching the motorcycle key by combining three types of tumblers.
- When this key cylinder is installed in a box or similar equipment, the installed equipment can be operated with the motorcycle key.

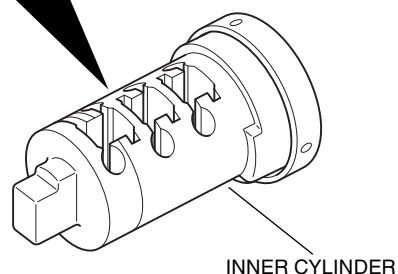
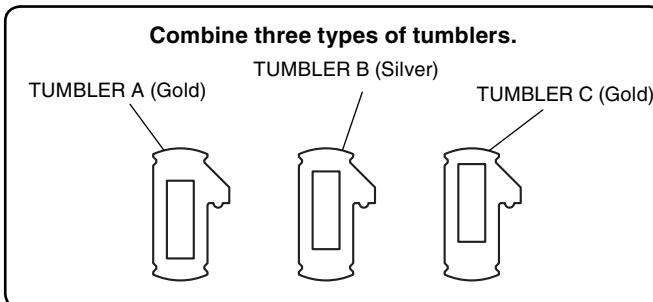

INSTALLATION

NOTE:

- The Inner cylinder set is required for installation of this accessory.
- For some models, the separately sold carrier bracket and rear carrier are needed. Use the applicable kit for each model.

1. The three tumbler types shown are provided.

- The  part has a different width for each of the three tumbler types.
- As the tumblers are small, keep them in the bag until they are used.

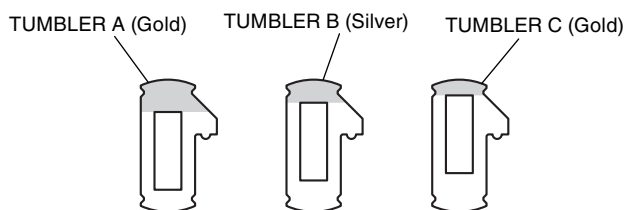

The stopper tumbler will be used later.

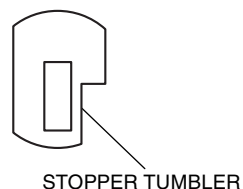

2. Install the tumblers and springs (silver) as shown.
 - **Install five tumblers of the same type.**

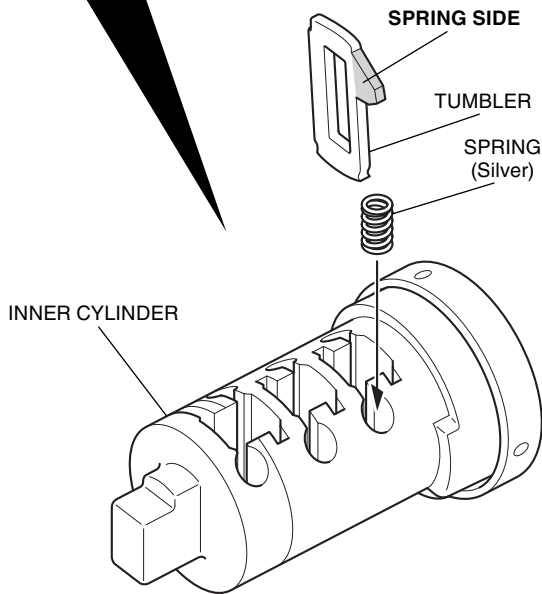
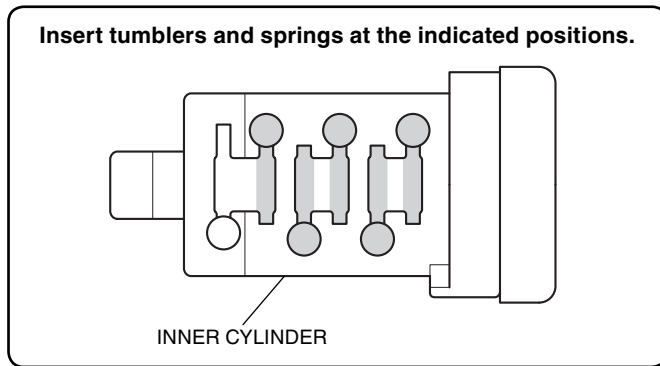

3. Insert the key as shown.
 - **Lightly push down on the tumblers from above, then insert the key.**

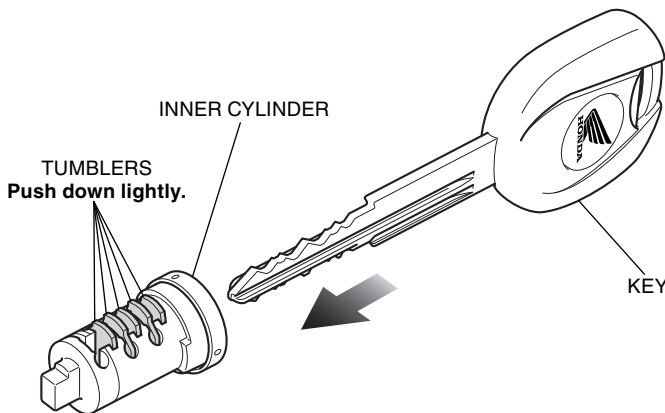

4. Confirm that some tumblers are projecting. Mark the positions of the projected tumblers.
 - **The positions where tumblers project and the projecting height differ according to the key.**

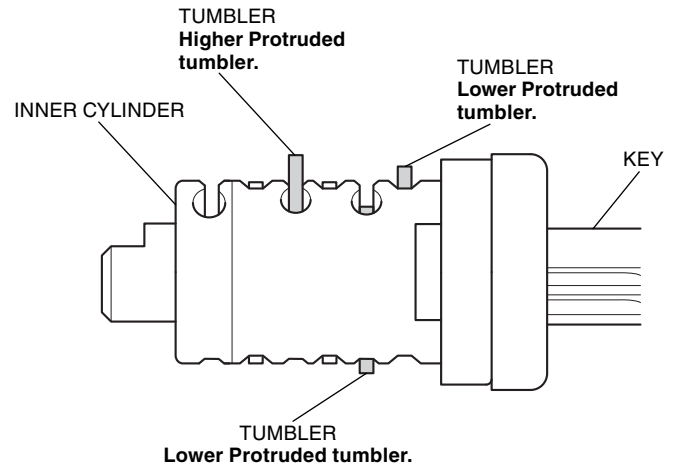

5. Press down lightly on the tumblers, pull the key out.
 - **The tumbler springs may jump out if the tumblers are not pressed down lightly.**

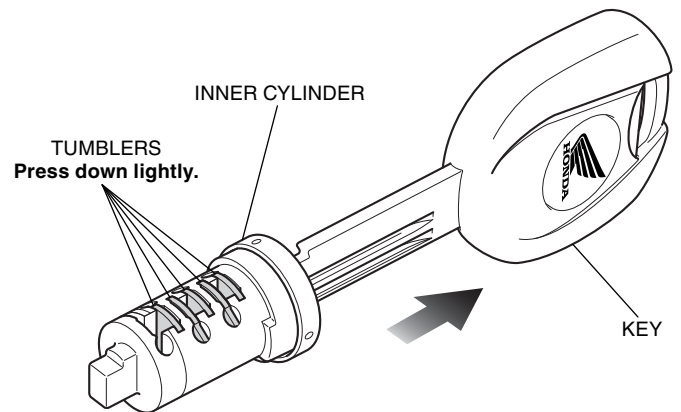

6. Pull out the projecting tumbler(s).
 - **Leave the spring(s) installed.**

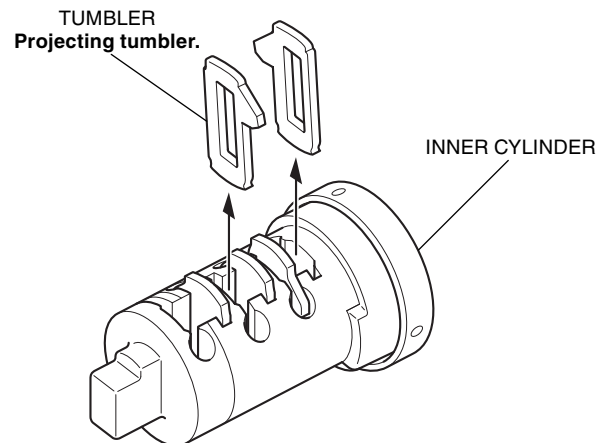

7. Insert a different tumbler(s) at the marked positions.

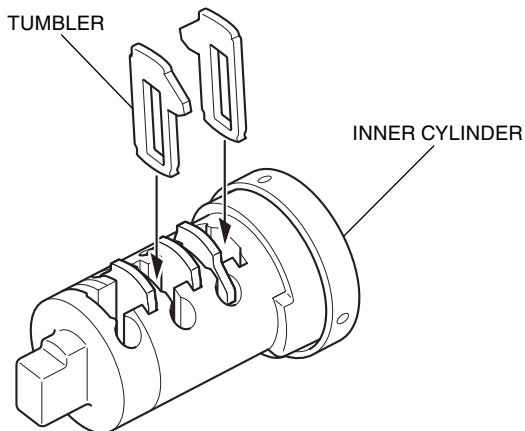

8. Repeat steps 3 to 7, inserting different tumblers at the marked positions until no tumblers are projected.

- Lightly push down on the tumblers from above, then insert the key.

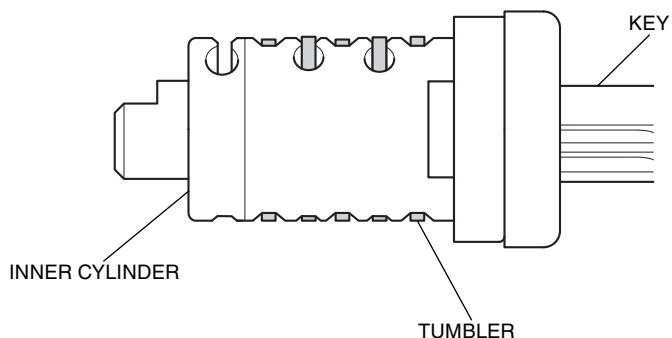

9. Insert the assembled inner cylinder into the cylinder body as shown.

- Confirm the inner cylinder turns clockwise smoothly.

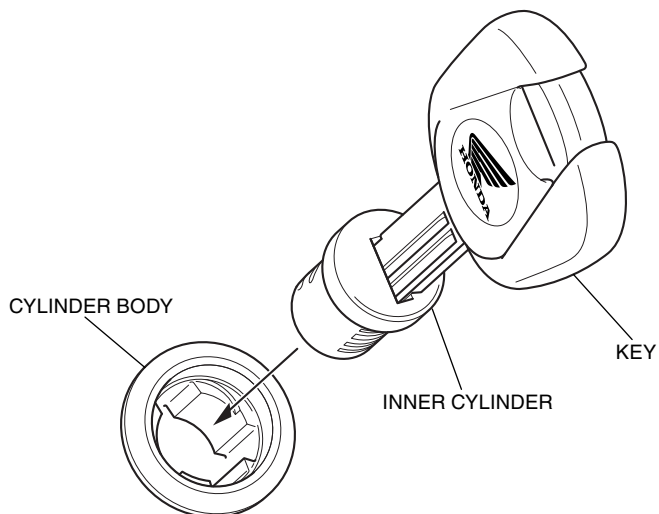

10. Pull out the inner cylinder.

11. Push down lightly on the tumblers and pull out the key.

12. Install the stopper tumbler and the stopper spring (black) as shown.

Insert the stopper tumbler and a stopper spring at the shaded position.

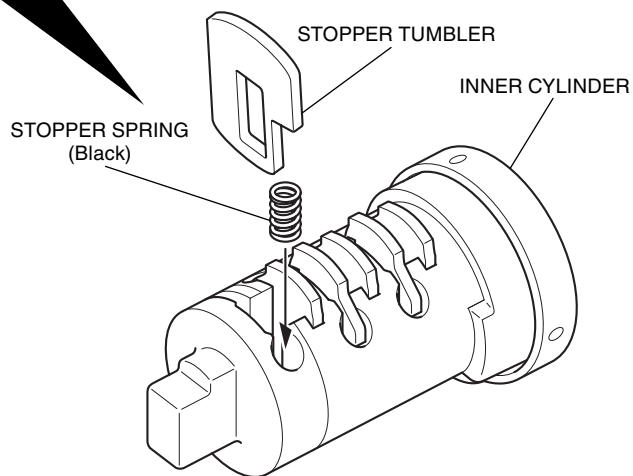
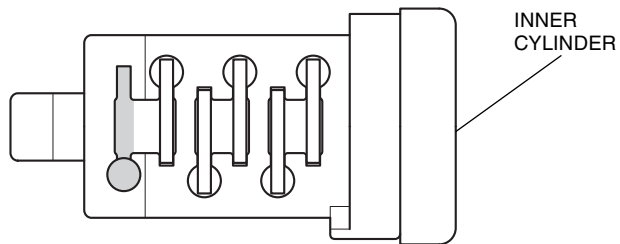

13. Insert the key as shown.

- Lightly push down on the tumblers from above, then insert the key.
- Confirm that the stopper tumbler jumps out.

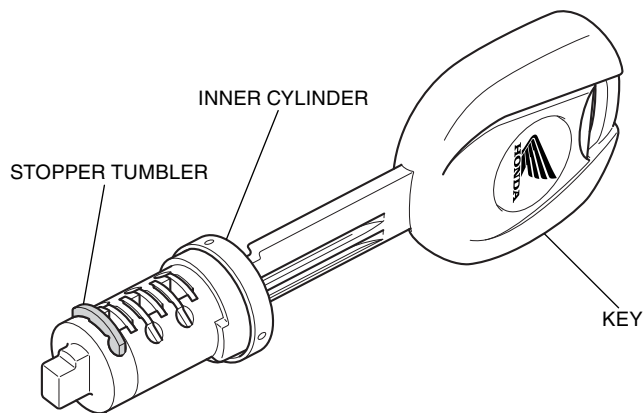

14. Apply grease to the shaded areas as shown.
- **Apply to the tumbler and to the outer circumference of the inner cylinder.**
 - **Only use the supplied grease.**

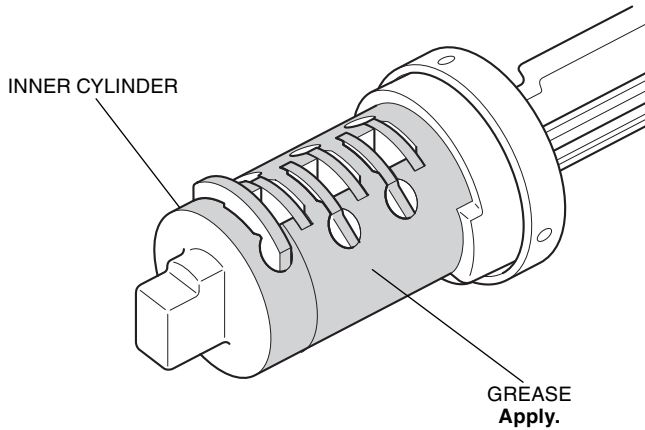

15. Install the inner joint in the cylinder body as shown.

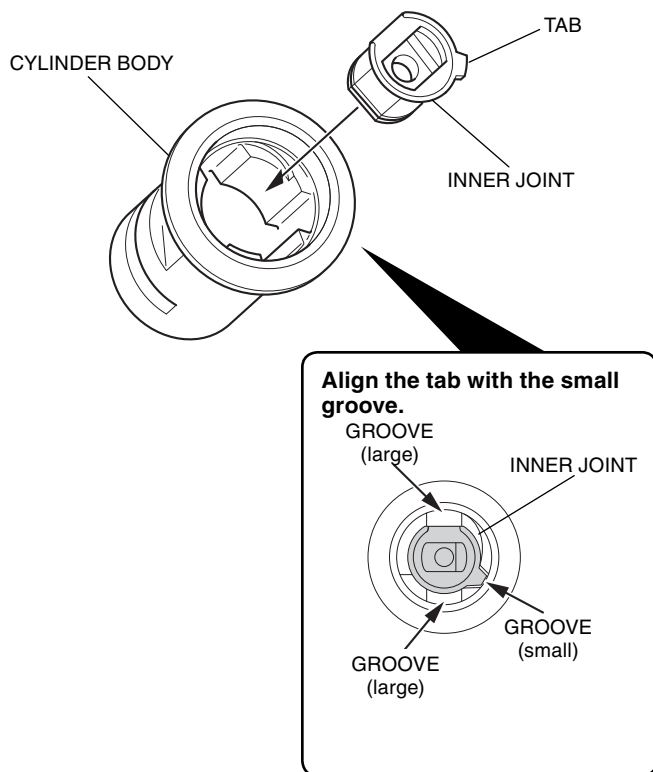

16. Install the inner cylinder by sliding the stopper tumbler along the slide guide while rotating it.
- **If the inner cylinder cannot be inserted, again confirm that no tumblers other than the stopper tumbler have jumped out.**

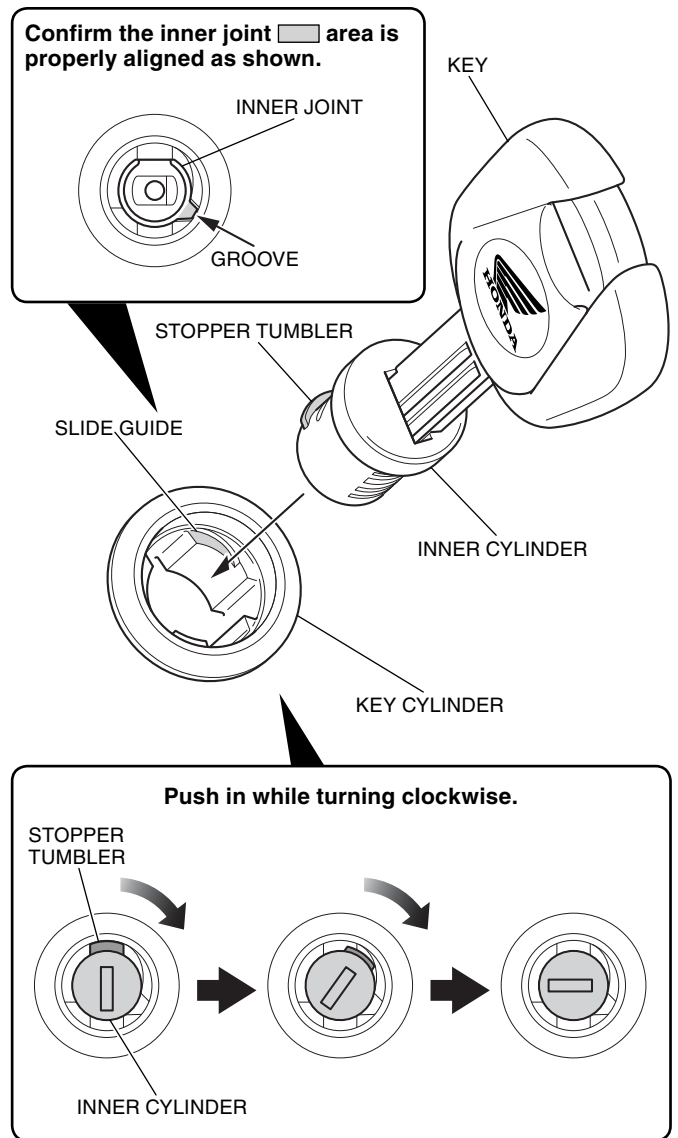

17. Draw out the key and check that the inner cylinder does not come out.

18. Install the spacer to the key cylinder assembly as shown.

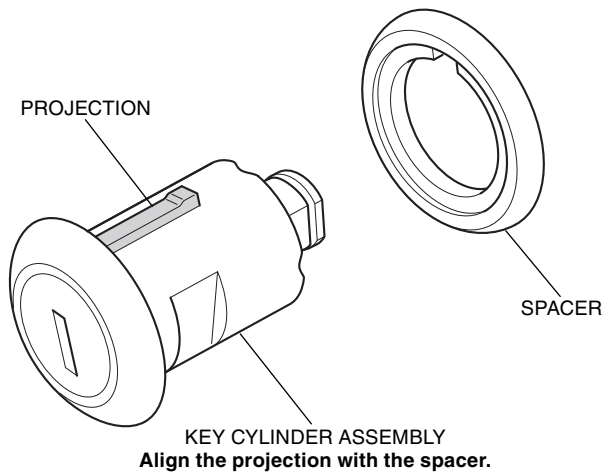

19. Insert the key and attach the assembled key cylinder to the lock assembly as shown.

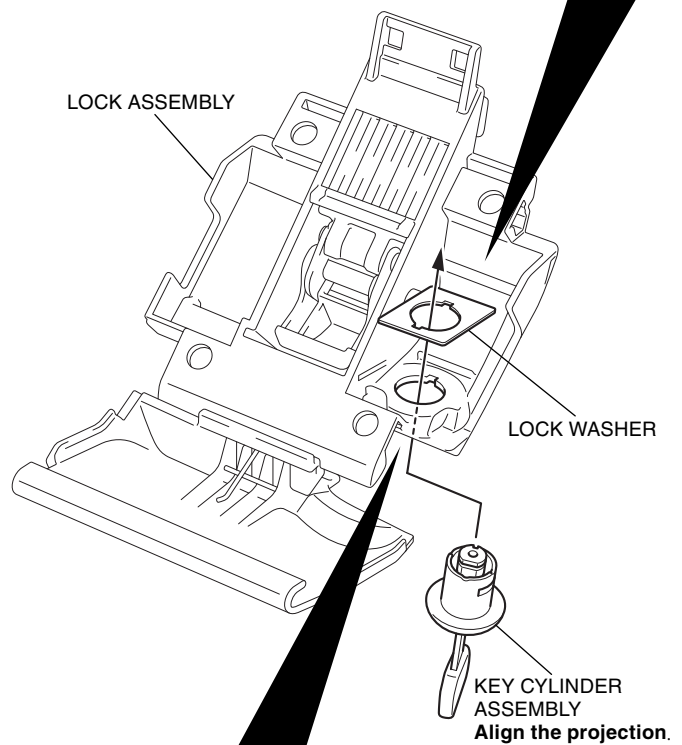
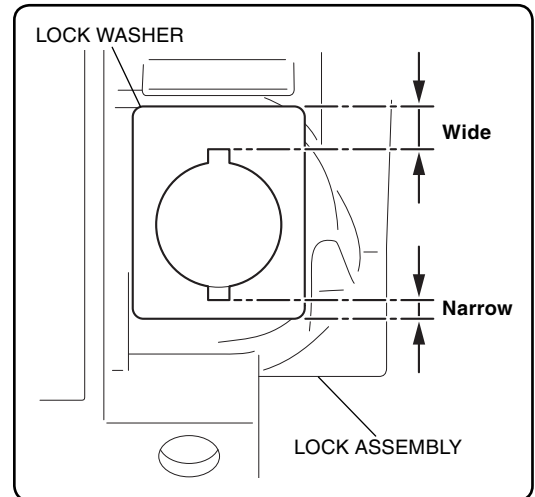

Install the spring while aligning the projection on the key cylinder with the cutout in the lock assembly as shown.

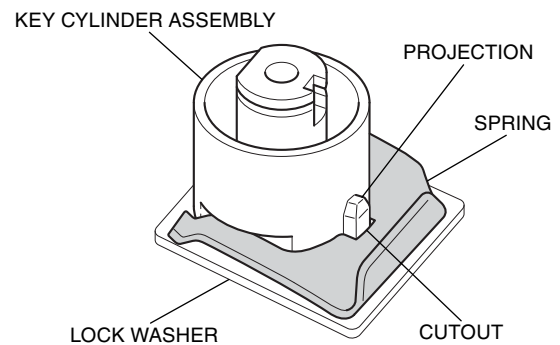

20. Install the set ring and washer as shown.

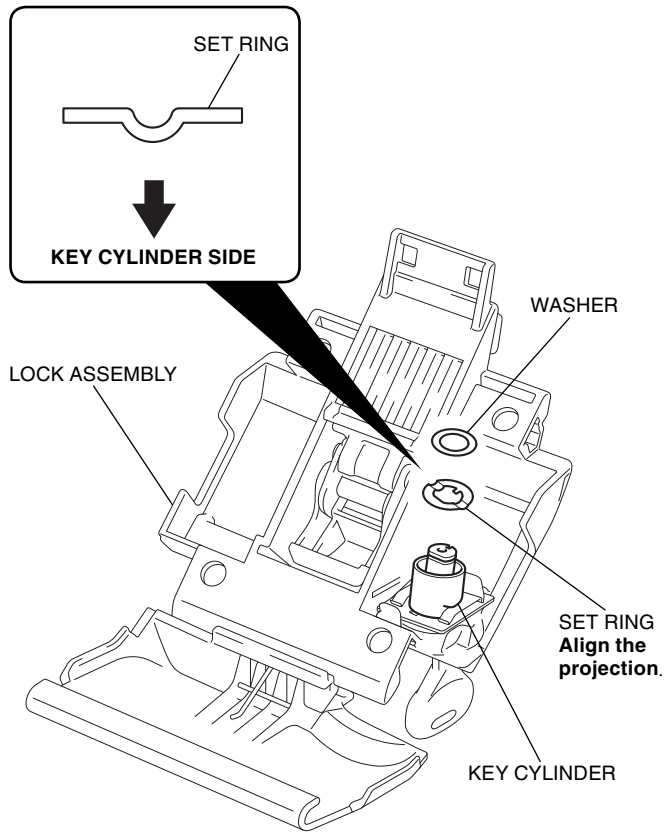

21. Turn the key in the direction shown.

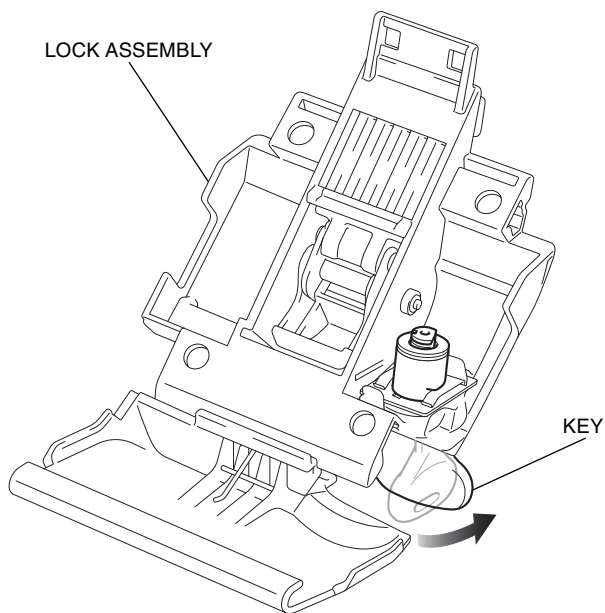

22. Install the cam plate and e-ring as shown.

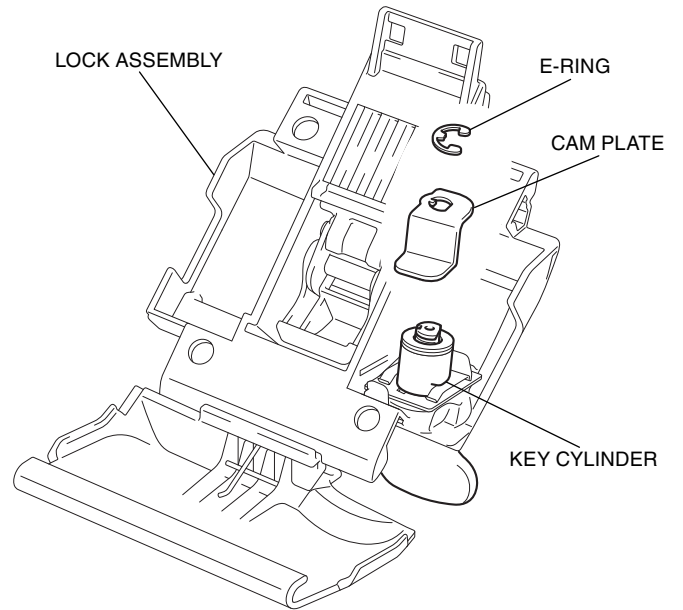

23. Install the 6 mm nuts as shown.

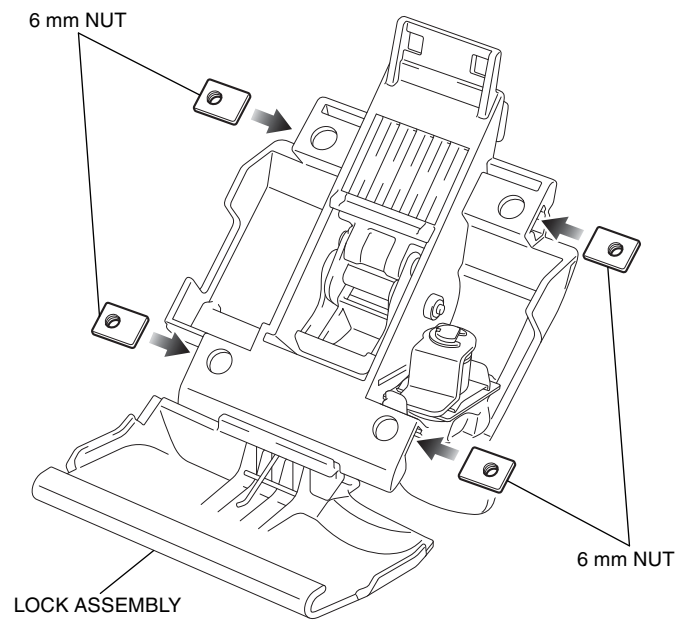

24. Lower the lever as shown.

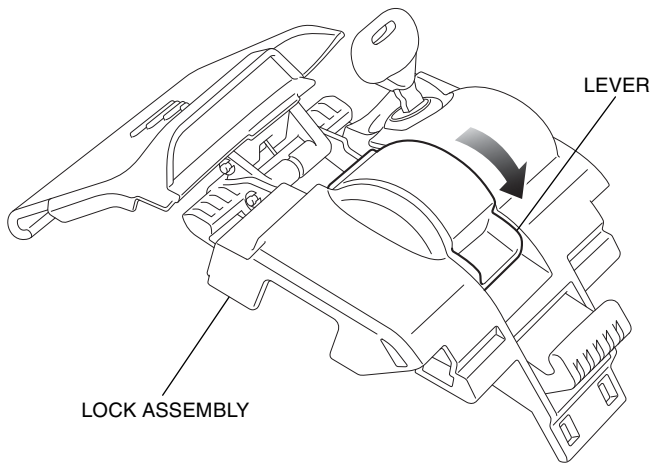

25. Turn the key in the direction shown.

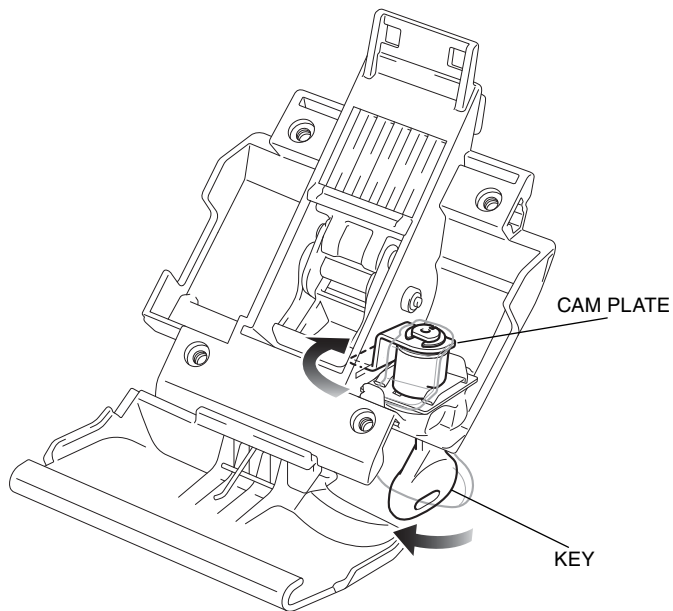

26. Install the end of the lock assembly lightly into the hole in the rear trunk as shown.

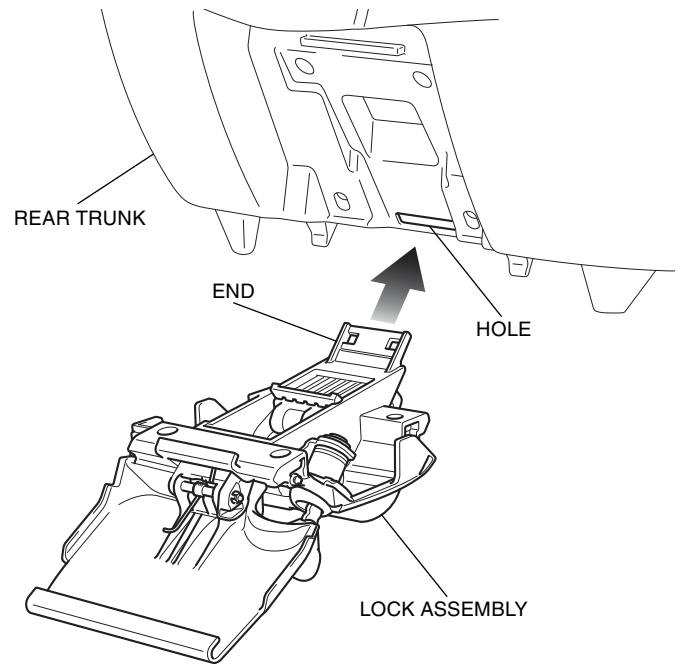

27. Hook the hook of the lock assembly on the rib of the rear trunk, and push the end of the lock assembly in as shown.

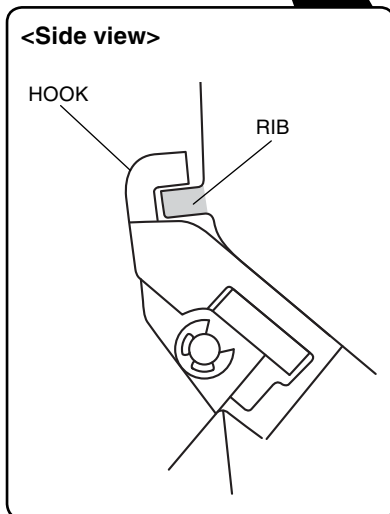
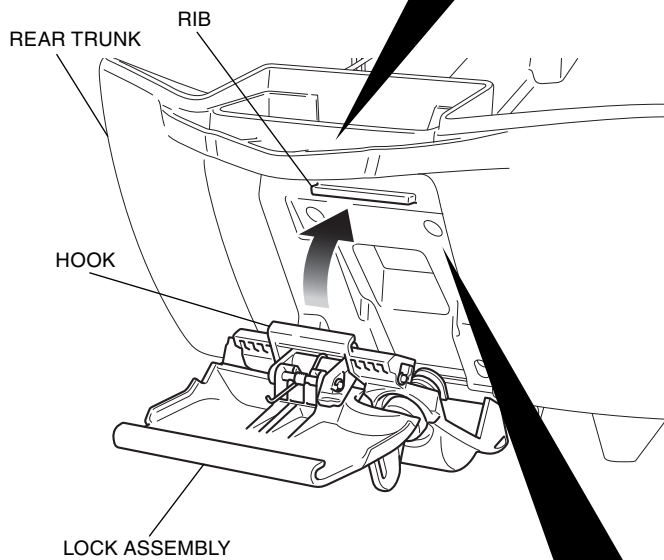
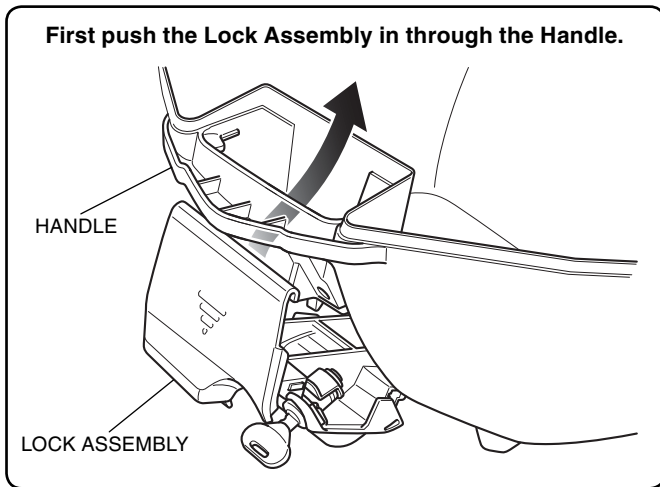

28. Secure the lock assembly with the 6 mm bolts and collars as shown.

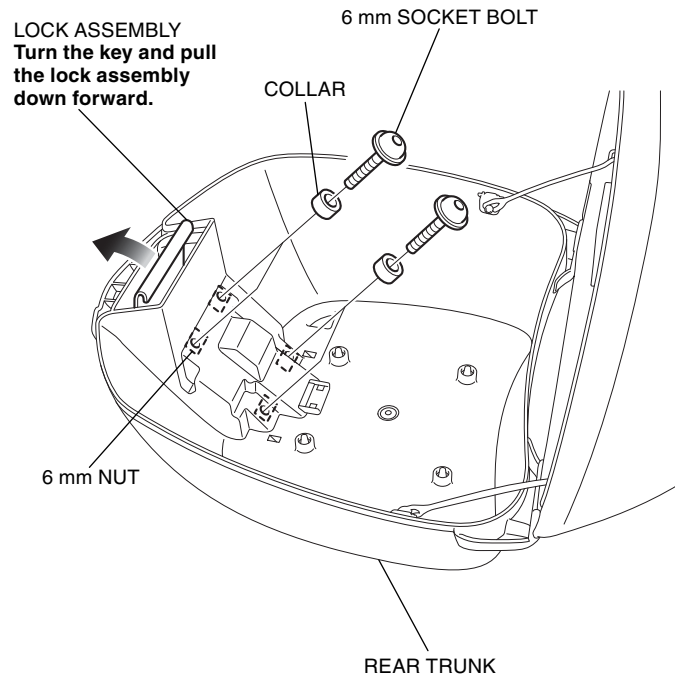

HOW TO OPEN THE REAR TRUNK

1. Operate the lock mechanism as shown.

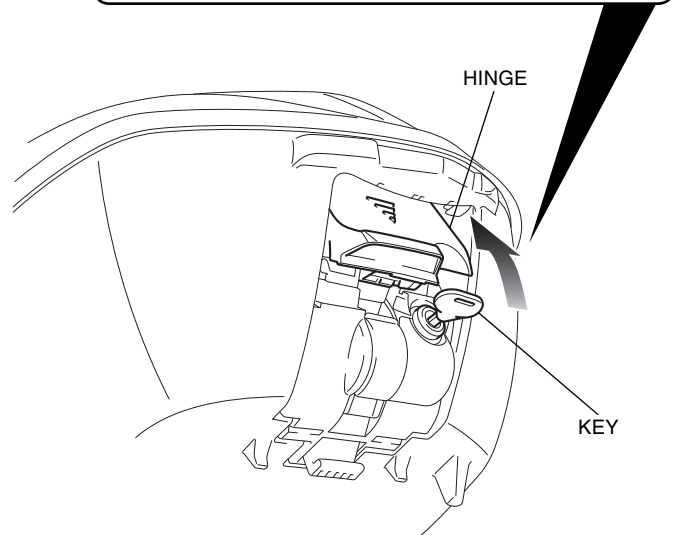
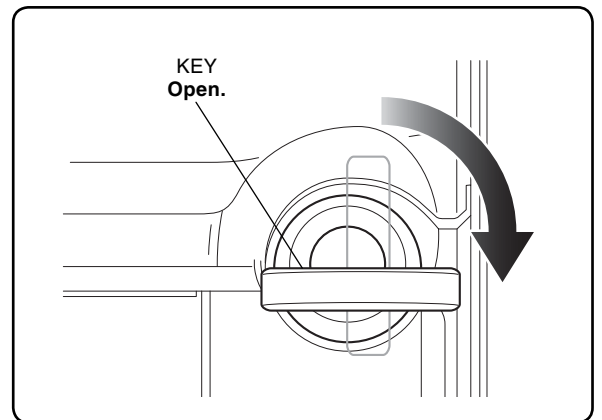

2. Raising the upper part of hinge, push the hinge down as shown and open the lid.

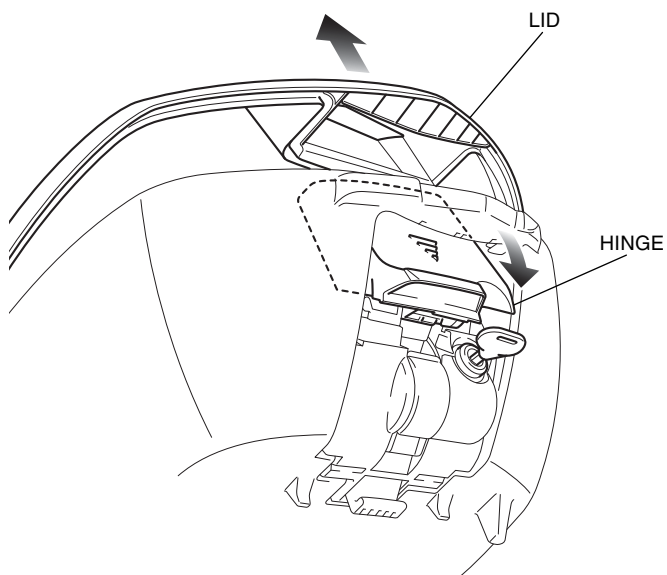

HOW TO CLOSE THE REAR TRUNK

NOTE:

- Be sure that the lid is closed securely before riding.
1. Close the lid, turn the key clockwise and pull the hinge up.

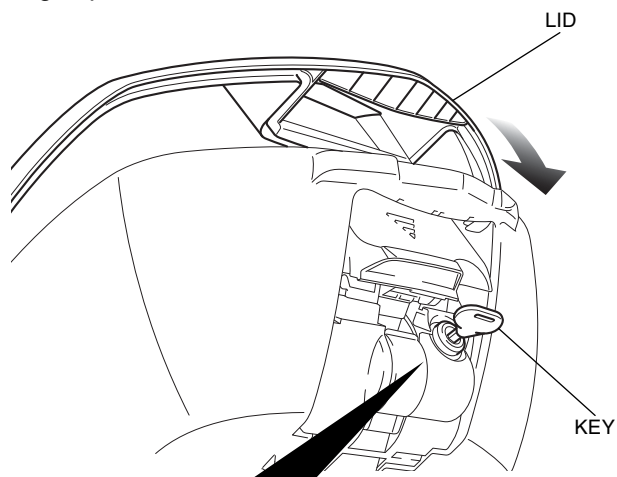

Confirm that the key position is as shown.

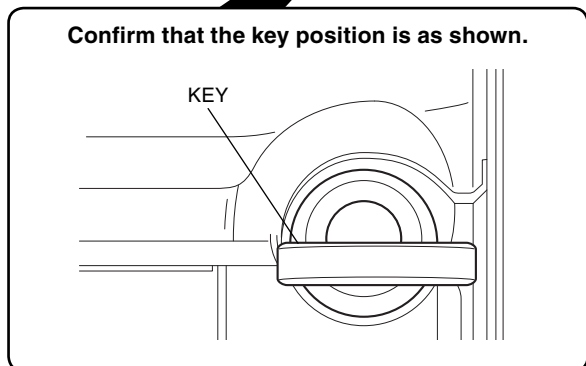

2. Holding the upper part of the hinge, push the hinge down and turn the key counter-clockwise as shown.

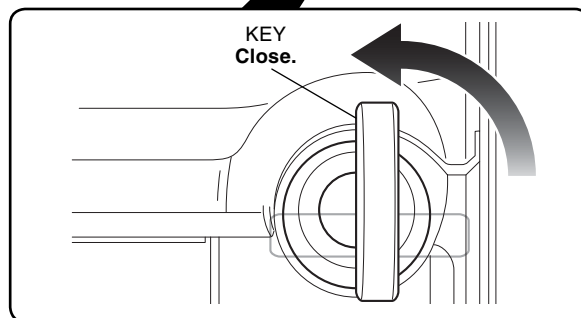
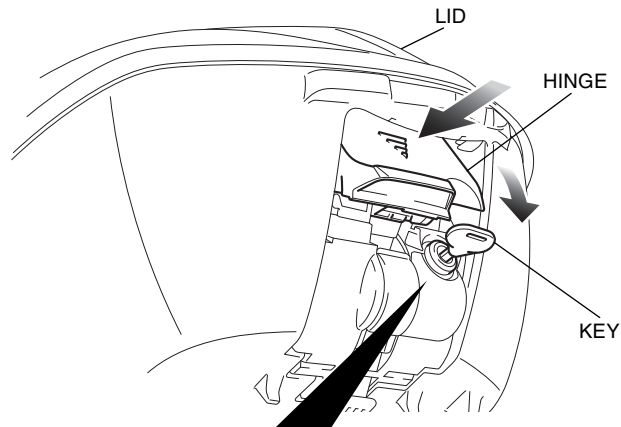

3. Remove the key.
 - **Make sure the lid is locked down securely.**

REAR TRUNK INSTALLATION

NOTE:

- The key must be turned clockwise before installing the trunk.
1. Insert the retaining tabs of the rear trunk into the carrier base with the lever in the raised position as shown.

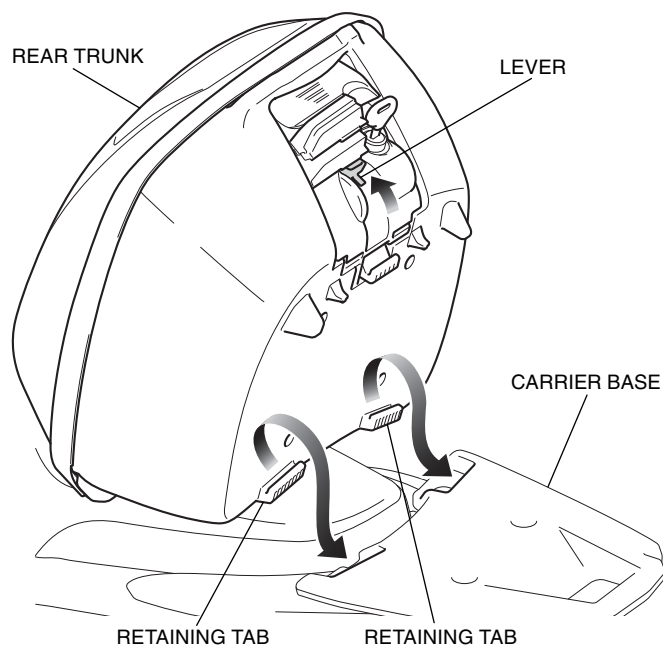

2. Position the hook of the lock assembly on the carrier base as shown.

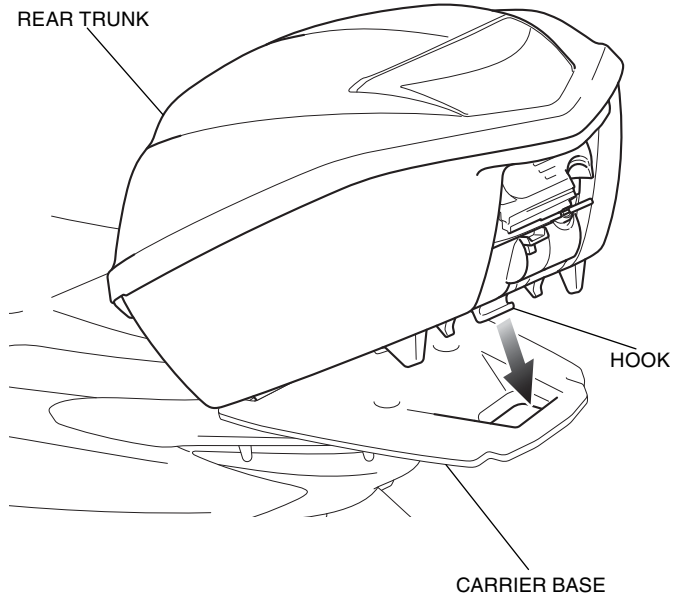

3. Secure the hook by pushing down the lever as shown, and lock with the key.

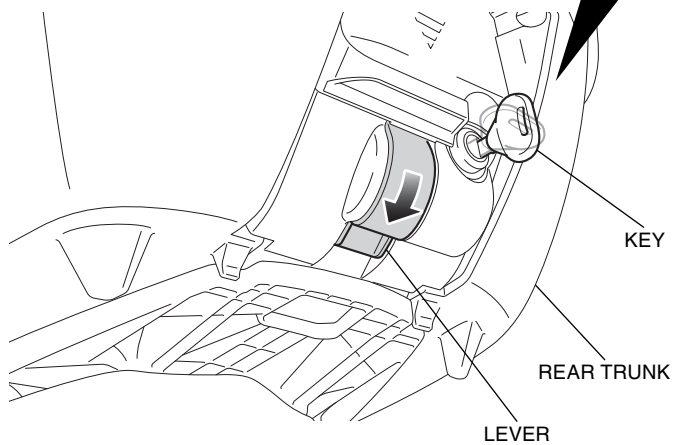
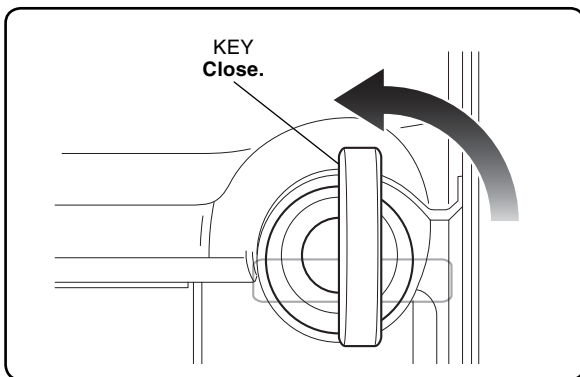

4. Remove the key. Be sure that lid and hook cannot be released and the rear trunk is installed securely.
 - **The rear trunk can come off while riding if it is not mounted securely.**

TRUNK REMOVAL

1. Turn the key in the direction shown and push up the lever.

